

Due Diligence Report

October 2014

VIE: Second Upper Secondary Education Development Project (USEDP II) – Lai Chau Province

Nam Tam Upper Secondary School
Phong Tho Upper Secondary School
Quyêt Thang Upper Secondary School

Prepared by the Ministry of Education and Training, Socialist Republic of Viet Nam, for the Asian Development Bank.

The Due Diligence Report is a document of the borrower. The views expressed herein do not necessarily represent those of ADB's Board of Directors, Management, or staff, and may be preliminary in nature.

In preparing any country program or strategy, financing any project, or by making any designation of or reference to a particular territory or geographic area in this document, the Asian Development Bank does not intend to make any judgments as to the legal or other status of any territory or area.

ACCRONYMS

ADB	-	Asian Development Bank
CPMU	-	Central Project Management Unit
EMs	-	Ethnic Minorities
MOET	-	Ministry of Education and Training
RP	-	Resettlement Plan
USEDP II	-	Second Upper Secondary Education Project
USS	-	Upper Secondary School

I. INTRODUCTION

1. The Ministry of Education and Training (MOET) is implementing the Second Upper Secondary Education Development Project (USEDP II, or the Project) in the 33 provinces of Viet Nam, through Loan № 2929 – VIE (SF) from Asian Development Bank (ADB). Under the Project, a total of 135 upper secondary schools (USSs) and six (6) pedagogical centers have been selected for assistance. In the screening and categorization for social safeguards, Category A subprojects are automatically excluded as Category C shall be prioritized for financing. The subproject USSs with minor impacts (Category B) may be considered subject to the preparation and implementation of a resettlement plan (RP) acceptable to ADB, as prescribed in 2009 Safeguard Policy Statement (SPS). The RP for Category B subproject shall be approved first by the Bank and downloaded at ADB website before implementation by MOET.

2. **Lai Chau** is a sparsely populated province in Viet Nam largely inhabited by ethnic minorities (EMs) in the Northern Midland and Mountain Areas. Three of the four (4) beneficiary USSs¹ were selected for the Project in the province, namely: (i) Nam Tam Upper Secondary School; (ii) Phong Tho Upper Secondary School; and (iii) Quyet Thang Upper Secondary School. They are located in one (1) of the province's six (6) districts and two (2) townships. As screened, they are all Category C subprojects both in Involuntary Resettlement and Indigenous Peoples categorization (**Attachments 1 to 3**), since no social impacts are expected as they shall be constructed inside the schools' premises. The Central Project Management Unit (CPMU) of USEDP II has submitted this Due Diligence Report (DDR) for information of ADB and to secure its "No Objection" for the award of civil works contract for the construction of school facilities.

II. APPROACH AND METHODOLOGY IN DUE DILIGENCE

3. The CPMU has applied the selection criteria in evaluating the USSs included in the long list. The criteria were developed during the PPTA. Given the large number of USSs and their geographic locations, the CPMU sent questionnaires for filling up by the school officials whose responses were the basis for screening and selection in producing the shortlist of USSs. The school officials of shortlisted USSs were then again given two sets of questionnaires. The first set was used in gathering information on their proposed facilities and statistical data that justify their proposal. The proposed investments were then screened and the CPMU made the reasonable distribution of facilities that are urgently needed. The second set was aimed to validate if land acquisition shall be required. The staff and the Social Safeguards Specialists at the CPMU have visited the schools in Lai Chau Province to validate the information provided before this DDR was finalized.

III. THE PROPOSED FACILITIES

4. In all, the three (3) USSs will construct a total of 16 regular classrooms and four (4) function rooms for the holding of classes in biology, physics, chemistry, and laboratory. The construction of regular classrooms will follow the standard dimension as provided for in Decision № 37/2008/QĐ-BGDĐT (July 16, 2008) by MOET. The following dimension of each classroom is as follows: length = 7.8 m and width = 9.9 m. Comprising the width is 7.5 m working area and 2.4 m for the corridor. Each classroom shall have a total area of 56.77 m².

5. The function rooms shall have the following dimensions: length = 11.7 m and width = 9.6 m. The length shall be composed of 7.8 m for working area and 3.9 m for preparation room of teacher. The width is composed of 7.5 m for activity room and 2.1 m for the corridor. Overall, each function room shall have a total area of 83.92 m² in which 56.47 m² for activity room and 27.45 m² for preparation room of the teacher.

¹ Endorsement of Trung Dong Upper Secondary School has been deferred as it will be subject to further validation on its land acquisition.

6. The distribution of the proposed facilities in four (4) schools is shown in Table 1.

Table 1: Proposed USSs Facilities in Lai Chau Province

Name of the School	Classrooms	Function Rooms
Nam Tam Upper Secondary School	6	1
Phong Tho Upper Secondary School	-	2
Quyet Thang Upper Secondary School	10	1
Total	16	4

Source: CPMU of USED P II

IV. BRIEF PROFILE OF THE USSs

A. Nam Tam Upper Secondary School

7. The school was opened in 2009 with only 72 students in Grade 10. It was built in Pa Ha Village on 11,421.4 m² land in Nam Tam Commune in Sin Ho District. The land was granted Land Use Right Certificate with number 117522 with 2,000 m², or 17.5%, are being used for school buildings. The school serves the students in 11 communes. During the school-year 2013-2014, a total of 359 students were enrolled, 253 are males and 106 are females. The student population were composed of 175 from Grade 10, 129 in Grade 11 and 55 in Grade 12, largely from Dan Toc ethnic minority group (98.3%). The Kinh students only shared of 1.7%.

8. The school is still considered relatively new and barely five years in operation. However, student enrolment is increasing by an average of 37.2% that prompted the need for additional classrooms and a function room. It has 35 personnel, nine (9) are non-teaching staff and 26 are teachers, in which 17 are Kinh as nine (9) are EMs. All the teachers are university graduates but none has a master degree.

B. Phong Tho Upper Secondary School

9. Opened in 2003, Phong Tho Upper Secondary School was allocated some 13,698.6 m² of land by the government in Village 41 at the township of Phong Tho in Phong Tho District. The land is covered by Land Use Rights Certificate per Decision № 2236/QĐ-UBND issued on December 10, 2002 by the Provincial Peoples' Committee of Lai Chau. About 2,500 m², or 18.2%, are used for the buildings of the school that serves 18 where a communes. The school had a total population of 323 students in school-year 2013-2014, of which 200 students are males and 123 are females. By grade level, the students were composed of 196 students in Grade 10, 84 in Grade 11 and 43 in Grade 12 who belong to different ethnic groups, such as, Kinh (4.2%) and the EMs (85.8%) from Thai, H'Mong, Dao, Ha Nhi and Giay.

10. Annual enrolment of students in Pho Thong USS is fluctuating as observed in EM areas, the number is higher in Grade 10 but decreases significantly in Grade 11 and Grade 12. The need for classrooms is not an issue but rather of function rooms that are lacking in the school. On the administration, the school has 28 personnel, 20 are teacher and eight (8) are non-teaching staff. Twelve teachers are female while eight (8) are male with 19 are Kinh and only one is an EM, all are graduates of university. One (1) teacher has master degree.

C. Quyet Thang Upper Secondary School

11. The school was granted 16,037.4 m² of land in Sung Cho Village in Nam Loong Commune and opened in August in 2008. It is under the jurisdiction of Lai Chau City and serves 12 communes. The land is covered by Land Use Right Certificate № 00419. Of the total land, 1,600 m² (or roughly 10.0%) are used for school buildings as the rest is open space. During the school-year 2013-2014, some 365 students were enrolled, 248 are males

and 117 are females. Enrolment comprised by 183 students in Grade 10, 109 in Grade 11 and 73 in Grade 12. Ethnicity of the students is largely composed of EMs (78.4%) while the Kinh shared the lowest (21.6%).

12. The school has been operating for six (6) years and during the last five years, enrolment is increasing annually by 5.6% that prompted the school officials to request for additional classrooms and function rooms from MOET.

V. ASSESSMENT OF SOCIAL IMPACTS

13. Adverse social impacts are not expected arising from land acquisition in any of the selected USS in Lai Chau Province. The school premises are enclosed with concrete or wooden fences as protection from encroachers, and neither a house nor structure of private person was allowed by the school administration. Given the total land requirements of the proposed facilities, they were assessed as to their impacts on available lands in the respective school premises.

- **Nam Tam Upper Secondary School.** This school proposes for six (6) classrooms and one (1) function room. Given the area of 56.77 m² for each classroom and 83.92 m² for the function room, this subproject will require a total area of 424.5 m² (340.6 m² for the classrooms and 83.9 m² for the function room). The area is only equivalent to 3.7% of its 11,421.4 m² land. If this is added to the area occupied by existing buildings, this would increase to 21.2%. Therefore, land acquisition beyond the school premises is not required.
- **Phong Tho Upper Secondary School.** The proposed facility for this school is only two (2) function rooms. Using the standard dimension prescribed by MOET (see para. 5), the functions rooms shall require 167.8 m² or 1.2% of the total land of the school. If the space for the area of existing structures is added, they would occupy 19.4% of the total area of the school. Land acquisition is not required.
- **Quyêt Thang Upper Secondary School.** Ten classrooms and one (1) function room are being proposed by this school. These facilities shall require a total of 651.6 m², of which 567.7 m² for the classrooms while 83.9 m² for the function room. The combined areas only represent 4.1% of the 16,037.4 m² land owned by the school, and if added to the land area occupied by existing buildings, their share would only increase to 14.0% of the school's total land. Hence, land acquisition is not required.

14. With the foregoing information on the proposed subprojects in Lai Chau Province, request for "No Objection" for the award of civil works contracts is being sought by MOET from ADB.

Attachment – 1

Involuntary Resettlement Impact Categorization Checklist

Project: **Second Upper Secondary Education Development Project (USEDP II)**

Subproject: **Nam Tam Upper Secondary School**

Province: Lai Chau District: Sin Ho (Nam Tam Commune) CATEGORY: C

Probable Involuntary Resettlement Effects	Yes	No	Not Known	Remarks
Involuntary Acquisition of Land				
1. Will there be land acquisition?		✓		Civil works and rehabilitation shall be undertaken inside the school premises.
2. Is the site for land acquisition known?		✓		Land acquisition will only happen if there is an expansion of school premises. But so far, there is no proposal for expansion.
3. Is the ownership status and current usage of land to be acquired known?				This is not applicable to the project since there is no expansion of school premises.
4. Will easement be utilized within an existing Right of Way (ROW)?		✓		The school has already an entrance and will not be touched by the construction six (6) classrooms and one (1) function room at the school premises.
5. Will there be loss of shelter and residential land use to land acquisition?		✓		Not a house or residential land shall be affected given the wide space of school premises.
6. Will there be loss of agricultural and other productive assets due to land acquisition?		✓		All civil works shall be undertaken in school premises. .
7. Will there be loss of crops, trees, and fixed assets due to land acquisition?		✓		Trees or crops of private persons shall not be affected. While there are some trees in school premises, it is unlikely that they shall be affected by the construction. .
8. Will there be loss of business or enterprises due to land acquisition?		✓		Not a single business will be affected as all civil works and rehabilitation shall be done inside the school premises. .
9. Will there be loss of income sources and means of livelihoods due to land acquisition?		✓		The Project will rather create livelihood or employment in the locality due to construction of school rooms.
Involuntary Restrictions on land use or on access to legally designated parks and protected areas				
10. Will people lose access to natural resources, communal facilities and services?		✓		All civil works and rehabilitation shall be undertaken in school premises. .
11. If land use is changed, will it have an adverse impact on social and economic activities?				No current use of land will be changed and therefore there is no impact on the socio-economic activities of the people.
12. Will access to land and resources owned by the communally or by the state be restricted?		✓		Restriction to land resources of the community or by the state is unlikely.
Information on Displaced Persons				
Any estimate of the likely number of persons that will be displaced by the Project? <input checked="" type="checkbox"/> No <input type="checkbox"/> Yes <input type="checkbox"/> Not applicable				
If yes, approximately how many? .				
Are any of the poor, female-headed households, or vulnerable to poverty risks? <input checked="" type="checkbox"/> No <input type="checkbox"/> Yes <input type="checkbox"/> Not applicable				
Are any displaced persons from indigenous or ethnic minority groups? <input checked="" type="checkbox"/> No <input type="checkbox"/> Yes <input type="checkbox"/> Not applicable				

Indigenous Peoples Impact Screening Checklist

Project: **Second Upper Secondary Education Development Project (USEDP II)**

Subproject: **Nam Tam Upper Secondary School**

Province: Lai Chau District: Sin Ho (Nam Tam Commune) CATEGORY: C

KEY CONCERNS (Please provide elaborations on the Remarks column)	YES	NO	NOT KNOWN	Remarks
A. Indigenous Peoples Identification				
1. Are there socio-cultural group present in or use the project areas who may be considered as “tribes” (hill tribes, schedules tribes, tribal peoples), “minorities” (ethnic or national minorities) or “indigenous communities” in the project area?		✓		The land is allocated solely for the school. If there are ethnic minorities, they are among students of the school pursuing their upper secondary education. .
2. Are there national or local laws or policies as well as anthropological researches/studies that consider these groups present in or using the project area as belonging to “ethnic minorities”, scheduled tribes, tribal peoples, national minorities, or cultural communities?	✓			Some students are children of ethnic minorities in Vietnam who are recognized by the Government. Their rights are embodied in the 2013 Constitution.
3. Do such groups self-identity as taking part of a distinct social and cultural group?	✓			They belong to the 54 different ethnic minorities in the country.
4. Do such groups maintain collective attachments to distinct habitats or ancestral territories and/or to the natural resources in these habitats and territories?		✓		The land being used by the school is exclusively for education purposes where the ethnic minorities has no collective attachments..
5. Do such groups maintain cultural, economic, social, and political institutions distinct from the dominant society and culture?	✓			Such groups maintain cultural, economic, social, and political institutions distinct from the dominant society and culture.
6. Do such groups speak a distinct language or dialect?	✓			Ethnic minority students and ethnic minority teachers speak dialects distinct from the mainstream society.
7. Has such groups been historically, socially and economically marginalized, disempowered, excluded, and/or discriminated against?	✓			Such groups are socially and economically marginalized due to their geographic location.
8. Are such groups represented as “Indigenous Peoples” or as “ethnic minorities” or “scheduled tribes” or “tribal populations” in any formal decision-making bodies at the national or local levels?	✓			Outside of the school, such groups are represented as “ethnic minorities” in formal decision-making bodies at the national or local levels.
B. Identification of Potential Impacts				
9. Will the project directly or indirectly benefit or target Indigenous Peoples?	✓			The students from indigenous communities will directly benefit from the Project in terms of improved quality of education.
10. Will the project directly or indirectly affect Indigenous Peoples’ traditional socio-cultural and belief practices? (e.g. child-rearing, health, education, arts, and governance)?	✓			The project shall only deliver quality education but will not impose changes in sociocultural practices of ethnic minorities.
11. Will the project affect the livelihood systems of Indigenous Peoples? (e.g. food production system, natural resource management, crafts and trade, employment status)		✓		The construction of classrooms will be done in school premises.
12. Are there socio-cultural group present in or use the project areas who may be considered as “tribes” (hill tribes, schedules tribes, tribal peoples), “minorities” (ethnic or national minorities) or “indigenous communities” in the project area?		✓		The sub-project area is inside the school premises.

KEY CONCERNS (Please provide elaborations on the remarks column)	YES	NO	NOT KNOWN	Remarks
C. Identification of Special Requirements				
<i>Will the project activities include:</i>				
13. Commercial development of the cultural resources and knowledge of Indigenous Peoples?		✓		There is no commercial development of cultural resources as the sub-project involves the construction of classrooms...
14. Physical displacements from traditional or customary lands?		✓		Physical displacement from traditional or customary lands will not happen in the sub-project area.
15. Commercial development of natural resources (such as minerals, hydrocarbons, forest, water, hunting or fishing ground) within customary lands under use that would impact the livelihoods or the cultural ceremonial, spiritual uses that define the identity and community of Indigenous Peoples?		✓		The activities in the sub-project area will involve the construction of six (6) classrooms and one (1) function room at the school premises.
16. Establishing legal recognition of rights to lands and territories that are traditionally owned or customarily used, occupied or claimed by indigenous peoples?		✓		The sub-project will only involve the construction of classrooms.
17. Acquisition of lands that are traditionally owned or customarily used, occupied or claimed by indigenous peoples?		✓		There is no acquisition of lands.

D. Anticipated Project Impacts on Indigenous Peoples

Project component/ activity/output	Anticipated positive effects	Anticipated negative effects
1. Construction of six (6) classrooms at the school premises. It will follow the standard dimension as provided for in Decision 37/2008/QD-BGDDT (July 16, 2008). Each classroom shall have the following dimensions: length = 7.8 m and width = 9.9 m. Comprising the width is 7.5 m working area and 2.4 m for the corridor. The classroom shall have a total area of 56.77 m ² .	The provisions of new classrooms will accommodate the increasing number of upper secondary education students. It will also facilitate in providing them quality upper secondary education.	None
2. Construction of one (1) function room in the school premises. Each function room shall have the following dimensions: length = 11.7 m and width = 9.6 m. The length shall be composed of 7.8 m for working area and 3.9 m for preparation room of teacher. The width is composed of 7.5 m for activity room and 2.1 m for the corridor. Overall, each function room shall have a total area of 83.92 m ² in which 56.47 m ² for activity room and 27.45 m ² for preparation room of teacher.	The function rooms shall be instrumental for the students to gain more knowledge in improved lessons in science. The function rooms shall be used in biology, chemistry, physics or laboratory rooms.	None

Layout of Nam Tam USS and the Proposed Location of Facilities

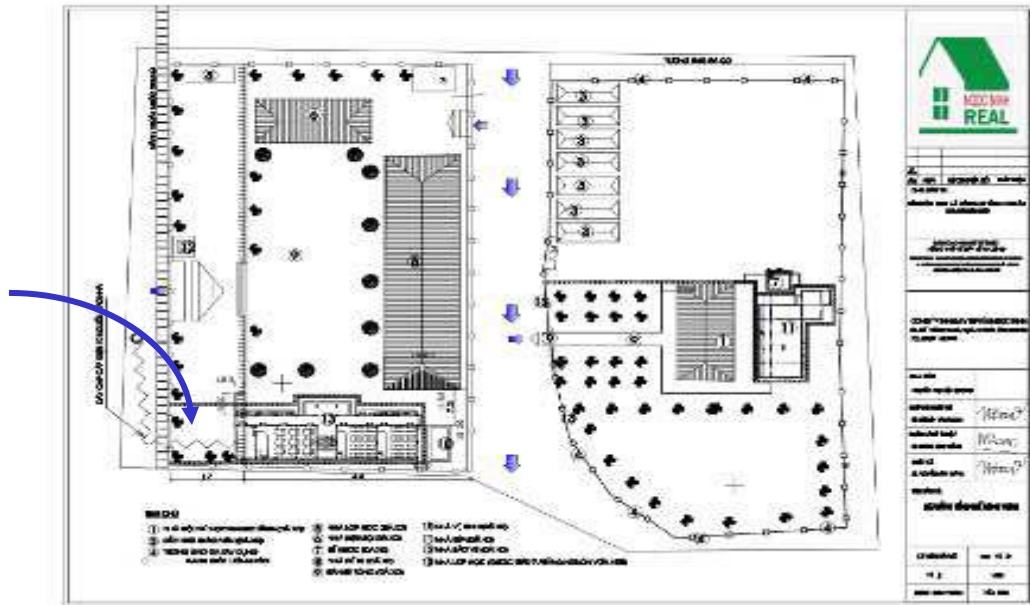

Attachment – 2

Involuntary Resettlement Impact Categorization Checklist

Project: **Second Upper Secondary Education Development Project (USEDP II)**

Subproject: **Phong Tho Upper Secondary School**

Province: Lai Chau District: Phong Tho (Phong Tho Sub-town) CATEGORY: C

Probable Involuntary Resettlement Effects	Yes	No	Not Known	Remarks
Involuntary Acquisition of Land				
1. Will there be land acquisition?		✓		Civil works and rehabilitation shall be undertaken in school premises. .
2. Is the site for land acquisition known?		✓		Land acquisition will only happen if there is an expansion of school premises. But so far, there is no proposal for expansion.
3. Is the ownership status and current usage of land to be acquired known?				This is not applicable to the project since there is no expansion of school premises.
4. Will easement be utilized within an existing Right of Way (ROW)?		✓		The school has already an entrance and will not be touched by the construction of two (2) function rooms at the .school premises.
5. Will there be loss of shelter and residential land use to land acquisition?		✓		Not a house or residential land shall be affected given the wide space of school premises.
6. Will there be loss of agricultural and other productive assets due to land acquisition?		✓		All civil works shall be undertaken in school premises. .
7. Will there be loss of crops, trees, and fixed assets due to land acquisition?		✓		Trees or crops of private persons shall not be affected. While there are some trees in school premises, it is unlikely that they shall be affected by the construction. ..
8. Will there be loss of business or enterprises due to land acquisition?		✓		Not a single business will be affected as all civil works and rehabilitation shall be done inside the school premises. .
9. Will there be loss of income sources and means of livelihoods due to land acquisition?		✓		The Project will rather create livelihood or employment in the locality due to construction of school rooms.
Involuntary Restrictions on land use or on access to legally designated parks and protected areas				
10. Will people lose access to natural resources, communal facilities and services?		✓		All civil works and rehabilitation shall be undertaken in school premises. .
11. If land use is changed, will it have an adverse impact on social and economic activities?				No current use of land will be changed and therefore there is no impact on the socio-economic activities of the people.
12. Will access to land and resources owned by the communally or by the state be restricted?		✓		Restriction to land resources of the community or by the state is unlikely.
Information on Displaced Persons				
Any estimate of the likely number of persons that will be displaced by the Project? <input checked="" type="checkbox"/> No <input type="checkbox"/> Yes <input type="checkbox"/> Not applicable				
If yes, approximately how many? .				
Are any of the poor, female-headed households, or vulnerable to poverty risks? <input checked="" type="checkbox"/> No <input type="checkbox"/> Yes <input type="checkbox"/> Not applicable				
Are any displaced persons from indigenous or ethnic minority groups? <input checked="" type="checkbox"/> No <input type="checkbox"/> Yes <input type="checkbox"/> Not applicable				

Indigenous Peoples Impact Screening Checklist

Project: **Second Upper Secondary Education Development Project (USEDP II)**

Subproject: **Phong Tho Upper Secondary School**

Province: Lai Chau District: Phong Tho (Phong Tho Sub-Town) CATEGORY: C

KEY CONCERNS (Please provide elaborations on the Remarks column)	YES	NO	NOT KNOWN	Remarks
A. Indigenous Peoples Identification				
1. Are there socio-cultural group present in or use the project areas who may be considered as “tribes” (hill tribes, schedules tribes, tribal peoples), “minorities” (ethnic or national minorities) or “indigenous communities” in the project area?		✓		The land is allocated solely for the school. If there are ethnic minorities, they are among students of the school pursuing their upper secondary education. .
2. Are there national or local laws or policies as well as anthropological researches/studies that consider these groups present in or using the project area as belonging to “ethnic minorities”, scheduled tribes, tribal peoples, national minorities, or cultural communities?	✓			Some students are children of ethnic minorities in Vietnam who are recognized by the Government. Their rights are embodied in the 2013 Constitution.
3. Do such groups self-identity as taking part of a distinct social and cultural group?	✓			They belong to the 54 different ethnic minorities in the country.
4. Do such groups maintain collective attachments to distinct habitats or ancestral territories and/or to the natural resources in these habitats and territories?		✓		The land being used by the school is exclusively for education purposes where the ethnic minorities has no collective attachments..
5. Do such groups maintain cultural, economic, social, and political institutions distinct from the dominant society and culture?	✓			Such groups maintain cultural, economic, social, and political institutions distinct from the dominant society and culture.
6. Do such groups speak a distinct language or dialect?	✓			Ethnic minority students and ethnic minority teachers speak dialects distinct from the mainstream society.
7. Has such groups been historically, socially and economically marginalized, disempowered, excluded, and/or discriminated against?	✓			Such groups are socially and economically marginalized due to their geographic location.
8. Are such groups represented as “Indigenous Peoples” or as “ethnic minorities” or “scheduled tribes” or “tribal populations” in any formal decision-making bodies at the national or local levels?	✓			Outside of the school, such groups are represented as “ethnic minorities” in formal decision-making bodies at the national or local levels.
B. Identification of Potential Impacts				
9. Will the project directly or indirectly benefit or target Indigenous Peoples?	✓			The students from indigenous communities will directly benefit from the Project in terms of improved quality of education.
10. Will the project directly or indirectly affect Indigenous Peoples’ traditional socio-cultural and belief practices? (e.g. child-rearing, health, education, arts, and governance)?	✓			The project shall only deliver quality education but will not impose changes in sociocultural practices of ethnic minorities.
11. Will the project affect the livelihood systems of Indigenous Peoples? (e.g. food production system, natural resource management, crafts and trade, employment status)		✓		The construction of classrooms will be done in school premises.
12. Are there socio-cultural group present in or use the project areas who may be considered as “tribes” (hill tribes, schedules tribes, tribal peoples), “minorities” (ethnic or national minorities) or “indigenous communities” in the project area?		✓		The sub-project area is inside the school premises.

KEY CONCERNS (Please provide elaborations on the remarks column)	YES	NO	NOT KNOWN	Remarks
C. Identification of Special Requirements <i>Will the project activities include:</i>				
13. Commercial development of the cultural resources and knowledge of Indigenous Peoples?		✓		There is no commercial development of cultural resources as the sub-project involves the construction of classrooms...
14. Physical displacements from traditional or customary lands?		✓		Physical displacement from traditional or customary lands will not happen in the sub-project area.
15. Commercial development of natural resources (such as minerals, hydrocarbons, forest, water, hunting or fishing ground) within customary lands under use that would impact the livelihoods or the cultural ceremonial, spiritual uses that define the identity and community of Indigenous Peoples?		✓		The activities in the sub-project area will involve the construction of two (2) function rooms at the school premises.
16. Establishing legal recognition of rights to lands and territories that are traditionally owned or customarily used, occupied or claimed by indigenous peoples?		✓		The sub-project will only involve the construction of classrooms.
17. Acquisition of lands that are traditionally owned or customarily used, occupied or claimed by indigenous peoples?		✓		There is no acquisition of lands.

D. Anticipated Project Impacts on Indigenous Peoples

Project component/ activity/output	Anticipated positive effects	Anticipated negative effects
1. Construction of two (2) function rooms in the school premises. Each function room shall have the following dimensions: length = 11.7 m and width = 9.6 m. The length shall be composed of 7.8 m for working area and 3.9 m for preparation room of teacher. The width is composed of 7.5 m for activity room and 2.1 m for the corridor. Overall, each function room shall have a total area of 83.92 m ² in which 56.47 m ² for activity room and 27.45 m ² for preparation room of teacher.	The function rooms shall be instrumental for students to gain more knowledge in improved lessons in science. The function rooms shall be used in biology, chemistry, physics or laboratory rooms.	None

Layout of Phong Tho USS and the Proposed Location of Facility

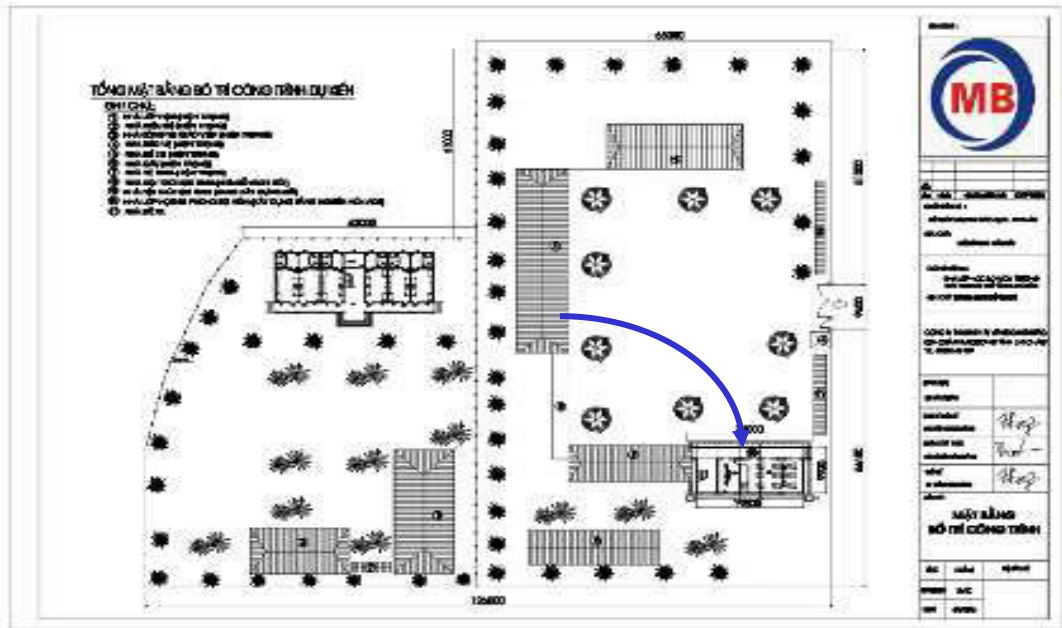

Attachment – 3

Involuntary Resettlement Impact Categorization Checklist

Project: **Second Upper Secondary Education Development Project (USEDP II)**

Subproject: **Quyêt Thang Upper Secondary School**

Province: Lai Chau District: Lai Chau (Nam Loong Commune) CATEGORY: C

Probable Involuntary Resettlement Effects	Yes	No	Not Known	Remarks
Involuntary Acquisition of Land				
1. Will there be land acquisition?		✓		Civil works and rehabilitation shall be undertaken in school premises. .
2. Is the site for land acquisition known?		✓		Land acquisition will only happen if there is an expansion of school premises. But so far, there is no proposal for expansion.
3. Is the ownership status and current usage of land to be acquired known?				This is not applicable to the project since there is no expansion of school premises.
4. Will easement be utilized within an existing Right of Way (ROW)?		✓		The school has already an entrance and will not be touched by the construction 10 classrooms and one (1) function room at the .school premises.
5. Will there be loss of shelter and residential land use to land acquisition?		✓		Not a house or residential land shall be affected given the wide space of school premises.
6. Will there be loss of agricultural and other productive assets due to land acquisition?		✓		All civil works shall be undertaken in school premises. .
7. Will there be loss of crops, trees, and fixed assets due to land acquisition?		✓		Trees or crops of private persons shall not be affected. While there are some trees in school premises, it is unlikely that they shall be affected by the construction. ..
8. Will there be loss of business or enterprises due to land acquisition?		✓		Not a single business will be affected as all civil works and rehabilitation shall be done inside the school premises. .
9. Will there be loss of income sources and means of livelihoods due to land acquisition?		✓		The Project will rather create livelihood or employment in the locality due to construction of school rooms.
Involuntary Restrictions on land use or on access to legally designated parks and protected areas				
10. Will people lose access to natural resources, communal facilities and services?		✓		All civil works and rehabilitation shall be undertaken in school premises. .
11. If land use is changed, will it have an adverse impact on social and economic activities?				No current use of land will be changed and therefore there is no impact on the socio-economic activities of the people.
12. Will access to land and resources owned by the communally or by the state be restricted?		✓		Restriction to land resources of the community or by the state is unlikely.
Information on Displaced Persons				
Any estimate of the likely number of persons that will be displaced by the Project? <input checked="" type="checkbox"/> No <input type="checkbox"/> Yes <input type="checkbox"/> Not applicable If yes, approximately how many? .				
Are any of the poor, female-headed households, or vulnerable to poverty risks? <input checked="" type="checkbox"/> No <input type="checkbox"/> Yes <input type="checkbox"/> Not applicable				
Are any displaced persons from indigenous or ethnic minority groups? <input checked="" type="checkbox"/> No <input type="checkbox"/> Yes <input type="checkbox"/> Not applicable				

Indigenous Peoples Impact Screening Checklist

Project: **Second Upper Secondary Education Development Project (USEDP II)**

Subproject: **Quyêt Thang Upper Secondary School**

Province: Lai Chau District: Lai Chau Town (Nam Loong Commune) CATEGORY: C

KEY CONCERNS (Please provide elaborations on the Remarks column)	YES	NO	NOT KNOWN	Remarks
A. Indigenous Peoples Identification				
1. Are there socio-cultural group present in or use the project areas who may be considered as “tribes” (hill tribes, schedules tribes, tribal peoples), “minorities” (ethnic or national minorities) or “indigenous communities” in the project area?		✓		The land is allocated solely for the school. If there are ethnic minorities, they are among students of the school pursuing their upper secondary education. .
2. Are there national or local laws or policies as well as anthropological researches/studies that consider these groups present in or using the project area as belonging to “ethnic minorities”, scheduled tribes, tribal peoples, national minorities, or cultural communities?	✓			Some students are children of ethnic minorities in Vietnam who are recognized by the Government. Their rights are embodied in the 2013 Constitution.
3. Do such groups self-identity as taking part of a distinct social and cultural group?	✓			They belong to the 54 different ethnic minorities in the country.
4. Do such groups maintain collective attachments to distinct habitats or ancestral territories and/or to the natural resources in these habitats and territories?		✓		The land being used by the school is exclusively for education purposes where the ethnic minorities has no collective attachments..
5. Do such groups maintain cultural, economic, social, and political institutions distinct from the dominant society and culture?	✓			Such groups maintain cultural, economic, social, and political institutions distinct from the dominant society and culture.
6. Do such groups speak a distinct language or dialect?	✓			Ethnic minority students and ethnic minority teachers speak dialects distinct from the mainstream society.
7. Has such groups been historically, socially and economically marginalized, disempowered, excluded, and/or discriminated against?	✓			Such groups are socially and economically marginalized due to their geographic location.
8. Are such groups represented as “Indigenous Peoples” or as “ethnic minorities” or “scheduled tribes” or “tribal populations” in any formal decision-making bodies at the national or local levels?	✓			Outside of the school, such groups are represented as “ethnic minorities” in formal decision-making bodies at the national or local levels.
B. Identification of Potential Impacts				
9. Will the project directly or indirectly benefit or target Indigenous Peoples?	✓			The students from indigenous communities will directly benefit from the Project in terms of improved quality of education.
10. Will the project directly or indirectly affect Indigenous Peoples’ traditional socio-cultural and belief practices? (e.g. child-rearing, health, education, arts, and governance)?	✓			The project shall only deliver quality education but will not impose changes in sociocultural practices of ethnic minorities.
11. Will the project affect the livelihood systems of Indigenous Peoples? (e.g. food production system, natural resource management, crafts and trade, employment status)		✓		The construction of classrooms will be done in school premises.
12. Are there socio-cultural group present in or use the project areas who may be considered as “tribes” (hill tribes, schedules tribes, tribal peoples), “minorities” (ethnic or national minorities) or “indigenous communities” in the project area?		✓		The sub-project area is inside the school premises.

KEY CONCERNS (Please provide elaborations on the remarks column)	YES	NO	NOT KNOWN	Remarks
C. Identification of Special Requirements <i>Will the project activities include:</i>				
13. Commercial development of the cultural resources and knowledge of Indigenous Peoples?		✓		There is no commercial development of cultural resources as the sub-project involves the construction of classrooms...
14. Physical displacements from traditional or customary lands?		✓		Physical displacement from traditional or customary lands will not happen in the sub-project area.
15. Commercial development of natural resources (such as minerals, hydrocarbons, forest, water, hunting or fishing ground) within customary lands under use that would impact the livelihoods or the cultural ceremonial, spiritual uses that define the identity and community of Indigenous Peoples?		✓		The activities in the sub-project area will involve the construction of 10 classrooms and one (1) function room at the school premises.
16. Establishing legal recognition of rights to lands and territories that are traditionally owned or customarily used, occupied or claimed by indigenous peoples?		✓		The sub-project will only involve the construction of classrooms.
17. Acquisition of lands that are traditionally owned or customarily used, occupied or claimed by indigenous peoples?		✓		There is no acquisition of lands.

D. Anticipated Project Impacts on Indigenous Peoples

Project component/ activity/output	Anticipated positive effects	Anticipated negative effects
1. Construction of 10 classrooms at the school premises. It will follow the standard dimension as provided for in Decision 37/2008/QD-BGDDT (July 16, 2008). Each classroom shall have the following dimensions: length = 7.8 m and width = 9.9 m. Comprising the width is 7.5 m working area and 2.4 m for the corridor. The classroom shall have a total area of 56.77 m ² ..	The provisions of new classrooms will accommodate the increasing number of upper secondary education students. It will also facilitate in providing them quality upper secondary education.	None
2. Construction of one (1) function room in the school premises. Each function room shall have the following dimensions: length = 11.7 m and width = 9.6 m. The length shall be composed of 7.8 m for working area and 3.9 m for preparation room of teacher. The width is composed of 7.5 m for activity room and 2.1 m for the corridor. Overall, each function room shall have a total area of 83.92 m ² in which 56.47 m ² for activity room and 27.45 m ² for preparation room of teacher.	The function rooms shall be instrumental for students to gain more knowledge in improved lessons in science. The function rooms shall be used in physics or laboratory rooms.	None

Layout of Quyet Thang USS and the Proposed Location of Facilities

