



Environmental Monitoring Report

Project Number: 37143-033
January 2018

Period: January 2016 – June 2016

IND: North Eastern States Roads Investment Program (Project 2)

Subproject: Udaipur-Melaghar road Tranche-2

Submitted by
Public Works Department, Government of Tripura

This report has been submitted to ADB by the Public Works Department, Government of Tripura and is made publicly available in accordance with ADB's Public Communications Policy (2011). It does not necessarily reflect the views of ADB.

This environmental monitoring report is a document of the borrower. The views expressed herein do not necessarily represent those of ADB's Board of Directors, Management, or staff, and may be preliminary in nature. In preparing any country program or strategy, financing any project, or by making any designation of or reference to a particular territory or geographic area in this document, the Asian Development Bank does not intend to make any judgments as to the legal or other status of any territory or area.

Asian Development Bank

Government of Tripura.
Office of the Superintending Engineer,
3rd Circle, PWD, Udaipur, Gomati District.
E-mail:-sc3rdpwd@gmail.com.
Tel:03821-222378. Fax No.03821223533.

THROUGH 32
Regd. with.

GM/JK.

No. F. Circle-III / 3(1240) / 2577-82

Dated, Udaipur, ¹⁶ / 09 / 2017

To
The Director (ADB-NESRIP),
Room No. 255,
First Floor, Ministry of Development of North Eastern Region,
Vigyan Bhawan Annexe,
Maulana Azad Road,
New Delhi- 110011.



Sub:- Submission of Environmental Monitoring Report(EMP).

Name of Project:- Improvement and Up-gradation of Road Section of Udaipur to Melaghar (TR02) (Tranche-2
Road in the State of Tripura) under North Eastern State Roads Investment Program.

Loan No:- 3073:North Eastern State Roads Investment Program.(Project-2).

Ref:- CSC's letter No. 1(b)/TL/PIU/0342 dt. 24.08.2017

Sir,

With reference to the above, I am re-submitting herewith the Environmental Monitoring Report(EMP)
for the period of June 2015 to Dec'2015, Jan 2016 to June 2016, July 2016 to Dec'2016 & Jan 2017 to June 2017
in pdf format for the above mentioned project for further course of action from your end.

Encl:- Environmental Monitoring Report(EMP)
for the period of

- i) June 2015 to Dec'2015,
- ii) Jan 2016 to June 2016,
- iii) July 2016 to Dec'2016 &
- iv) Jan 2017 to June 2017.

Yours faithfully,

(Er. Ajit Ch. Lodhi)
Project Director(ADB Project)
& Superintending Engineer,
3rd Circle, PWD(R&B), Udaipur
Gomati District.

Copy to :

1. The Chief Engineer, PWD(NH) & Nodal Officer(ADB Project), Gurkhabasti, Agartala, Tripura for
kind information.
2. The Project Assistant, Project Management Unit, NESRIP, MDONER for information please.

Soft copy recd 3.01.17

Copy also to:-

1. Mr. Anil Motwani, Team Leader, Transport, India Resident Mission for information please.
2. Mr. Arun Mahajan, Project Management Specialist, Transport, ADB INRM, 4 San Martin Marg,
Chanyakapuri, New Delhi- 110021 for information please.
3. Mr. Jagir Kumar, Sr. Project officer, Transport, ADB INRM, 4 San Martin Marg, Chanyakapuri, New Delhi-
110021 for information please. Encl. As stated. (CN)

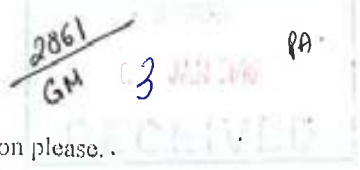

**Government of Tripura
Public Works Department**

**Consulting Services for Construction Supervision of Improvement and Up-gradation
of Road Section of Udaipur to Melaghar (TR02) (Tranche-2 road in the State of
Tripura) under North Eastern State Roads Investment Program
ADB Project No. 37143-02 MFF.**

Environmental monitoring report



January 2016 to June - 2016

RECEIVED

No. *[Signature]*

Date *24/8/16*

O/o. the 3rd Circle (PWD)
Gomati District, Tripura.

 **egis International**
Formerly Egis Bolom International

 **egis India**
Consulting engineers pvt. Ltd.

TABLE OF CONTENTS

1.0.	Introduction	01
1.1.	Project description	01-03
1.2.	Project objectives	03
1.3.	Environmental category	03-04
1.4.	Scope of Report	04
2.0.	Overall project progress	05
3.0.	Compliance status with national /state /local statutory environmental requirement	06-08
4.0.	Compliance status with respect to the environmental covenants as stipulated in the loan agreement	08-11
5.0.	Compliance status with environmental management and monitoring plans as stipulated in the environmental documentation as agreed with ADB	12
6.0.	Approach and methodology engaged for environmental monitoring of the project	12-13
7.0.	Monitoring of Environmental receptors/attributes	13-14
8.0.	Any other environmental aspects, impacts observed during implementation which were not covered earlier	14-
9.0.	Details of complaints received from public and action taken thereof to resolve	14-15
10.0.	Follow-up actions and conclusion	15-17

LIST OF TABLES

TABLE NO.	ITEMS	PAGE
1.0	Project Road Under Implementation- TR -02	02
1.1	Details of Contractors under each Road Packages	02
2.1	Tree Details up to ch. No 0+00 to 15+00	05
2.2	The following borrow area have been identified under each construction package:	05
2.3	Status of Physical progress as on 30 th June 2016	05
3	Statutory Requirement & their Current Status / Approval of Compliance in Contract Tr-02 (January 2016 to June 2016)	06
4	Status of compliance with safeguards loan covenants	08

ANNEXURES.

S.NO	ITEMS	
1	Labour License	
II	Workmen compensation Insurance	
III	Consent-for/ NOC - Establishing s hot mix plant, WMM	
IV	Application for Batching plant	
V	Mining Department for opening and operation of Quarries/ blasting – Chalan copy	
	.	
	Photo logs	
VI	Photographs	

ABBREVIATIONS

ADB	Asian Development Bank
NESRIP	North Eastern State Roads Investment Programme
GoCG	Government of Tripura
PWD	Public Work Department
ROW	Right of Way
FE	Field Engineer
IEE	Initial Environmental Examination
EMP	Environmental Management plan
EA	Executive Agency
RP	Resettlement Plans
GRM	Grievances Redress Mechanism
GRC	Grievances Redress Committee
MoEF	Ministry of Environmental and Forest
IPP	
IPPF	
PIUs	Project implementation unit
RF	
CPCB	Central Pollution Control Board
CSC	Construction Supervision Consultant

1.0 INTRODUCTION

1.1 Project Background

The North Eastern State Roads Investment Programme (NESRIP) is a joint initiative of the Government of India and the Asian Development Bank.

The Asian Development Bank (ADB) had approved for financial support to Government of India towards the cost of proposed North Eastern State Roads Investment Program (NESRIP) to (i) improve about 430 kms of priority road sections under Tranche-1 and Tranche-2 in six states in North Eastern Region (NER) of India and (ii) provide capacity building support to the executing agency of NESRIP ; the Ministry of Development of North Eastern Region (MDoNER); and implementing agencies (IAs). the State Public Works Department (PWD) or its equivalent in each state. A total length of 433.7 kms of roads and bridges covering six NE States, excluding Arunachal Pradesh and Nagaland is proposed to be taken up for construction / upgradation during Tranche I & II. Tranche I comprising the States of Assam, Meghalaya and Sikkim will cover a total road length of 202.3 kms and Tranche – II comprising Assam, Manipur, Mizoram and Tripura will cover the remaining road length of 231.4 kms.

Under Tranche -II of NESRIP, the road section of 20.23 km between Udaipur and Melaghar, in Tripura has been identified for rehabilitation and up-gradation, under civil works package TR-CW1.

The Project road, Udaipur (on NH-44) to Melaghar (TR-02), in the state of Tripura, is a Major District Road (MDR). The entire Project road section provides connectivity to melaghar near Bangladesh border. Melaghar is also connected directly by another road to NH-44 providing shorter link to Agartala. The road is important for International border trade between India and Bangladesh.

1.2 Project Description

This Report of Environmental Management plan Implementation is concerned with the sub-project road i.e. SH. The details of concerned sub-project are presented in **Table-1**, the Environmental Management plan (EMP) of which is being implemented as a part of project component:

The project road is currently a single / intermediate lane and falls under two Districts in the state of Tripura viz. Gomati and Shipahijala. The entire Project road section lies in East Tripura District. The length of the road as per TOR is 20.3 km. The project section takes off from NH-44 at Udaipur (Gomati district) and travels in West direction to meet Bishramganj-Sonamura State Highway at Melaghar in Shipahijala. The project road is a Major District Road connecting Udaipur and Melaghar via Kakraban, which is apparently the mid-point of the project corridor. The start point of the project corridor at Udaipur is 55.200 km from the State capital, Agartala with starting chainage 0.00 km.

The built-up area is generally concentrated along the road.

Land use along the project road is mainly agricultural and built up areas scattered along. In rolling terrain the forest area has scanty plantation, except shrubs. The river Gomati crosses the Project road at km 13. For considerable Length the Project road aligned along the river bank, sometimes close to the river. The project influence area lies approximately in Seismic Zone V.

The project road ends at Melaghar at the junction with another MDR joining Melaghar to NH and leading to Agartala

Table-1.0: Project Road under Implementation- TR -02

Road Code	Name of the Sub-project Road	Length (in Km.)	District Covered
TR 02	Udaipur - Melaghar	20.23	Gomati and Shipaijala

Source: MPR of concerned project road,

The project will rehabilitate the deteriorated and damaged state road corridors to provide reliable road transport services and, hence, reduce poverty in the long term. As far as possible the project aimed at up-gradation and rehabilitation of existing state highways with limited amount of land acquisition following the existing alignment. The purpose of adopting up-gradation and rehabilitation within ROW and following the existing alignment was nothing but to reduce the social impact in its immediate environment to the maximum extent possible.

The condition of the existing road was poor as at many places the pavement was no more exists. There were villages in regular interval with many squatters and encroachers living or doing business along the road.

The section of State Highways is located in Gomoti and Shipaijala districts. It starts from NH-44 Udaipur town and terminates at MDR in Melaghar. It passes through Ramesh Chwmoni, Khilpara, Jamjuri, Palatana, Kakraban, Kishoreganj, Kamrangatoli, Mohanbhog and Melaghar in the districts of Gomoti and Shipaijala (Tripura). The start point of Project road is at Ramesh Chwmoni (Km. 0.000) and end point is at Melaghar (Km. 20.23). The total length of the road is 20.23 Km.

Table 1.1: Details of Contractors under each Road Packages

Sl. No.	Road code	Name of Road	Length (km)	Contractors
1.	TR 02	Udaipur - Melaghar	20.23	M/s ECI- Nayak (JV) Plot No. - 70 , Anshu Colors , 3 rd Floor , Road No.1 , Jubilee Hills , Hyderabad -500033

Location Map-1

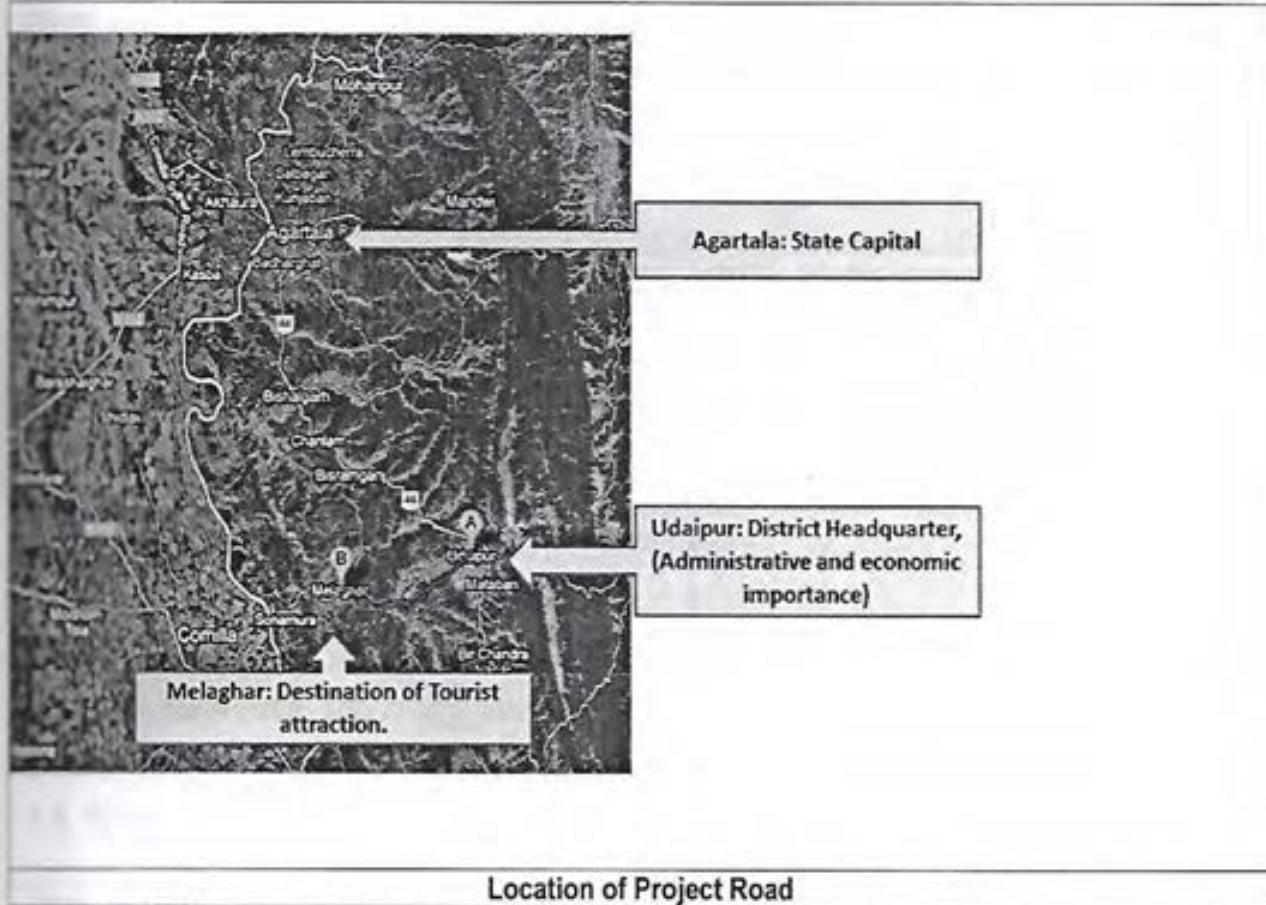

Project Objectives

- Upgradation/improvement of 20.23 km of state highway Road
- Improving the conditions of the existing road network by carrying out rehabilitation and reconstruction works that are mostly confined within the existing right-of-way (ROW).
- Strengthening /reconstruction of the existing carriageway, bringing the roads to standard width, improvement of the safety features and making provisions of adequate signage.

1.3 Environmental Category

TR-02 roads existing and no realignments are proposed. All impacts are site specific, few are irreversible and related to minor alignment correction and road widening, and all impacts can be readily mitigated. Therefore all the contract packages fall under B Category as per ADB categorization criteria based on ADB's Environmental Assessment Guidelines 2003, and Safeguard Policy Statement (SPS) 2009. The project required only IEE for meeting the environmental requirements under the ADB's policy. Environmental Management Plan (EMP) was formulated for mitigating and managing the anticipated adverse environmental impacts and enhancing the efficiency of environmental components wherever it is possible. The recommended EMP was included in domain of detailed and bid document for all the packages. There is a separate budgetary allocation for implementation of EMP and have been included in the contracts.

1.4 Scope of Report

The present report is the first Environmental Monitoring Report covering the period from January 2016 to June 2016. The report reviews the compliances of environmental activities set in EMP during the period and processes practices/innovations leading to improved and sustainable environment in the future.

1.5 Scope of environmental work

Carry out the following duties related to environmental management: (a) ensure that the construction methods as proposed by the Contractor for carrying out the works are satisfactory, with particular reference to the technical requirements of Acts, Rules, Guidelines and Standards, as also the stipulation of competent Environmental Authority that are applicable to the Project, (b) supervise and monitor the implementation of environmental mitigation measures stipulated in the Environmental Management Plan (EMP) (in Annexed - 1) prepared as part of the Initial Environmental Examination Report (IEE), (c) timely detect any unexpected environmental impacts and coordinate with the Employer to implement necessary mitigation measures; (d) undertake the environmental monitoring works; (e) supervise other related environmental work decided by the Employer, and (f) prepare monitoring reports on the implementation of the EMP. The IEE will be provided by the Employer to the Consultant during the proposal preparation period

2.0 Overall project progress

PROJECT PROGRESS STATUS AND IMPLEMENTATION SCHEDULE

A comparison of the progress at end of June 2016 is summarized as below.

A. Progress Status of Construction Activities

The construction activities are erection and commissioning of plant (Batching plants) under progress. Utilities shifting and tree cutting is also in progress.

a) Construction Camps

The following Construction camps are being established

TR-02 - Established at ch.10+800 Km RHS ,Kakravan ,Village, Goumati District

b) Tree Cutting Status

The cuttings of trees up to 15 km are being carried out based on the approval of competent authority. It is carried out with all safety requirements. The details of tree cut in each package as on 30th June, 2016 is as follows:

Table No- 2.1 Tree details up to Ch. No 0+00 to 15+00

Road Code	No. of Trees to be Cut	No. of Trees Cut As on 30 th June 2016	Balance to be cut
TR-02	1135	1126	9

c) Borrow Areas

Table No. 2..2 The following borrow area have been identified under each construction package:Tr-02

Sl .No.	Borrow Area No.	Chainage	LHS/RHS	Ownership (Private/Govt. /Panchayat/ Community)	Qty. (Cum)
Road Code -TR-02					
1	1	Ch-11+400	LHS	Private , village Mirza	18531
2	2	Ch-4+450	LHS	Private , Village ,Chandrapur	25271
3	3				

Note - please refer already submitted previous report in Annexed -II

d). Table No. 2.3 Status of Physical progress as on 30th June 2016

Pkg. No.	Name of Contractor	Road Code	Length (km)	Date of Start	Scheduled Date of Completion	Physical progress (%)
C5	M/s ECI- Nayak (JV)	TR-02	20.23	6 th -Apr-2015	06-sep-2016	13.88 %

Source- MPR June 2016

3. Compliance Status with National/State/Local Statutory Environmental Requirements:

As stated in the loan document, prior to commencing civil work all the required statutory clearances need to be obtained. With regard to the Trench-II, there is no road project requiring Environmental Clearance from MoEF. Statutory clearances for Trench - II are related to removal of trees that is obtained from the State Forest Department and clearances for construction activities obtained from the State Pollution Control Board (SPCB).

Table 3.0 : Statutory Requirement & their Current Status / Approval of Compliance in Contract Tr-02 (January 2016 to June 2016)

Statutory Requirements	Road Code – TR-02	Details Explanation on the current status	Further Action Needed for Compliances and responsibility
Forest Clearance for Diversion of Forest Land	NA		
Tree Cutting and its Transit Permission (Approval for Tree Cutting)	Letter copy	Have to be submitted	
Labour License	Not applied for application	The Contractor has been submitted m validity -16-05-2016 to 15-05-2016	annexed -I
Workmen compensation Insurance (Please Check up with Contractor. These certificates are usually available with Contractors . just have to check their validity)	Obtained, Policy	The Contractor has been submitted the Insurance copy/ CAR Policy validity period 28 th -10-2017	Annexed -II
Pollution Under Control Certificate validity) PUC	Not applied	Contractor ensure shall comply as soon as possible	Reminder – following up- is required
Consent-for/ NOC - Establishing s	NOC submitted	NOC date 05- 05-2016	Annexed -III

Statutory Requirements	Road Code – TR-02	Details Explanation on the current status	Further Action Needed for Compliances and responsibility
hot mix plant, WMM , Batch mixed and Diesel Generator Sets		Also the layout plan along with landowner's agreement paper shall be submitted by the Contractor by as soon as possible	
Consent for operating hot mix plant, WMM, Batch Mixed and Diesel Generator Sets	After getting the CTE they will apply for CTO	Shall be complied	Noted - reminder following up
Batching plant	Applied for CTE	Application copy has been submitted	Annexed- IV Follow –up required
Mining Department for opening and operation of Quarries/ blasting	Paper has to be submitted to CSC	The Contractor is procuring the GSB & aggregate material from Akhaura, Agartala and agree to submit the documentary evidence of license/ chalan copy of quarry by as soon as possible Material they are purchasing from other sources	Chalan copy Annexed –V
NOC for Fuel Station	NA	NA	NA
Ambient Air Monitoring and analysis Report	Non –complied	Still has to be finalized the agency for monitoring	Reminder - Followed up required
Noise Monitoring and analysis Report	Non – complied	Still has to be finalized the agency for monitoring	Reminder -Followed up required
Water Monitoring and analysis Report	Non-complied	Still has to be finalized the agency for monitoring	Reminder - Followed up required

There is so far no permit required for permission of using ground water from the 'Ground Water Board'.The Contractor of NIESRIP , Trench -II has been obtained labour license and Workmen Compensation Insurance. Contractors has been obtained Consent to Establish/ (NOC) for the Hot Mix plant and WMM , for Batch mixed Plants application has been applied to pollution control board for CTE. Contractor of TR-02 has been

instructed to immediately apply / submit for the CTO , and Pollution under Control Certificate (PUC) for vehicles engaged on construction activity.

Regarding CTO, the Contractor shall apply for CTO after obtaining CTE. Details of statutory clearances are given in **Table No- 3..**

4.0 Compliance status with respect to the environmental covenants as stipulated in the Loan Agreement

As per the Loan Agreement for The North Eastern State Roads Investment Program (NESRIP) – Project Trench-II , Environmental Impact Assessment Review Framework under Schedule 5 to the FFA describes the environment assessment requirements and authorities responsibilities. Some of the responsibilities are described below :-

Table No. 4.0 STATUS OF COMPLIANCE WITH SAFEGUARDS LOAN COVENANTS

Safeguards Covenants	Description	Status of Compliance / Remarks
Schedule 5 Para No. 4	The Borrower shall ensure or cause the EA to ensure that the preparation, design, construction, implementation, operation and decommissioning of the Project, and all Subprojects' facilities comply with (i) all applicable laws and regulations of the Borrower and the State relating to environment, health, and safety; (ii) the Environmental Safeguards; (iii) the EARF; and (iv) all measures and requirements set forth in the respective IEE and EMP, and any corrective or preventative actions set forth in a Safeguards Monitoring Report.	It is being complied with. All environment safeguards requirements being implemented in accordance with relevant policies and regulations of the Government of India, State Government of Tripura and the ADB Safeguard Policy Statement, 2009 (SPS). All measures and requirements set forth in the respective EMPs are being implemented accordingly.
Schedule 5 Para No. 5	The Borrower shall ensure or cause the EA to ensure that all land and all rights-of way required for the Project, and all Project/Subproject facilities are made available to the Works contractor in accordance with the schedule agreed under the related Works contract and all land acquisition and resettlement activities are implemented in compliance with (i) all applicable laws and regulations of the Borrower and the State relating to land acquisition and involuntary resettlement; (ii) the Involuntary Resettlement Safeguards; (c) the RF; and (d) all measures and requirements set forth in the respective RP, and any corrective or preventative actions set forth in a Safeguards	The details shall be provided in Social Monitoring Report.

Safeguards Covenants	Description	Status of Compliance / Remarks
	Monitoring Report.	
Schedule 5 Para No. 6	<p>Without limiting the application of the Involuntary Resettlement Safeguards, the RF or the RP, the Borrower shall ensure or cause the EA to ensure that no physical or economic displacement takes place in connection with any Subproject until:</p> <p>(a) compensation and other entitlements have been provided to affected people in accordance with the RP; and</p> <p>(b) a comprehensive income and livelihood restoration program has been established in accordance with the RP.</p>	The details shall be provided in Social Monitoring Report.
Schedule 5 Para No. 7	In the event of any Subproject involving indigenous peoples, the Borrower shall ensure or cause the EA to ensure that the preparation, design, construction, implementation and operation of the Project, each Subproject and all Project/Subproject facilities comply with (a) all applicable laws and regulations of the Borrower and the State relating to indigenous peoples; (b) the Indigenous Peoples Safeguards; (c) the IPPF; and (d) all measures and requirements set forth in the respective IPP, and any corrective or preventative actions set forth in a Safeguards Monitoring Report.	The details shall be provided in Social Monitoring Report.
Schedule 5 Para No. 8	<p>(a) The Borrower shall ensure or cause the EA to ensure that all necessary budgetary and human resources to fully implement the EMP, the RP and the IPP as required, are made available.</p> <p>(b) The EA shall designate at least one expert each to supervise implementation of the EMPs and RPs.</p>	<p>All necessary budgetary and human resources required to implement the EMP is made available.</p> <p>One Environmental Expert and One Social Expert shall be placed to PIU (H.Q.) to supervise implementation of the EMPs and RPs respectively.</p>
Schedule 5 Para No. 9	<p>The Borrower shall ensure or cause the EA to ensure that all bidding documents and contracts for Works contain provisions that require contractors to:</p> <p>(a) comply with the measures and requirements relevant to the contractor set forth in the IEE, the EMP, the RP and the IPP (to the extent they concern impacts on affected people during</p>	<p>It is being complied.</p> <p>a) The project falls under category B and IEE for the subprojects has been prepared accordingly. EMP is part of contractor's agreement.</p>

Safeguards Covenants	Description	Status of Compliance / Remarks
	<p>construction), and any corrective or preventative actions set out in a Safeguards Monitoring Report;</p> <p>(b) make available a budget for all such environmental and social measures;</p> <p>(c) provide the TRPWD with a written notice of any unanticipated environmental, resettlement or indigenous peoples risks or impacts that arise during construction, implementation or operation of the Project/Subproject that were not considered in the IEE, the EMP, the RP or the IPP;</p> <p>(d) adequately record the condition of roads, agricultural land and other infrastructure prior to starting to transport materials and construction; and</p> <p>(e) fully reinstate pathways, other local infrastructure, and agricultural land to at least their pre-project condition upon the completion of construction.</p>	<p>b) Noted , Shall be complied</p> <p>c) Shall be complied with if situation arises</p> <p>d) Shall be complied with during execution of work</p> <p>e) Shall be complied with after execution of work</p>
Schedule 5 Para No. 10	<p>The Borrower shall ensure or cause the EA to ensure the following:</p> <p>(a) submit semi-annual Safeguards Monitoring Reports to ADB and disclose relevant information from such reports to affected persons , promptly upon submission;</p> <p>(b) if any unanticipated environmental and/or social risks and impacts arise during construction, implementation or operation of the Project/Subproject that were not considered in the IEE, the EMP, the RP or the IPP as applicable, promptly inform ADB of the occurrence of such risks or impacts, with detailed description of the event and proposed corrective action plan; and</p> <p>(c) no later than three months from the commencement of RP implementation of the first Subproject, engage qualified and experienced external experts or qualified nongovernmental organizations under a selection process and terms of reference acceptable to ADB, to verify information produced through the project monitoring process for resettlement, environment</p>	<p>a) Being complied.</p> <p>b) Shall be complied with if any such situation will arises</p> <p>c) Details covered under Environmental and Social Monitoring Report</p> <p>d) Shall be complied with if such situation arises</p>

Safeguards Covenants	Description	Status of Compliance / Remarks
	<p>and indigenous peoples (if any), and facilitate the carrying out of any verification activities by such external experts;</p> <p>(d) report any breach of compliance with the measures and requirements set forth in the EMP, the RP or the IPP promptly after becoming aware of the breach.</p>	
Schedule 5 Para No. 11	The Borrower shall ensure or cause the EA to ensure that no proceeds of the Loan under the Project are used to finance any activity included in the list of prohibited investment activities provided in Appendix 5 of ADB's Safeguard Policy Statement (2009).	EA ensures that no part of the Loan under the Project shall be used to finance any activity included in the list of prohibited investment activities provided in Appendix 5 of ADB's Safeguard Policy Statement (2009).
Schedule 5 Para No. 12	The EA shall ensure that Works contracts under the Project follow all applicable labor laws of the Borrower and the State and that these further include provisions to the effect that contractors; (i) carry out HIV/AIDS awareness programs for labor and disseminate information at worksites on risks of sexually transmitted diseases and HIV/AIDS as part of health and safety measures for those employed during construction; and (ii) follow and implement all statutory provisions on labor (including not employing or using children as labor, equal pay for equal work), health, safety, welfare, sanitation, and working conditions. Such contracts shall also include clauses for termination in case of any breach of the stated provisions by the contractors.	EA ensures that all the works contracts under the Project shall follow all applicable National/ State labor laws.

5.0 Compliance status with environmental management and monitoring plans as stipulated in the environmental documentation as agreed with ADB:

The Project management unit (PMU) in consultation with the Project Management Consultant has formulated standard format a reporting system on environmental management aspects to be reported by the CSCs to PMU for monitoring the implementation of EMMP. The information shared in these monitoring reports includes statutory clearances, environmental monitoring status at construction sites, measures for workers safety at construction site and camp site, and control measures being adopted etc.

For the effective management, implementation of the EMMP, the supervision consultants have designated their existing site staff for environmental coordination. Contractors for the respective contract have designated

Environmental Officers for the sound implementation of EMP. CSC have Environmental Specialist to closely monitor the - TR- 02 implementation of environmental management and monitoring plan (EMMP) for all the project road

Implementation of EMMP during the reporting period shall be complied and further needs to be strengthened in the areas such as monitoring of environmental quality, safety arrangements and usage of personal protective equipment by the workers.

6.0 Approach and methodology engaged for environmental monitoring of the project

Environment is important to ensure that environmental impacts are prevented and mitigated in conformity with the EMP, ADB safeguards to ensure that sound road developmental practices are followed for the protection of the environment and social aspects.

In TR-02 road , the Construction work is in full swing. PWD has commissioned the services of a Construction Supervision Consultant to supervise the construction activity including implementation of Environmental Management Plan by Contractor.

Constant monitoring of EMMP implementation on under construction projects is also being carrying out by Assisting Engineers (SDOs) of Kakraban Sub division and Siphajjala Sub- division . Concerned staff of SDOs regularly visit the construction sites and report to team leader about issues related to the environment and non- compliances of measures as given in EMP. Necessary directions, in case of non-compliances, are being given to the contractor on the site and through the writings about the procedures to resolve the issues or requirements.

The Construction supervision consultant shall be submitted periodic report that includes information on implementation of EMMP. The environmental information will captures in these reports includes statutory clearances obtained by contractor, environmental; monitoring status of construction sites, pollution control measures being adopted, and measures for workers safety at construction site and camp site etc. adopted, and measures for workers safety at construction site and camp site etc. The reporting is however, intermittent for project and steps are being taken for improving the reporting quality.

The Construction Supervision Consultant shall also be organized training program on "Implementation of Environmental Management & Monitoring Plan (EMMP)" for the Contractor under their CSC with an aim to provide training to the Contractor and improve compliance with environmental mitigation measures provided in contract documents and as agreed with ADB (Annexure -1).The PIU staff, Supervision Consultant, and Contractor's key staff were invited to attend the. The various issues covered in this training program includes Environmental Safeguards Requirements, Environmental Management & Monitoring Plan, Implementation of

EMMP, Roles and Responsibilities of ADB's/ Client's/ Consultant's/Contractor, Clearances Required for Project, Challenges in Implementing EMMP, and further ensure "AIDS awareness Program shall be conducted as soon as possible etc.

7.0 Monitoring of environmental receptors/attributes (e.g. ambient air, surface water, noise etc.)

Besides regular on site monitoring for the implementation of Environmental Management Plan, air quality, water quality and noise levels were required to be monitored to check any adverse impact due to construction activities and to ensure that plants and machineries working on project do not pollute the surrounding environment. The monitoring of environmental variables was carried out as per the agreed Environmental Monitoring Plan.

The Contractor has to be hired the services of environmental monitoring laboratories; accredited by NABL to monitor the environmental parameters. The environmental attributes to be monitored include the air, noise and water quality parameters at the proposed construction sites in the project corridors. In air quality the parameters monitored include PM₁₀, PM_{2.5}, SO₂, NO_x, and CO. The water quality parameters include temperature, pH, EC, TDS, BOD, COD, Hardness, Calcium, Magnesium, Chloride, Sulphate, total coliform, etc. The parameters monitored are also compared with the Bureau of Indian Standard.

The baseline environmental monitoring has already been conducted in TR-02 and detailed results for ambient air quality, water quality, and soil quality and noise levels are provided in IEE reports¹

Subsequently a comprehensive environmental monitoring plan has been prepared and provided in IEE Report. The monitoring program has been designed focusing monitoring during construction and operation stage. The following Environmental Parameters shall be monitored:

- a) Ambient Air Quality Monitoring
- b) Water Quality
- c) Noise Level Monitoring
- d) Soil Quality Monitoring

¹Ref. IEE Reports for TR-02 posted on ADB website

8.0 Any other environmental aspects, impacts observed during implementation which were not covered earlier

There is no such environmental aspect that was not covered earlier.

8.1 Status of Environmental Monitoring Plan Implementation

During the initial construction phase and during the construction stage environmental monitoring has not been conducted till (January 2016 to June 2016),

The contractor has been instructed to carry out the environmental monitoring as per the environmental monitoring plan provided in IEE report and submit a copy of the monitored results on regular basis. Since the project is in a very infant stage hence mostly construction activities are being undertaken.

9.0 Details of complaints received from public and action taken thereof to resolve

It would be pertinent here to refer the Asian Development Bank's policy, which requires proper mechanisms for resolution of disputes that may arise from any aspect of the compensation and development process. The mechanisms should be "affordable and accessible," and third parties independent of the implementers should be available at the appropriate point in the process. The grievance procedure need to be simple, administered in the first instance at the local level to facilitate access, flexibility and open to various proofs taking into account the need for speedy, just and fair resolution of their grievances.

In the course of EMP implementation for this project, the Executing Agency facilitated with the help of NGO/SC for the constitution of Grievances Redressal Committee (GRC) at district level for the sub-project road.

Moreover, one grievance received/ reported from the field which has been addressed by Additional Collector. During the field visit of Environmental expert there is no any grievances were received from the a along the project corridor population.

There was no any major accident and grievances, received from the project road, however, if any grievances and doubts of the villagers shall be redressed in future , that time by the Executing Agency with the consultation of local community/ authorities, and through awareness campaign will resolve the issues etc. further there is need to work on other activities of EMP implementation. Such activities are related with:

- EMP implementation training program / Workshop,
- Information on Labour on Construction site, plants site and safety précautions etc.

So far, no complaints from public have been received regarding any items, especially EMP, of construction work in different contract packages.

10.0 Follow-up actions and conclusion

Site observations issues –:

The copy of Consent to Establish (CTE/ NOC) for HMP/Drum Mix Plant, WMM has been submitted and Copy of application of Batching plant has been submitted

The Contractor has been submitted the documentary evidence (Chalan copy) of license quarry of Akhaura, Agartala

PUC Certificates of all Construction Vehicles.

Borrow area layout and landowners agreement.

Copy of application submitted to SEIAA for Borrow Area approval, if any and subsequently the approval of the same.

Construction Camp details along with Camp layout plan and Landowner's Agreement.

Details of proposed Environmental Monitoring Agency for Environmental Monitoring along the project section and Environmental Monitoring Plan (Quarterly) throughout the project period, except monsoon period.

Details of identified debris disposal site along with land owner's agreement , is has been observed many places all along the alignment .

Deployment of Environmental Officer by 1st week of Oct 2015. But during the site visit there is o any environmental office on site

Contractor has been conducted HIV /AIDS program on date 24th -04-2016 .

The detailed layout of identified sensitive locations such as school/college/hospital along the project road for provision of Noise barrier as per design shall be submitted by the Contractor as soon as possible . The same shall be discussed and finalized jointly by the Consultant & Client still pending .

The detailed layout of identified cultural property/school along the project road for provision of sitting bench as per design shall be submitted by the Contractor as soon as possible . The same shall be discussed and finalized jointly by the Consultant & Client.

Actions Required

- a) Adequate safety provisions should be implemented in project road at bridge, CD's structures as well as construction work fronts.
- b) Provision of safe, potable drinking water in labour camp as well as construction work fronts
- c) All the CD's locations taken up for the construction are very much in unsafe condition and instructed to immediately barricade those locations with guiding signboards placement on either approaches of the work locations
- d) Procurement, distribution and training towards use of PPEs for all TR-02 road , especially for those working with bitumen and concrete work
- e) Proper election, designing and operation of debris, excavated materials, and scarified materials should be dump during the construction stage.

- f) Proper prevention/ measures of oil spillage at HMP construction sites, waste oil and lubricants containment, storage/handling and safe confinement of such spillages.
- g) Instructed Bituminous dust /fines from the Bag filters of HMP need to be collected stored and disposed of time to time but still not compliances
- h) Road Inspections along with Environment Specialist PIUs , FE & Project Manager of Contractor to assess EMP Compliance & onsite explanation of non-compliance, if found any and to further advise to bring improvement in compliance of the same.

Follow up actions and Conclusions

Supervision consultants has assessed that the implementation of EMP during the reporting period, some areas such as HMP , WMM Plant, safety arrangements, traffic management and usage of personal protective equipment (PPE) by the construction workers require to be improved further. CSC has instructed the civil work Contractor to take immediately appropriate mitigation actions to improve implementation of traffic , worker safety and safety measures at CDs as well as all along the road alignment , and to ensure that all workmen and staff employed on site use safety gear provided to them. Correspondence has been made to contractor regarding health and safety maintenance, implementation of EMP etc. Following are the major issues for the follow up in the next monitoring period:

- ★ The supervision consultants has advised the contractor to obtain all statutory clearances like consent to establish and operate plants and Machineries from Tripura State Pollution Control Board.
- ★ Monitoring of EMP implementation work at site.
- ★ Contractor of TR-02 has been instructed to immediately finalized the environmental Monitoring agency (NABL accredited), which will be carried out the Environmental Monitoring.

Annexure -VI

EMP Compliance as observed in the Construction Camps and road site for all contractor TR- 02 January 2016 to June 2016

Compliance to EMP provisions for construction camp have been observed in the Construction camp established and road construction site by all contractors as evident from photographs given in foregoing page



Photo-1 Safely sign boards are missing at along the road



Photo-2 Soil directly going through water body (ch-3 +100) RHS



Photo-3 soil cutting along the road site camp site karaban (ch-4 -) LHS



Photo-4 - Oil spillage at base camp

Jan to June '16

ANNEXURES

Annexure J

PUBLIC WORKS DEPARTMENT, TRIPURA

Name of Work : Improvement and Up-gradation of road section of Udaipur to Melaghar (TR82)
(Trench-2 road in the State of Tripura)

Contractor : ECI-NAYAK (JV)



Consultant: Egis International S.A& Egis India Consulting Engineering Pvt. Ltd. (JV)

egis

SUMMARY OF BORROW AREA

Location : BA-03
Length : 11+400/05
Width : 12.5m

4. Offset from existing Road : 2.1km.
5. Layout Plan : Attached
6. Total Quantity : 10621.50 cum.

Date of Sampling	WDD, g/cc	OMC, %	LL, %	PL, %	PI, %	Gravel (%)	Sand Content (%)	Silt Clay (%)	Fsi, %	CBR, %	Classification of Soil	Remarks
23.08.18	1.890	13.30	29.80	18.53	10.91	6.10	40.00	53.90	15.00		CL	
23.08.18	1.900	9.50	29.60	20.08	9.52	3.20	41.40	55.40	20.00	12.34	CL	
23.08.18	1.890	9.10	33.20	23.05	10.15	5.00	37.50	57.60	15.00		CL	
23.08.18	1.890	11.20	30.20	21.30	8.50	6.20	40.20	53.60	20.00	14.36	CL	
23.08.18	1.900	11.40	30.40	20.77	9.63	7.00	41.10	51.90	20.00		CL	
23.08.18	1.880	12.20	31.00	18.99	12.01	4.70	36.90	58.40	15.00	13.08	CL	
23.08.18	1.880	10.50	31.20	22.05	9.15	6.10	40.40	53.50	15.00		CL	
23.08.18	1.890	10.40	30.80	18.90	11.90	3.40	41.30	55.30	20.00	14.26	CL	
23.08.18	1.910	12.30	29.60	21.19	8.41	3.50	41.70	54.80	25.00		CL	
23.08.18	1.900	11.90	29.60	20.08	9.52	3.15	41.70	55.20	15.00	14.15	CL	
23.08.18	1.880	11.20	29.60	21.90	7.70	5.30	27.90	50.80	15.00		CL	
23.08.18	1.890	10.50	30.00	20.14	9.55	2.60	42.30	54.10	20.00	13.40	CL	
Avg.	1.892	11.13	30.42	20.61	9.81	4.77	40.20	55.07	17.92	13.60		

Remarks from Contractor's Representative
Natalu Kumar

All tests done as per relevant codes and specifications. Test results are satisfactory.

Remarks from Consultant's Representative

All the test for Borrow area No.3 has been done jointly as per IS 2720. The relevant tests found satisfactory. Average CBR value confirmed and achieved 13.6% hence it is recommended for approval of Subgrade and Soldier.

Signature
ME.



ELECTION COMMISSION OF INDIA

ভারতের নির্বাচন কমিশন

IDENTITY CARD GHW0239186

পরিচয় পত্র



Elector's Name : Prashanta Kumar Sarkar

নির্বাচকের নাম : প্রশান্ত কুমার সরকার

Father's Name : Dilip Sarkar

পিতার নাম : দিলীপ সরকার

Sex : M
লিঙ্গ : পুরুষ

Age as on 1.1.2000 : 25
১.১.২০০০-এ বয়স : ২৫

IDENTITY CARD -GHW0239186

Address : Buiddamura
Town/Vill. - Rani
PS - Radhakishorepur
Sub Division - Udaipur
District - South Tripura Pin - 799105

ঠিকানা : বুদ্ধামুরা
গ্রাম/গ্রাম - রানী
পোস্ট - রূপকিশোরপুর
সাবডিভিশন - উদাইপুর
জিলা - দক্ষিণ ত্রিপুরা পিন - ৭৯৯১০৫

Facsimile Signature
Electoral Registration Officer
নির্বাচন নিবন্ধন অধিকারিক

For 34-Kakrabon Assembly Constituency
৩৪-কাকড়াবন বিধানসভা নির্বাচন কেন্দ্র

Place : Udaipur, South Tripura
স্থান : উদাইপুর, দক্ষিণ ত্রিপুরা

Date : 20.07.2002 তারিখ : ২০.০৭.২০০২

This card may be used as an identity card under
different government schemes.

Director: ECI-NAYAK(JV)

PIT PLAN OF BORROW AREA NO-03

CH: 0+000
Udaipur

CH: 13+400 I/S

CH: 13+400 I/S

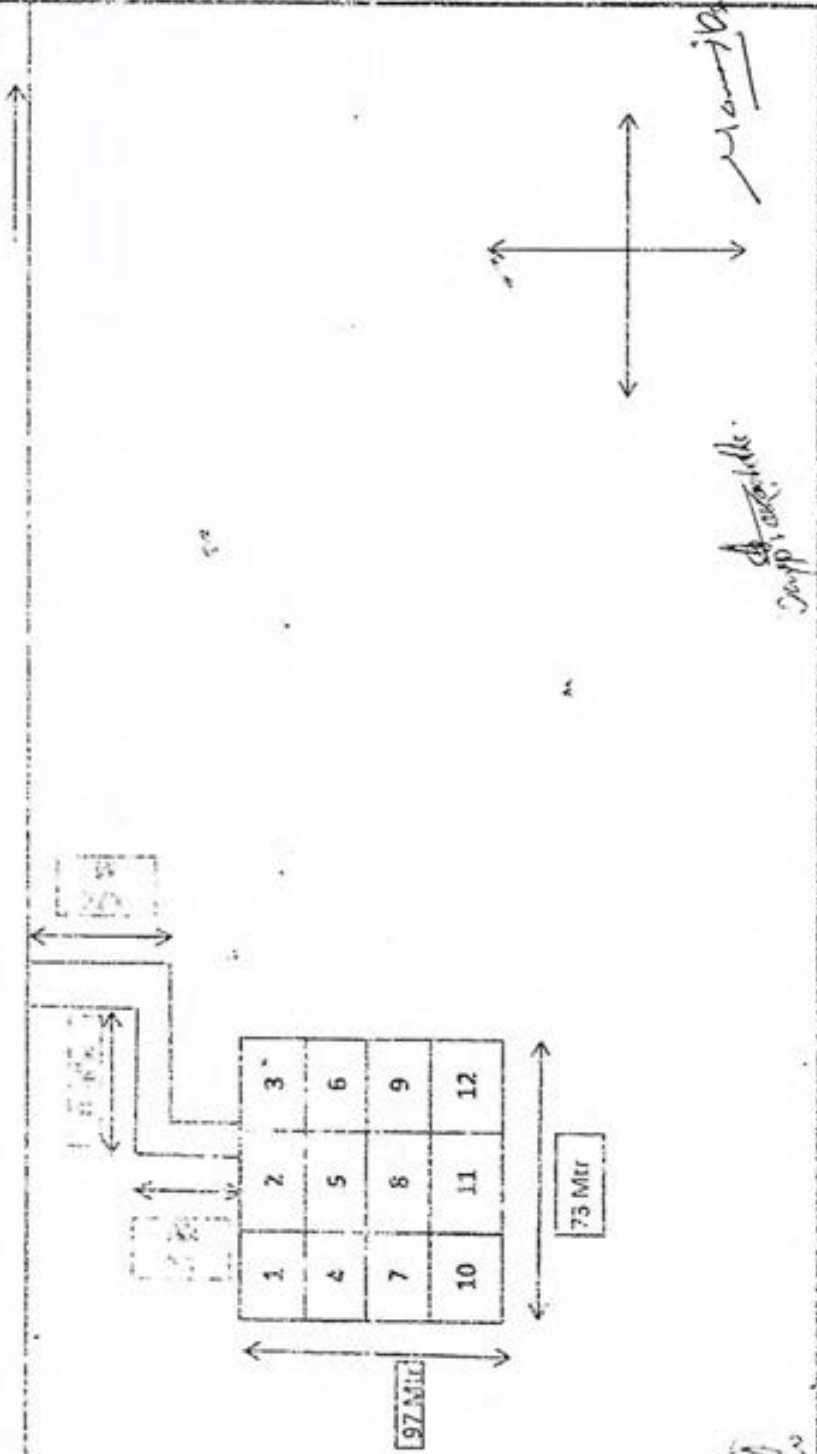

ANI

1 km

10621.50

3

[Signature]

Name of Work : Implementation and Up-gradation of road section of Imphal to Melaghar (Tranche-2)

(Tranche-2 road in the State of Tripura)

Consultant: Egis International S.A & Egis India Consulting Engineering Pvt. Ltd. (JV)

Contractor : ECI-NAYAK (JV)

LAYOUT OF BORROW AREA NO-03

CH-0+300

Melaghar

CH-11+400 L/S

CH-0+000

Udaipur

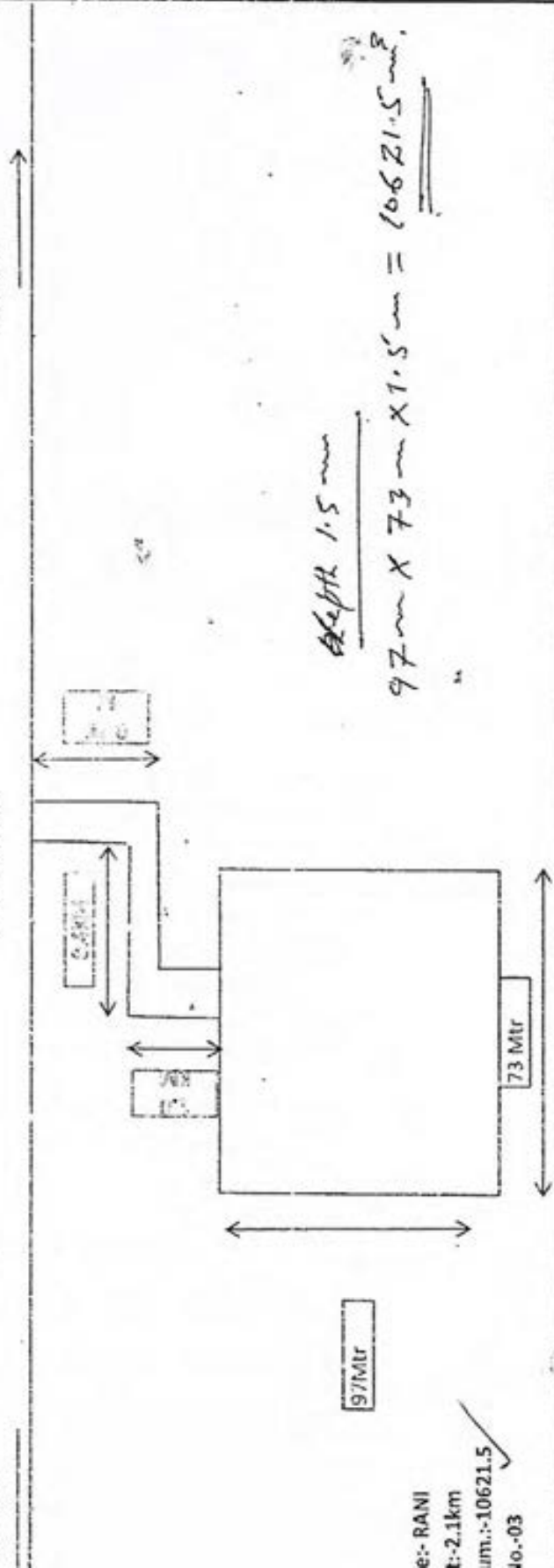

Site: RANI

Dist: 2.1 km

Area: 10621.5

No.-03

Signature
Date: 10/10/14



Agreement

1. Aman Miah S/O - Hasem Miah, P/o - Rani, Dist - Gomati, Tripura,
 2. Alkaeh Miah, S/O - Najir Ali, P/O - Rani, Dist - Gomati, Tripura,
 3. Prasanta Kr Sarkar, S/O - Dilip Sarkar, P/O - Rani, Dist - Gomati, Tripura,

00AA 373107

ECI - NAYAK (JV) did the agreement to purchase soil from the high land of Rani High School at the rate of Rs, -50 (fifty) of a small Car and Rs, - 80 (Eighty) of a big Car from us i.e, the above stated persons. In the surroundings of the 5 (five) Kani high land of Rani High School are in the East Prahallad Debnath, in the West Narabashi Murashing, Road in the North and the residence of Kashipada Murashing in the South. According to the agreement it was mentioned that after submitting the account of the numbers of Cars carried soil from high land of Rani High School to ECI - NAYAK (JV) Company, the Company would pay the cost of the soil in the Bank Account No. 40770100002113 of Prasanta Kr sarkar of Baroda Bank at Mirza Branch or the said Company would pay in cash within few days.

Being a Pradhan of Rani Gram Panchayat under Kakraban R.D Block, I have no objection if the ECI - NAYAK (JV) Company will purchase soil from the above stated soil sellers according to the agreement.

Signature of sellers

Signature of Villagers

1. Aman Miah
 2. Alkaeh Miah
 3. Prasanta Kr Sarkar
1. Bidhan Chandra
 2. Rupan Nath
 3. Kamal Sil

Paritana Biswas (150)
 Pradhan
 Rani G.P.
 Kakraban R.D. Block
 Udaipur, Gomati Tripura

FORM— II
(See rule 24(1))

Annexure - II

GOVERNMENT OF TRIPURA
OFFICE OF THE REGISTERING OFFICER,

Ref No. BCEW/UDP/RC/669

Date :- 16-05-16

A certificate of Registration hereby granted under sub-section (3) of section 7 of the Building and Other Construction Work (Regulation of Employment and Conditions of Service) Act 1996 and the rules made thereunder To M/S E.C.I-NAYAK (JV)
Kakraban, Udaipur having the following particulars subject to conditions laid down in the ANNEXURE.

Postal address/Location where building or other construction work is to be carried on by the Employer. :- ADB Road Project, Udaipur to Melaghar.

Name and address of employer including location of the building and other construction work. :- E.C.I-NAYAK, Kakraban, Udaipur.

Name and permanent address of the establishment. :- —DO—

Nature of work in which building workers are employed or are to be employed. :- Construction work.

Maximum number of building workers to be employed on any day by the employer. :- 100 (one hundred) Nos.

Probable date of commencement and completion of work. :- —

Other particulars relevant to the employment of building workers. :- —

Signature of Registering Officer
with seal.

ANNEXURE

The registration granted herein above is subject to the following conditions namely :-

The certificate of registration shall be non-transferable.

The number of workmen employed or building workers in the establishment shall not, on any day, exceed the maximum number specified in certificate of registration.

Have or provided in these rules, the fees paid for the grant of registration certificate shall be non-refundable.

The rates of wages payable to building workers by the employer shall not be less than the rates prescribed under the Minimum Wages Act, 1948 (11 of 1948) for such employment where applicable and where the rates have been fixed by agreement, settlement or award, not less than the rates so fixed and.

The employer shall comply with the provisions of the act and the rules made thereunder.

Form VI

[See rule 19 (1)]

Government of Tripura
Office of the Licensing Officer

No. 1316, 11.16.05.16.

Fee paid Rs. 6.00/-

LICENCE

License is hereby granted to E.C.I. NAYAK (J.V.) KAKKABHAN, Udaipur.
Section 12(1) of the Contract Labour (Regulation and Abolition) Act, 1970, Subject
to conditions specified in Annexure.

The Licence shall remain in force till 15th May 2017.

16th May 2016.

Licensing Officer
Signature and seal
of the Licensing Officer
Government of Tripura

RENEWAL (rule 23)

Renewal	Fee paid for Renewal	Date of Expiry
---------	----------------------	----------------

Signature and seal
of the Licensing Officer

ANNEXURE

is subject to the following conditions :

The Licence shall be non-transferable.

The number of worker employed as contact labour in the establishment shall
any day, exceed.....100 (Hundred) MS.....

Except as provided in the rules the fees paid for the grant, or as the case may
renewal of the licence shall be non-refundable.

The rates of the wages payable to the workmen by the contractor shall not be
the rates prescribed for the Schedule of employment under the minimum wages
where applicable, and where the rates have have fixed by agreement, settlement
not less than rates fixed.

In case where the workmen employed by the contractor perform the same or
kind of work as the workmen directly employed by the principal employer of the estab-
the wages rates, holidays, hours of work and other conditions of service of work-
the contractor shall be the same as applicable to the workmen directly employed by
principal employer of the establishment on the same or similar kind of work provided that
in case of any disagreement with regard to the type of work the same shall be decided by
Labour Officer whose decision shall be final.

In other cases the wages rates, holidays, hours of work and conditions of ser-
the workmen of the contractor shall be such as may be specified in this behalf by the
Labour Officer.

In every establishment where 20 or more women are ordinarily employed as
labour there shall be provided 2 rooms or reasonable dimensions for the use of their
under the age of six years. One of such rooms would be used a play room for the
and other as bed room for the children.

For this purpose the contractor shall supply adequate number of toys and games
play room and sufficient number of cots and bedings in the sleeping room. The stan-
construction and maintenance of the creches may be such as may be specified in
half by the Chief Labour Officer.

The Licence shall notify any change in the number of workmen or the conditions
to the Licensing Officer.

Annexure - III

EC - NAYAK



Branch Office :

Swarupananda Road
PO : Lumding - 782 447
Dist : Nagon, Assam
Tel : 03674 - 263073/265189
Fax : 03674 - 265189

19/04/2016

Date 03/05/2016

Letter to JV with Egis India Consulting Engineers Pvt. Ltd,
Joint Bank of Jagannath Deghi,
Joint Bank,

Contract and Up gradation of road section of Udaipur to Melaghar, TR CW-01 in the
under North Eastern State Roads Investment Program (ADB Project No. 37143-02
TR-CW1.

Contract clause 18 of GCC.

Letter no. 132(b)/TL/ECI-NAYAK/0204 Dated 19.03.2016

132(b)/TL/ECI-NAYAK/0204 Dated 19.03.2016

Letter no. 1(b)/TL/PIU/0161 Dated 04.01.2016

Letter no. AGTL/EN/0234/2016 Dated 18.03.2016.

In our above letter, we are submitting herewith the evidence of Insurances viz. (1)
Contractor's Equipment (ref cl. 18.2 of GCC), (2) Insurance against injury to
property (ref cl. 18.3 of GCC) & (3) Insurance of contractor's personnel (ref
cl. 18.4 of GCC). It is to inform that the preparation of other documents such as labour license and
Pollution control certificate is under process and will be submitted soon (relevant
documents are enclosed herewith for kind reference please).
We intend to send our IPC-3 to Employer for earlier payment. This will improve our cash
flow in turn will be beneficial for the project progress.
We assure of our best services as always.

Fully



Enclosed above (06 Pages)

CC/PIU, ADB Project PWD(R&B), Udaipur, Tripura for kind information please.
CC/PIU, ADB Project PWD(R&B), Udaipur, Tripura for kind information please.



नॅशनल इन्शुरेन्स कम्पनी लिमिटेड

(पब्लिक लिमिटेड कंपनी का उद्गम)

पंजीकृत कार्यालय : 3 मिडिल्टन स्ट्रीट, कलकत्ता-700 071

NATIONAL INSURANCE COMPANY LIMITED

(Subsidiary of General Insurance Corporation of India)
Legal Office : 3, MIDDLETON STREET, CALCUTTA - 700 071

एक व्यवहार का पता
Address for Communication

नॅशनल इन्शुरेन्स कम्पनी लिमिटेड

42, अखौरा

अगर्ताला - 799 001

National Insurance Co. Ltd.

42, Akhaura Road,

Agartala, Tripura-799 001.



CONTRACTOR'S ALL RISKS INSURANCE POLICY

THE INSURED named in the Schedule hereto had made to NATIONAL INSURANCE COMPANY LIMITED (hereinafter called "the Company") a written proposal by completing a Proposal Form which together with any other documents made in writing by the Insured for the purpose of this Policy, is deemed to be incorporated herein.

THIS POLICY OF INSURANCE WITNESSETH that subject to and in consideration of the Insured having paid to the Company the premium mentioned in the Schedule and subject to the terms, exclusions provisions and conditions contained herein or undered hereon the Company will indemnify the Insured in the manner and to the extent hereinafter provided.

GENERAL EXCLUSIONS :

THE COMPANY will not indemnify the Insured in respect of loss, damage or liability directly or indirectly caused by or arising out of or aggravated by :-

- (a) War, invasion, act of foreign enemy, hostilities or war like operations (whether war be declared or not), civil war, rebellion, revolution, insurrection, mutiny, civil commotion, military or usurped power, martial law, usurped power, commandeering a group of malicious persons or persons acting in behalf of or in connection with any political organisation, requisitions or destruction or damage by order of any Government or any authority or by any Public, Municipal or Local Authority ;
- (b) Atomic energy, nuclear radiation or radioactive contamination ;
- (c) Losses due to willful negligence of the Insured or of his responsible representative ;
- (d) Losses of any kind whether total or partial.

IN CASE, not in other proceedings where the Company, allege that by reason of the provisions of exclusion (a) the loss, damage or liability is not covered by this insurance, the burden of proving that such loss, damage or liability is covered shall be upon the Insured.

TERM OF COVER :

THE liability of the Company shall commence, (notwithstanding any date to the contrary stated in the Schedule) only from the time of commencement of work or after the unloading of the property from any conveyance at the site specified in the schedule whichever is earlier and shall continue until the work is completed or put into service by the Principal prior to the expiry date specified in the policy or until the work is completed or put into service by the Principal prior to the expiry date specified in the policy.

IF the construction period is shorter than the period indicated in the Schedule, no refund of premium shall be made.

IF the insurance shall expire on the date specified in the Schedule but if the work of construction included in the Schedule is not completed within the time specified hereunder, the Company may extend the period of cover but the Insured shall pay to the Company additional premium at rates to be prescribed by the Company.

SECTION - I MATERIAL DAMAGE

THE Insured hereby agrees with the Insured (subject to the exclusions and conditions contained herein or hereon) that it, at any time during the period of insurance stated in the said Schedule or during any further period of extension thereof the property (except packing materials of any kind) or any part thereof described in the Schedule be lost, damaged or destroyed by any cause other than those specifically excluded hereunder, in a manner necessitating replacement or repair the Company will pay or make good all such loss or damage upto an amount not exceeding in respect of each of the items specified in the Schedule the sum set opposite thereto and not exceeding in the whole the total sum insured hereby.

THE Company will also reimburse the Insured for the cost of clearance and removal of debris following upon any loss or damage to an admissible claim under this Policy but not exceeding in all the sum (if any) set opposite to it in the Schedule. The term 'debris' means debris only of the Insured property and the cost of clearance and removal of debris pertaining to property not insured hereunder.

U 10

EXCLUSIONS TO SECTION - I

The Company, shall not, however, be liable for :-

- (a) the first amount of the loss arising out of each and every occurrence shown as Excess in the Schedule;
- (b) loss discovered only at the time of taking an inventory ;
- (c) normal wear and tear, gradual deterioration due to atmospheric conditions or lack of use or obsolescence, otherwise, rust, scratching of painted or polished surfaces or breakage of glass ;
- (d) loss or damage due to faulty design ;
- (e) the cost of replacement, repair or rectification of defective material and/or workmanship, but this expense shall be limited to the items immediately affected and shall not be deemed to exclude loss of or damage to correctly executed items resulting from an accident due to such defective material and/or workmanship ;
- (f) the cost necessary for rectification or correction of any error during construction unless resulting in physical loss or damage ;
- (g) loss of or damage to files, drawings, accounts, bills, currency, stamps, deeds, evidence of debt, notes, securities, cheques, packing materials such as cases, boxes, crates ;
- (h) any damage or penalties on account of the Insured's non-fulfilment of the terms of delivery or completion under his Contract or construction or of any obligations assumed thereunder or lack of performance including consequential loss of any kind or description or for any aesthetic defects or operational deficiencies ;
- (i) loss of or damage to vehicles licensed for general road use or water borne vessels or Machinery/Equipment mounted or operated or fixed on floating vessel/craft/barges or aircraft.

PROVISIONS APPLYING TO SECTION - I

Memo 1. SUM INSURED : It is a requirement of this Insurance that the sum of Insurance stated in the Schedule shall not be less than the completed value of the contract works, on completion of construction inclusive of material, wages, freight, customs dues, construction cost and material or items supplied by the Principal and the Insured undertakes to increase or decrease the amount of Insurance in the event of any material fluctuation in the level of wages or prices.

Provided always that such increase or decrease should take effect only after the same has been recorded on the Policy by the Company, before the occurrence of any claim hereunder.

If in the event of the occurrence of a loss or damage it is found that the Sum Insured representing the complete value of contract works and/or of particular items involved is less than the amount required to be insured, the amount recoverable under the Policy shall be reduced in such proportion as the Sum Insured bears to the amount required to be insured.

Memo 2. PREMIUM ADJUSTMENT : The Sum Insured under the Policy representing the complete value of the contract works shall be adjustable at completion of the construction on the basis of actual values to be declared by the insured in respect of freight and handling charges, custom dues and construction cost and difference in premium shall be met with by payment at the rate agreed to or by the insured as the case may be. Any increase or decrease in the prime cost of materials shall not be the subject matter of premium adjustment.

Memo 3. REINSTATEMENT OF SUM INSURED : In the event of loss or damage the Insurance shall nevertheless be maintained in force during the period of insurance for the Sum Insured the Insured undertaking to pay a prorata additional premium on the full amount of each claim for the loss or damage from the date of such loss to the expiry of the period of insurance.

Memo 4. BASIS OF LOSS SETTLEMENT : In the event of any loss or damage the basis of any settlement under this Policy shall be :

- (a) in the case of damage which can be repaired the cost of repairs necessary to restore the property to the condition immediately before the occurrence of damage less salvage, or
- (b) in the case of a total loss - the actual value of the property immediately before the occurrence of the loss less salvage ;

however only to the extent the cost claimed has to be borne by the Insured and to the extent they are included in the Sum Insured and provided always that the provisions and conditions have been complied with.

All damage which can be repaired shall be repaired, but if the cost of repairing any damage equals or exceeds the value of the property immediately before the occurrence of the damage, the settlement shall be made on the basis provided for in (b) above.

The cost of any provisional repairs will be borne by the Company if such repairs constitute part of the final repairs and do not increase the total repair expenses.

The cost of any alterations, additions and/or improvements shall not be recoverable under this Policy.

Memo 5. EXTENSION OF COVER : Any extra charges incurred for overtime, work on holidays, express freight (excluding air freight) are not covered by this insurance, unless agreed upon at an additional premium

Memo 6. CONSTRUCTION PLANT AND MACHINERY : Loss of or damage to Construction Plant and Machinery excludes loss or damage directly caused by its own explosion or its own mechanical or electrical breakdown or derangement.

Memo 7. SURROUNDING PROPERTY : Loss of or damage to property located on or adjacent to the site and belonging to or held in care, custody or control of the Principal(s) or the Contractor(s) shall only be covered if occurring directly due to the construction of the items insured under Section I and happening during the period of cover, and provided that a separate Sum thereto has been entered in the Schedule under Section I, item 4 for Principal's specified surrounding property. This cover does not apply to construction/erection machinery, plants and equipment.

National Insurance Company Limited
10, Station Street, Post Box No. 9229, Kolkata 700 071

Contractors All Risk Insurance

Agent Name: DIPKA KANI DAS

Agent Contact No: 9436136485

Issuing Office Code : 201000

THAKURPATA TOWNSHIP,
THAKURPATA, MANDAL, RR
TETANGANA

Address: 42, Akhaurah Road, Tripura West,
Agartala, Tripura - West, Tripura
Pin : 795001

Tel: 0361 2323836 (D) 2325793 (Fax : 0361232383)

PaidUp Cap: Upto Rs. 15 Crores

Policy Type: Corporate

Validity: To Midnight of 28/10/2017

Policy No: 000000/01/16/000001677

RUPES SEVEN LAKH FOURTEEN THOUSAND ONE HUNDRED FIFTY ONLY

	Sum Insured (₹)
000000/01/16/000001677	86,00,00,000.00

Total Sum Insured : (₹) 86,00,00,000.00

RUPES EIGHTY SIX CRORE ONLY

ALL RISK (AS PER POLICY SCHEDULE ATTACHED)

IMPROVEMENT AND UPGRADE OF ROAD FROM UDAIPUR TO MELAGUJH (ROAD
CONSTRUCTION) TR62

EARTH QUAKE, (MAINTENANCE COVER 12 MONTH) TPL, RS: 1,00,00,000/-

AS PER POLICY SCHEDULE ATTACHED

AS PER POLICY SCHEDULE ATTACHED

AS PER POLICY SCHEDULE ATTACHED

AS PER POLICY SCHEDULE ATTACHED

Stamp Duty : ₹ 0.00

Swachh Bharat Cess : ₹ 3,571.00

Chargable : ₹ No

Total : ₹ 8,17,762.00

For information on Products, Services and Grievance Redressal.

Policy has been signed at Tripura
Date: 2016

कृते नेशनल इन्शोरेंस कंपनी लिमिटेड
For NATIONAL INSURANCE COMPANY LTD.

Authorized Signatory

IRDA Regn. No: 58

मंडल प्रबंधक

DIVISIONAL MANAGER OF 1

10/10/16 00000010000000 - 6.9.0.0

42, Annapurna
Mangalore
Karnataka 575 001

© 2005 The Authors
Journal compilation © 2005 Blackwell Publishing Ltd

Agent Contact No: 5436236485

PO BOX 18, PAMULAVATI TOWNSHIP,
TIRUPATI DISTRICT, NARASIPETA, KA

Residence: Telangana
Date: 2020

Printed on 28/10/2017 at 10:10:10

\$5.00 PER MONTH (AS PER POLICY SCHEDULE ATTACHED)

EARTH QUAKE, (MAINTENANCE COVER 12 MONTH) TPL, RS: 1.00.00.000/-

AS PER POLICY SCHEDULE ATTACHED

AS PER POLICY SCHEDULE ATTACHED

12. FBI POLICY CONSIDERED ATTACHED

Swachh Bharat Cess : ₹ 3,571.00

Total : ₹	8,17,702.00
-----------	-------------

10

रा. नेशनल इन्शुरेन्स कंपनी लिमिटेड
RATIONAL INSURANCE COMPANY LTD.



1206643884743, IRDA Regn. No: 58

1998, 1999, 2000, 2001, 2002, 2003, 2004, 2005, 2006, 2007, 2008, 2009, 2010, 2011, 2012, 2013, 2014, 2015, 2016, 2017, 2018, 2019, 2020, 2021, 2022, 2023, 2024, 2025, 2026, 2027, 2028, 2029, 2030, 2031, 2032, 2033, 2034, 2035, 2036, 2037, 2038, 2039, 2040, 2041, 2042, 2043, 2044, 2045, 2046, 2047, 2048, 2049, 2050, 2051, 2052, 2053, 2054, 2055, 2056, 2057, 2058, 2059, 2060, 2061, 2062, 2063, 2064, 2065, 2066, 2067, 2068, 2069, 2070, 2071, 2072, 2073, 2074, 2075, 2076, 2077, 2078, 2079, 2080, 2081, 2082, 2083, 2084, 2085, 2086, 2087, 2088, 2089, 2090, 2091, 2092, 2093, 2094, 2095, 2096, 2097, 2098, 2099, 2100, 2101, 2102, 2103, 2104, 2105, 2106, 2107, 2108, 2109, 2110, 2111, 2112, 2113, 2114, 2115, 2116, 2117, 2118, 2119, 2120, 2121, 2122, 2123, 2124, 2125, 2126, 2127, 2128, 2129, 2130, 2131, 2132, 2133, 2134, 2135, 2136, 2137, 2138, 2139, 2140, 2141, 2142, 2143, 2144, 2145, 2146, 2147, 2148, 2149, 2150, 2151, 2152, 2153, 2154, 2155, 2156, 2157, 2158, 2159, 2160, 2161, 2162, 2163, 2164, 2165, 2166, 2167, 2168, 2169, 2170, 2171, 2172, 2173, 2174, 2175, 2176, 2177, 2178, 2179, 2180, 2181, 2182, 2183, 2184, 2185, 2186, 2187, 2188, 2189, 2190, 2191, 2192, 2193, 2194, 2195, 2196, 2197, 2198, 2199, 2200, 2201, 2202, 2203, 2204, 2205, 2206, 2207, 2208, 2209, 2210, 2211, 2212, 2213, 2214, 2215, 2216, 2217, 2218, 2219, 2220, 2221, 2222, 2223, 2224, 2225, 2226, 2227, 2228, 2229, 2230, 2231, 2232, 2233, 2234, 2235, 2236, 2237, 2238, 2239, 2240, 2241, 2242, 2243, 2244, 2245, 2246, 2247, 2248, 2249, 2250, 2251, 2252, 2253, 2254, 2255, 2256, 2257, 2258, 2259, 2260, 2261, 2262, 2263, 2264, 2265, 2266, 2267, 2268, 2269, 2270, 2271, 2272, 2273, 2274, 2275, 2276, 2277, 2278, 2279, 2280, 2281, 2282, 2283, 2284, 2285, 2286, 2287, 2288, 2289, 2290, 2291, 2292, 2293, 2294, 2295, 2296, 2297, 2298, 2299, 2300, 2301, 2302, 2303, 2304, 2305, 2306, 2307, 2308, 2309, 2310, 2311, 2312, 2313, 2314, 2315, 2316, 2317, 2318, 2319, 2320, 2321, 2322, 2323, 2324, 2325, 2326, 2327, 2328, 2329, 2330, 2331, 2332, 2333, 2334, 2335, 2336, 2337, 2338, 2339, 2340, 2341, 2342, 2343, 2344, 2345, 2346, 2347, 2348, 2349, 2350, 2351, 2352, 2353, 2354, 2355, 2356, 2357, 2358, 2359, 2360, 2361, 2362, 2363, 2364, 2365, 2366, 2367, 2368, 2369, 2370, 2371, 2372, 2373, 2374, 2375, 2376, 2377, 2378, 2379, 2380, 2381, 2382, 2383, 2384, 2385, 2386, 2387, 2388, 2389, 2390, 2391, 2392, 2393, 2394, 2395, 2396, 2397, 2398, 2399, 2400, 2401, 2402, 2403, 2404, 2405, 2406, 2407, 2408, 2409, 2410, 2411, 2412, 2413, 2414, 2415, 2416, 2417, 2418, 2419, 2420, 2421, 2422, 2423, 2424, 2425, 2426, 2427, 2428, 2429, 2430, 2431, 2432, 2433, 2434, 2435, 2436, 2437, 2438, 2439, 2440, 2441, 2442, 2443, 2444, 2445, 2446, 2447, 2448, 2449, 2450, 2451, 2452, 2453, 2454, 2455, 2456, 2457, 2458, 2459, 2460, 2461, 2462, 2463, 2464, 2465, 2466, 2467, 2468, 2469, 2470, 2471, 2472, 2473, 2474, 2475, 2476, 2477, 2478, 2479, 2480, 2481, 2482, 2483, 2484, 2485, 2486, 2487, 2488, 2489, 2490, 2491, 2492, 2493, 2494, 2495, 2496, 2497, 2498, 2499, 2500, 2501, 2502, 2503, 2504, 2505, 2506, 2507, 2508, 2509, 2510, 2511, 2512, 2513, 2514, 2515, 2516, 2517, 2518, 2519, 2520, 2521, 2522, 2523, 2524, 2525, 2526, 2527, 2528, 2529, 2530, 2531, 2532, 2533, 2534, 2535, 2536, 2537, 2538, 2539, 2540, 2541, 2542, 2543, 2544, 2545, 2546, 2547, 2548, 2549, 2550, 2551, 2552, 2553, 2554, 2555, 2556, 2557, 2558, 2559, 2560, 2561, 2562, 2563, 2564, 2565, 2566, 2567, 2568, 2569, 2570, 2571, 2572, 2573, 2574, 2575, 2576, 2577, 2578, 2579, 2580, 2581, 2582, 2583, 2584, 2585, 2586, 2587, 2588, 2589, 2590, 2591, 2592, 2593, 2594, 2595, 2596, 2597, 2598, 2599, 2600, 2601, 2602, 2603, 2604, 2605, 2606, 2607, 2608, 2609, 2610, 2611, 2612, 2613, 2614, 2615, 2616, 2617, 2618, 2619, 2620, 2621, 2622, 2623, 2624, 2625, 2626, 2627, 2628, 2629, 2630, 2631, 2632, 2633, 2634, 2635, 2636, 2637, 2638, 2639, 2640, 2641, 2642, 2643, 2644, 2645, 2646, 2647, 2648, 2649, 2650, 2651, 2652, 2653, 2654, 2655, 2656, 2657, 2658, 2659, 2660, 2661, 2662, 2663, 2664, 2665, 2666, 2667, 2668, 2669, 2670, 2671, 2672, 2673, 2674, 2675, 2676, 2677, 2678, 2679, 26

GENERAL CONDITIONS

1. The due observance and fulfilment of the terms of this Policy in so far as they relate to anything to be done or complied with by the Insured and the truth of the statements and answers in the questionnaire and proposal made by the Insured shall be a condition precedent to any liability of the Company.
2. The Schedule and the Section(s) shall be deemed to be incorporated in and form part of this Policy and the expression "this Policy" wherever used in this contract shall be read as including the Schedule and the Section(s). Any word or expression to which a specific meaning has been attached in any part of this Policy or of the Schedule or of the Section(s) shall bear such meaning wherever it may appear.
3. The Insured shall at his own expense take all reasonable precautions and comply with all reasonable recommendations of the Company to prevent loss, damage or liability and comply with statutory requirements and manufacturers' recommendations.
4. (a) Representatives of the Company shall at any reasonable time have the right to inspect and examine the risk and the Insured shall provide the representatives of the Company with all details and information necessary for the assessment of the risk.
(b) The Insured shall immediately notify the Company by Telegram and in writing of any material change in the risk and cause at his own expense such additional precautions to be taken as circumstances may require and the scope of cover and/or premium shall, if necessary, be adjusted accordingly.
No material alteration shall be made or admitted by the Insured whereby the risk is increased unless the continuance of the insurance be confirmed in writing by the Company.
5. In the event of any occurrence which might give rise to a claim under this Policy, the Insured shall :
(a) immediately notify the Company by Telephone or Telegram as well as in writing giving an indication as to the nature and extent of loss or damage ;
(b) take all steps within his power to minimise the extent of the loss or damage ;
(c) preserve the parts affected and make them available for inspection by a representative or surveyor deputed by the Company ;
(d) furnish all such information and documentary evidence as the Company may require ;
(e) inform the police authorities in case of or damage due to theft or burglary ;
The Company shall not in any case be liable for loss, damage or liability of which no notice has been received by the Company within 14 days of its occurrence.
Upon notification being given to the Company under this condition the Insured may carry out the repair or replacement of any minor damage not exceeding Rs. 2,500/-. In all other cases a representative of the Company shall have the opportunity of inspecting the loss or damage before any repairs or alterations are effected. If a representative of the Company does not carry out the inspection within a period of time which could be considered as adequate under the circumstances the Insured is entitled to proceed with the repairs or replacement.
The liability of the Company under this Policy in respect of any item sustaining damage shall cease if said item is not repaired properly without delay.
6. The Insured shall at the expense of the Company do and concur in doing and permit to be done all such acts and things as may be necessary or required by the Company in the interest of any rights or remedies or of obtaining relief or indemnity from parties (other than those insured under this policy) to which Company shall be or would become entitled or subrogated upon their paying for making good any loss or damage under this Policy whether such acts and things shall be or become necessary or required before or after the Insured's indemnification by the Company.
7. If any dispute or difference shall arise as to the quantum to be paid under the Policy (liability being otherwise admitted) such difference shall independently of all other questions be referred to the decision of a sole arbitrator to be appointed in writing by the parties to or if they cannot agree upon a single arbitrator within 30 days of any party invoking arbitration the same shall be referred to a panel of three arbitrators, comprising of two arbitrators one to be appointed by each of the parties to the dispute/difference and the third arbitrator to be appointed by such two arbitrators and arbitration shall be conducted under and in accordance with the provisions of the Arbitration and Conciliation Act, 1996
It is clearly agreed and understood that no difference or dispute shall be referable to arbitration as herein before provided, if the Company has disputed or not accepted liability under or in respect of this policy.
It is hereby expressly stipulated and declared that it shall be a condition precedent to any right of action or suit upon this policy that award by such arbitrator/arbitrators of the amount of the loss or damage shall be first obtained.
8. If a claim is in any respect fraudulent, or if any false declaration is made or used in support thereof, or if any fraudulent means or devices are used by the Insured or anyone acting on his behalf to obtain any benefit under this Policy, or if a claim is made and rejected and no action or suit is commenced within three months after such rejection or, in case of arbitration taking place as provided therein, within three months after the Arbitrator or Arbitrators or Umpire have made their award, all benefits under this Policy shall be forfeited.
9. If at the time of any claim arises under this Policy there be any other insurance covering the same loss, damage or liability, the Company shall not be liable to pay or contribute more than their rateable proportion of any claim for such loss, damage or liability.
10. This insurance may be terminated at any time at the request of the Insured ; in which case the Company will retain the premium calculated at the customary short period rate for the time the Policy has been in force. This insurance may also at any time be terminated at the option of the Company, on notice to that effect being given to the Insured, in which case the Company shall be liable to repay on demand a rateable proportion of the premium for the unexpired term from the date of the cancellation.

FORM-V

(See rule 15 (2))

FORM OF CERTIFICATE BY PRINCIPAL EMPLOYER.

Certified that I have engaged the applicant
.....ECI- NAYAK (JV).....as a contractor
establishment. I undertake to be bound by all the provisions of the Contract
(R. & A.) Act, 1970 and the Tripura Contract Labour (R & A.)
78, in so far as the Provisions are applicable to me in respect of the
employment of Contract labour by the applicant in my establishment.

Handwritten:
7-07-2015

Signature of the principal Employer.

Name and address of the Establishment.



ECI - NAYAK (JV)



Head Office
 1. Anshu Lokare
 Road No. 1, Sector 1
 705001
 Tel: 03474 255183 / 255184
 Fax: 03474 255185

Branch Office
 Swarnashanti Road
 P.O. - Jangra - 705047
 Dist. - Nalanda, Bihar
 Tel: 03474 255073 255185
 Fax: 03474 255189

6. ART/EN/0219/2016

Date: 09/03/2016

The Member Secretary

Regional Office, Nalanda, Bihar

Subject: Request for consent to establish a new and improve road for the

improved road.

1. The request for consent to establish and improvement of road is submitted by the member secretary, Nalanda, Bihar, for the road in the state of Bihar under P.W.D. (Govt) at Nalanda. We request you to consent to establish and consent to improve for W.M.A. plant and 11.0 m. Dia. for above said project and for this we are submitting herewith the No. 1 form no. 4284 d 4285. This is for recordal please.

Yours faithfully,

For the

ECI-NAYAK (JV)



TRIPURA STATE POLLUTION CONTROL BOARD

NOTIFICATION NO. 21/22

May 05, 2016

TO WHOM IT MAY CONCERN

By order of 16th April, 2016 by
Hon. Chief Executive Officer of WMM Plant & a Drum Mix
Unit, 101 Bapuk (IV), Palatana, Udalgur, Gomati
District. Consent to Establish Certificate (Fresh) is under
consideration.

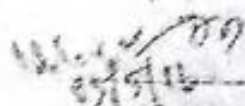
Hon. Min. Secy. (Env.)
Secretary

Accepted by Bank

CHALLAN
(To be filled in by the tenderer)

ORIGINAL

Amount of money to be paid	Amount: Rs. 200/-
Code of the commodity	DDO Code: 11073 Treasury Code: TPA11
Amount	200/- (Two hundred rupees only)

Signature of the Tenderer
Signature of the Tenderer
Navak Infrastructure Pvt Ltd
T R 01, 3/4/14/2

(To be filled in by the Department Officer)

to 38	Challan Date: 05/04/2016	Challan Id No - 265
Code: TPA11		DDO Code: 11073
Major Head	Sub-Major Head	Minor Head
0230	02	102

the Bank

Correct Received and paid receipt
Signature of the officer to whom the money is to be paid is
Signature
Labour Officer,
Udaipur District, Rajasthan
DDO Designation: Labour Officer, Udaipur District, Rajasthan

Official Seal

DDO Code: 11073

(For use in Bank)

payment for Rs. 200/- only
of Two hundred rupees only

Lead Cashier) (Accountant) (Branch Manager)

(For use of Treasury)

TV Date

Accountant)

(Treasury Officer)

by Labour Officer, Gomah District, Udaipur
on 06-Apr-2016 2:46 pm

ECI - NAYAK (JV)

Handwritten signature

1, Anshu Colours
Road No - 1, Jubilee Hills
500033
552983 / 23552984
5552680



Branch Office:
Swarupananda Road
P.O. Lumding - 782 447
Dist Nagon, Assam
Tel. 03674 - 263073/265181
Fax 03674 - 265189

AG.TL/EN/0350/2016

Date 31.08.2016

Gram Pradhan,
Palatana, Gomati District,
Tripura, India

Subject: -Request for No Objection Certificate (NOC).

Dear Sir,

We are executing the ADB road project "Improvement and Upgradation of road section of Udaipur to Melaghar (TR02) (Tranche-2 road in the state of Tripura)" under PWD, Govt. of Tripura. We need NOC for Consent to Establish and Consent to Operate for WMM plant, Hot Mix Plant and Batching plant for above said project at ch. 5+900 - RHS).

Therefore, it is requested to issue NOC in the interest of project work. This is for needful please.

Thanking you and assuring of our best services as always.

Yours faithfully

For ECI-NAYAK (JV)



Authorized Signatory

Received
Panchayat Secretary
Purba Palatana G.P.
Kakraban R. D. Block
Udaipur, Gomati, Tripura.

ORDER SLIP

①: 264707 / 265346

0381-2370111

NAYAK INFRASTRUCTURE PVT. LTD.

RLY. CONTRACTOR

LUMDING - 782447

Sl. No. AGTL -

3617

Date 21-6-16

To, _____

Particulars	Quantity
Name of Suppliers <u>10mm</u>	
From - <u>Udaipur Mathan ban</u> <u>STR</u>	
To - <u>ADB plant kakrabar</u>	
Measurement - <u>3.37 x 2.13 x 2.82</u>	<u>9.03</u>
Vehicle No. - <u>PR-03E-1759</u>	
Received material	
Site - <u>3.37 x 2.12 x 0.92</u>	<u>6.64</u>
Time of unloading -	
<u>Rajib Das</u> <u>6.35 PM</u> <u>21-6-16</u>	
Issued by <u>21/6/16</u>	Accountant/ Site Incharge

100F 25-42/R-TR/USD-15/1968-70 dt 09/06/11.



1397648

ফি.পা.নং

১ নং

TR 03E
1754

Udalguri বিভাগ

ফরম 'সি'

বনজ বস্তুর ট্রেনজিট পাথ

আশ বহির তালিক নং

আশ বহির তালিক নম্বর

তারিখ 2/10/6/11

M. Thun Khan

Nayan Infrastructure Pvt. Ltd.

Assam

বাই টাক, দেওয়া থাকে উত্তর পরিমাণ

Re-TR

বনজ বস্তুর প্রকার	পরিমাণ ও সংখ্যা	ওজন, মাত্রা/ভল	সেপারে বা অন্য চিহ্ন, এক মন্তব্য
Store (1000) - 18 (light green) (in)		Re-TR against Kallan M.	
3 (blue) Tropic		028 to 033, 037 to 040 dt	
Res Top - 6 (8/10) (in)		18/05/16 of Naruokas	
		Acct. (a char)	

সেপারে বা অন্য চিহ্ন

সেপারে বা অন্য চিহ্ন

নির্দিষ্ট পথ

ম্যান্ডেলে শেষ তারিখ

Material in Railway Station

Kalkal, an.

by Xagad.

upto 8 P.M on

2/10/16

স্বাক্ষর

স্থান/বিট

তারিখ

তারিখ

Udalguri M. বিভাগ

at about 10:10 AM

SHYAMAL E.

Bear Office P. 10.3

Udalguri Range

PO's DMR Camp order at Sanicherra lat- 30/11/15

বহিঃ 19454
ট্রেনজিট পাশ

TR-03-B
1603



ক্রি পাশ নং
972667

Dharmenagar বিভাগ
ফরম সি

ক্যাম্প বাহির ক্রমিক নং
ক্যাম্প বাহির ক্রমিক নম্বরের
তারিখ 16/1/16

Atiya Begum

বনজ বস্তুর ট্রেনজিট পাশ

নাম Samicherra পিতার নাম
ক্রি নং যদি ঢাকা দেওয়া থাকে উহার পরিমাণ Re-TP

বনজবস্তুর প্রকার	পরিমাণ ও সংখ্যা	ওজন, আয়তন	হেমার বা অন্য চিহ্ন এবং মন্তব্য
Broken stone chips	13 (Thirteen) cum		Re-TP issued again TP No-842667, at 28/7/14 of B.O Churnibansi.

সেবার হাটে পাও Sanicherra
সেবার বাইরে Palulana
নির্দিষ্ট পথ By Road
মাসের শেষ তারিখ 17/01/2016

স্বাক্ষর
স্থান/বিট
তারিখ
তারিখ

16/1/16
Jhumur Chandra, F
B.O Sanicherra
Dharmenagar, Tripura