

Resettlement Plan

25 July 2019

PAK: Hydropower Development Investment Project

Appendix E

Prepared by Pakhtunkhwa Energy Development Organization (PEDO), with support from Hagler Bailly Pakistan for the Asian Development Bank.

This resettlement plan is a document of the borrower. The views expressed herein do not necessarily represent those of ADB's Board of Directors, Management, or staff, and may be preliminary in nature. Your attention is directed to the "terms of use" section of this website.

In preparing any country program or strategy, financing any project, or by making any designation of or reference to a particular territory or geographic area in this document, the Asian Development Bank does not intend to make any judgments as to the legal or other status of any territory or area.

APPENDIX E: PHOTOGRAPHIC DOCUMENTATION OF AFFECTED STRUCTURES



1002 BHU, Public



1002 BHU, Public

Form titled "Affected Structures Survey" with handwritten entries. The form includes fields for: Date of Interview, Structure ID, Form No., and Address. The "Structure Information" section contains handwritten details: Name (Public), Location (BHU), and a sketch of a rectangular structure with dimensions 10m by 10m. The "Any Other Information" section contains handwritten notes: "Profile Sketch" and "Total Area 64.6m".

1002 BHU, Public



1009, House Private



1009

Form titled "Affected Structures Survey" with handwritten entries. The form includes fields for: Date of Interview, Structure ID, Form No., and Address. The "Structure Information" section contains handwritten details: Name (Private), Location (BHU), and a sketch of a rectangular structure with dimensions 10m by 10m. The "Any Other Information" section contains handwritten notes: "Profile Sketch" and "Total Area 64.6m".

1009



1011 House Private



1011

Form No. 1011

Affected Structures Survey

Investigator: Shahid Farid
 Village: Chak
 Longitude: 72.523333333333
 Latitude: 33.523333333333
 Head of Household: Shahid Farid
 Name: Shahid Farid
 Father's Name: Shahid Farid
 Form No.: 1011
 Date: 10/10/2011
 Structure: House
 Type: Private
 Ownership: Private
 Construction Type: Brick
 When Constructed? 2005

Any Other Information:

Hand-drawn diagram showing a rectangular structure with dimensions 10.5m and 6.5m. A note 'Ground 500' is written below the diagram.

1011



1012 House Private

Form No. 1012

Affected Structures Survey

Investigator: Shahid Farid
 Village: Chak
 Longitude: 72.523333333333
 Latitude: 33.523333333333
 Head of Household: Shahid Farid
 Name: Shahid Farid
 Father's Name: Shahid Farid
 Form No.: 1012
 Date: 10/10/2011
 Structure: House
 Type: Private
 Ownership: Private
 Construction Type: Brick
 When Constructed? 2005

Any Other Information:

Hand-drawn diagram showing a rectangular structure with dimensions 10.5m and 6.5m.

1012



1015 House Private

Form No. 1015

Affected Structures Survey

Investigator: Shahid Farid
 Village: Chak
 Longitude: 72.523333333333
 Latitude: 33.523333333333
 Head of Household: Shahid Farid
 Name: Shahid Farid
 Father's Name: Shahid Farid
 Form No.: 1015
 Date: 10/10/2011
 Structure: House
 Type: Private
 Ownership: Private
 Construction Type: Brick
 When Constructed? 2005

Any Other Information:

Hand-drawn diagram showing a rectangular structure with dimensions 10.5m and 6.5m.

1015 House Private



1013 House Private



1013 House Private

[illegible]

1013



1016 House Private



1016 House Private

[illegible]

1016



1017 House Private

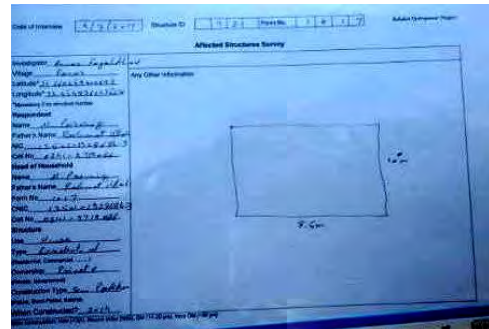

1017 House Private



1014 House Private



1014 House Private

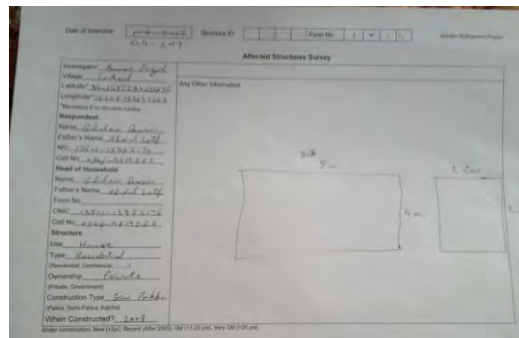

1014 House Private



1018 House Private



1018 House Private

*Land Acquisition and Resettlement Plan of
Hydropower Development Investment Project*



1018 House Private

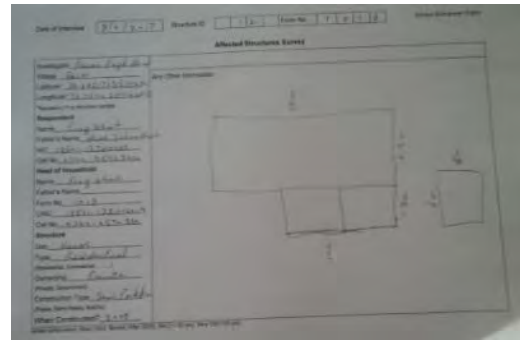

1018 House Private



1020 House Private



1020 House Private



1020 House Private

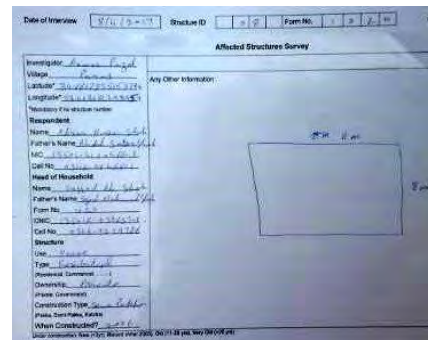

1020 House Private



1025 House Private



1025

*Land Acquisition and Resettlement Plan of
Hydropower Development Investment Project*

[illegible]

1025



1024 House Private



1024

[illegible]

1024



1023 House Private



1023



1023 House Private

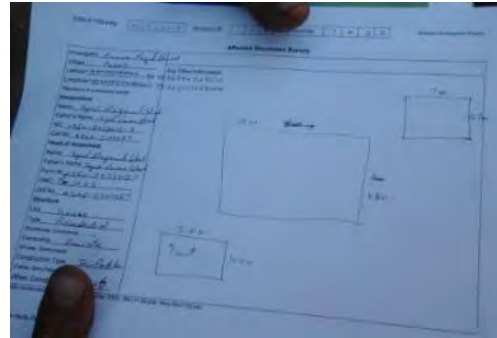

1023



1026 House Private



1026

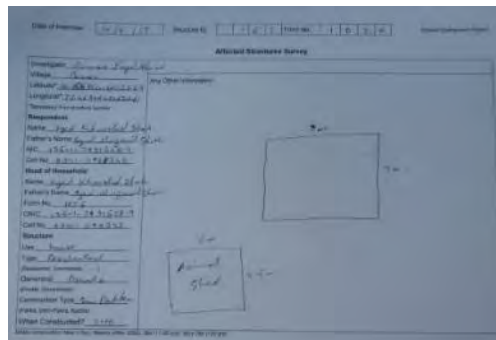

1026



1027 House Private

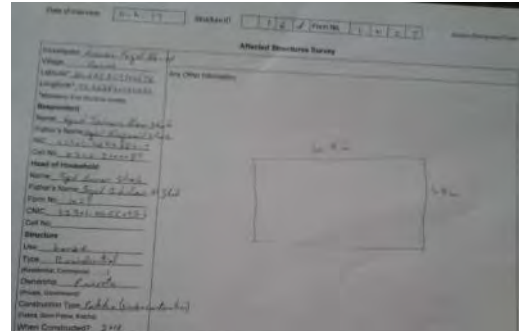

1027

Land Acquisition and Resettlement Plan of
Hydropower Development Investment Project



1028 House Private

1028



1029 House Private

1029



1030 House Private

1030



1031 House Private

1031



1032 House Private

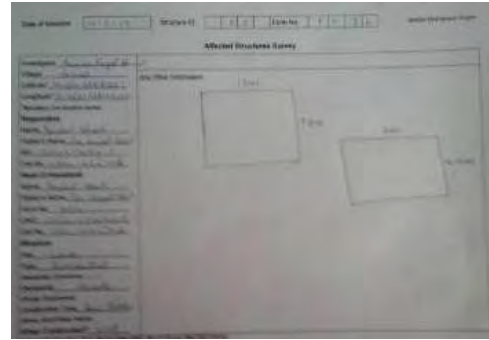

1032



1033 House Private



1033

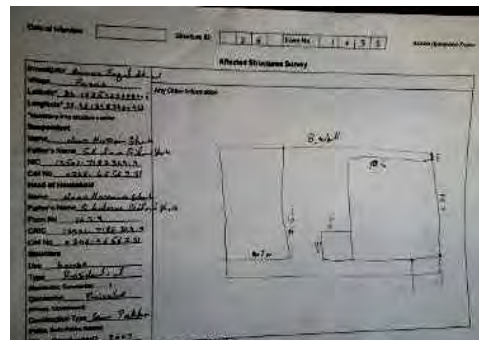

1033 House Private



1034 House Private

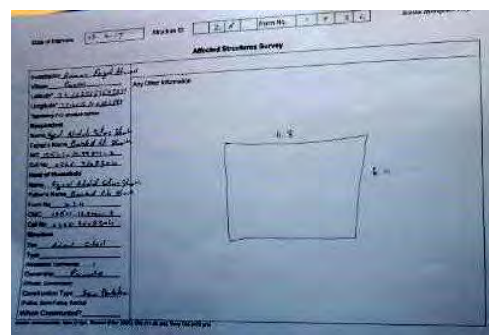

1034



1036 House Private



1036

Date of Interview: 17-05-17 Structure ID: 1036 Form No: 1036-17-01

Investigator: Vagish Prasad
Village: Dharu
Latitude: 33.442222 Longitude: 73.442222
Any Other Information:
Respondent:
Name: Vagish Prasad
Father's Name: Vagish Prasad
NIC: 3344222222
Call No: 9999999999
Head of Household:
Name: Vagish Prasad
Father's Name: Vagish Prasad
Form No: 1036-17-01
CNC: 3344222222
Cell No: 9999999999
Structure:
Use: Residential
Type: Residential
Ownership: Private
Construction Type: Stone
When Constructed: 2010
When Constructed: 2010

Any Other Information:
1036

1036



1037 House Private

Date of Interview: 17-05-17 Structure ID: 1037 Form No: 1037-17-01

Investigator: Vagish Prasad
Village: Dharu
Latitude: 33.442222 Longitude: 73.442222
Any Other Information:
Respondent:
Name: Vagish Prasad
Father's Name: Vagish Prasad
NIC: 3344222222
Call No: 9999999999
Head of Household:
Name: Vagish Prasad
Father's Name: Vagish Prasad
Form No: 1037-17-01
CNC: 3344222222
Cell No: 9999999999
Structure:
Use: Residential
Type: Residential
Ownership: Private
Construction Type: Stone
When Constructed: 2010
When Constructed: 2010

Any Other Information:
1037

1037



3007 House Private

Date of Interview: 17-05-17 Structure ID: 3007 Form No: 3007-17-01

Investigator: Vagish Prasad
Village: Dharu
Latitude: 33.442222 Longitude: 73.442222
Any Other Information:
Respondent:
Name: Vagish Prasad
Father's Name: Vagish Prasad
NIC: 3344222222
Call No: 9999999999
Head of Household:
Name: Vagish Prasad
Father's Name: Vagish Prasad
Form No: 3007-17-01
CNC: 3344222222
Cell No: 9999999999
Structure:
Use: Residential
Type: Residential
Ownership: Private
Construction Type: Stone
When Constructed: 2010
When Constructed: 2010

Any Other Information:
3007

3007



3056 House Private

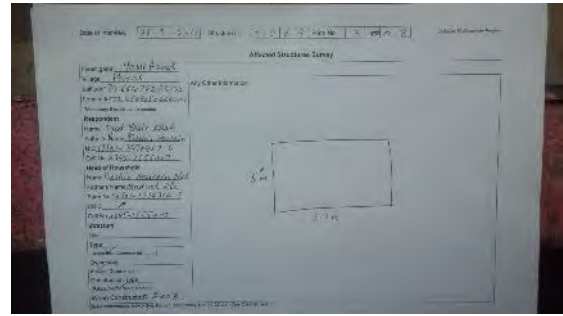

3056



3008 House Private



3008 House Private



3008

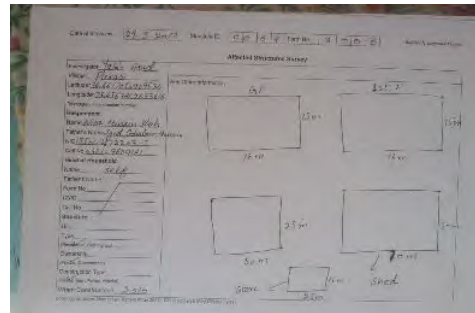

3008



3009 House Private



3009

[illegible]

3009 House Private



1010 House Private

[illegible]

1010



3010 House Private



3010

[illegible]

3010



3011 House Private



3011

Date of Interview: 20-1-2019 Interviewer: [Name] Interviewee: [Name] Village: [Name] District: [Name] Division: [Name] Block: [Name] Union: [Name] Tehsil: [Name] District: [Name] Province: [Name] Country: [Name]

Household Information:

Name: [Name] Father's Name: [Name] Head of Household: [Name] Date: [Date] Status: [Status] Use: [Use] Type: [Type] Structure: [Structure] Material: [Material] Construction: [Construction] Ownership: [Ownership] Possession: [Possession] Other Information: [Other Information]

Affected Structures Survey:

Any Other Structure:

Structure 1: [Dimensions] Structure 2: [Dimensions]

3011 House Private



3012 House Private



3012

Date of Interview: 20-1-2019 Interviewer: [Name] Interviewee: [Name] Village: [Name] District: [Name] Division: [Name] Block: [Name] Union: [Name] Tehsil: [Name] District: [Name] Province: [Name] Country: [Name]

Household Information:

Name: [Name] Father's Name: [Name] Head of Household: [Name] Date: [Date] Status: [Status] Use: [Use] Type: [Type] Structure: [Structure] Material: [Material] Construction: [Construction] Ownership: [Ownership] Possession: [Possession] Other Information: [Other Information]

Affected Structures Survey:

Any Other Structure:

Structure 1: [Dimensions] Structure 2: [Dimensions]

3012



3013 House Private

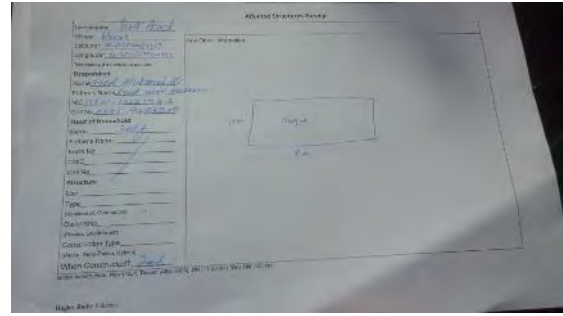

3013



3014 School Public



3014

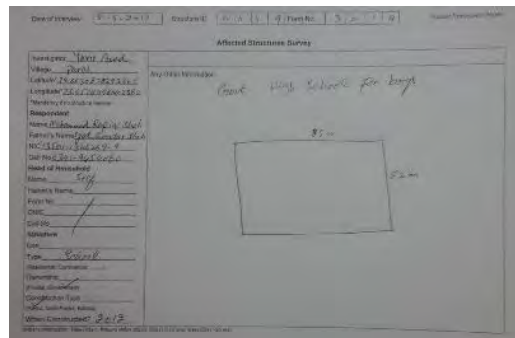

3014



3015 House Private



3015

*Land Acquisition and Resettlement Plan of
Hydropower Development Investment Project*

[illegible]

3015



2016 House Private



2016

[illegible]

2016



3017 House Private

[illegible]

3017



3018 House Private

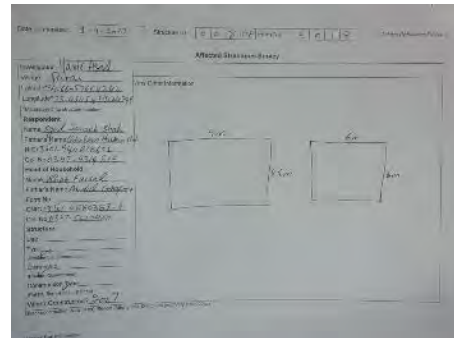

3018



3019 House Private



3019

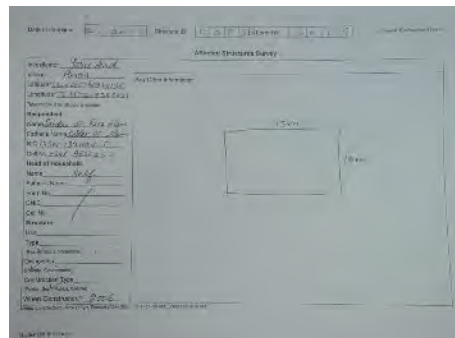

3019



3020 House Private

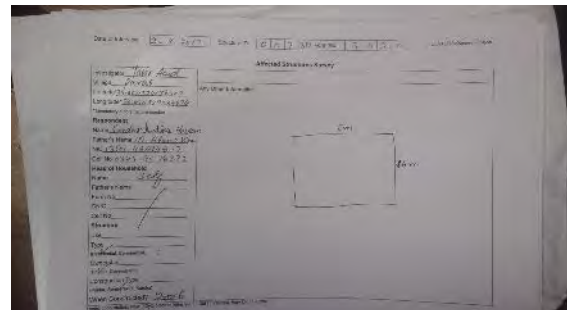

3020



3021



3021 House Private

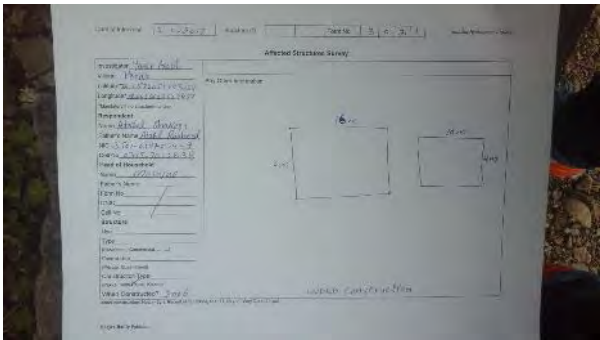

3021



3022 House Private

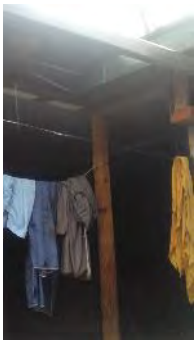

3022

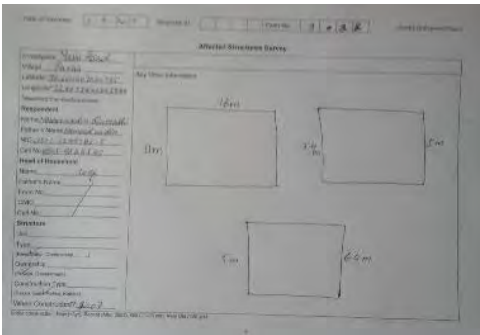

3022



1017 House Private



1017

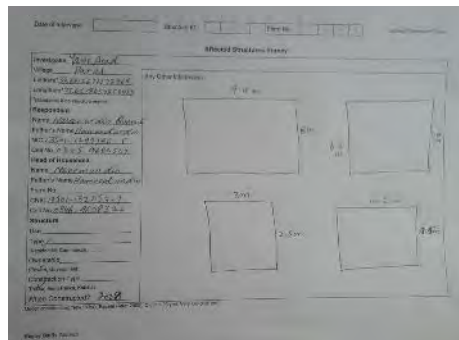

1017



3024 House Private



3024

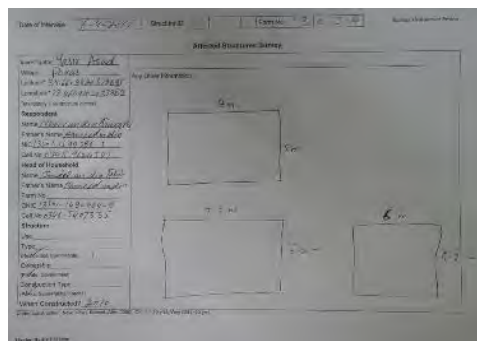

3024



3025 House Private



3025

Survey Form for 3025 House Private. The form includes a title 'Allotted Dimensions Survey', a date '10/10/2019', and a location '3025 House Private'. It contains a table with columns for 'House No.', 'House Name', 'House Address', 'House Type', 'House Size', 'House Age', 'House Condition', 'House Status', 'House Owner', 'House Contact', 'House Remarks', and 'House Signature'. The form is filled out with handwritten information, including the house name '3025 House Private' and the owner's name '3025 House Private'. A sketch of the house is drawn on the right side of the form.

3025



3026 House Private



3026

Survey Form for 3026 House Private. The form includes a title 'Allotted Dimensions Survey', a date '10/10/2019', and a location '3026 House Private'. It contains a table with columns for 'House No.', 'House Name', 'House Address', 'House Type', 'House Size', 'House Age', 'House Condition', 'House Status', 'House Owner', 'House Contact', 'House Remarks', and 'House Signature'. The form is filled out with handwritten information, including the house name '3026 House Private' and the owner's name '3026 House Private'. A sketch of the house is drawn on the right side of the form.

3026



3027 House Private



3027



3027



3027 House Private

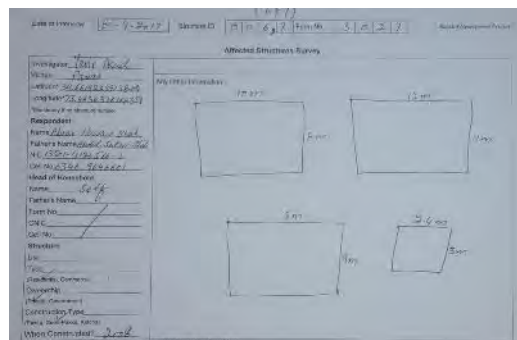

3027



3028 House Private



3028



3028 House Private

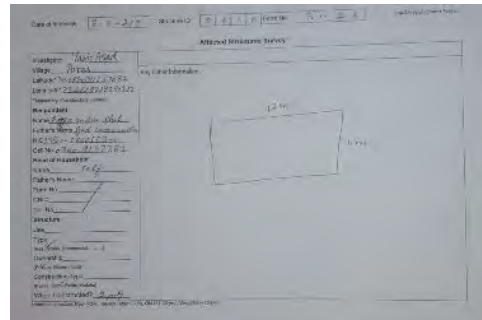

3028



3029 House Private



3029

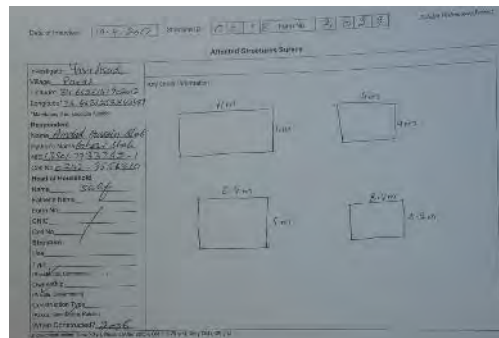

3029



3030 House Private



3030

[illegible]

3030



3031 House Private



3031

[illegible]

3031



3032 House Private



3032

*Land Acquisition and Resettlement Plan of
Hydropower Development Investment Project*



3032 House Private



3032



3032

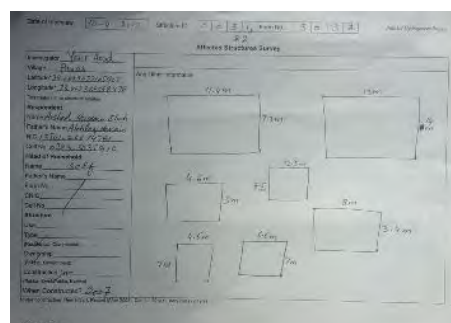

3032



3033 House Private

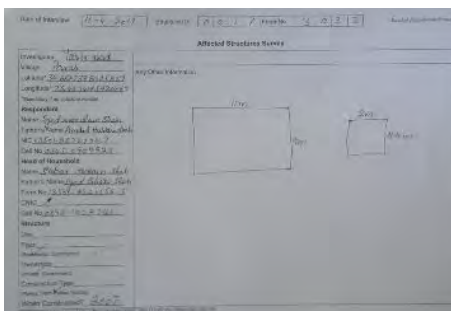

3033



3034 House Private



3034

3035

3035



3036

*Land Acquisition and Resettlement Plan of
Hydropower Development Investment Project*

[illegible]

3036



3027 House Private



3027



3027 House Private

[illegible]

3027



3038 House Private



3038

[illegible]

3038



3039 House Private

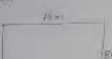

3039

Date of Interview: <u>Feb 06</u> City: <u>London</u> Location: <u>London, England</u> Length of Interview: <u>1.22 hrs</u> Number of interviewers: <u>2</u> Recorder(s): Name: <u>Shaneel</u> Father's Name: <u>David Lee</u> MR: <u>020-7380-0645</u> Cell No: <u>0200 9888953</u> Email Address: Name: <u>Shaneel</u> Father's Name: Email No: Cell No: Address: City: <u>London</u> Type: <u>house</u> Number: <u>100</u> Occupancy: (How many people) Construction Type: Floor: <u>single floor</u> When Constructed: <u>2000</u>	Project Structure Survey Area: Kitchen 
--	--

3039



3040 House Private



3040

*Land Acquisition and Resettlement Plan of
Hydropower Development Investment Project*

Date of Issue of 17. 4. 2017	Serial No. 100	Volume 01	Page 01	Number of Pages 01
Attached Serialisation Survey				
Inspector 1. SAT. Arora	Any Other Remarks			
Station POWRI				
Address 134, 135, 136, 137, 138, 139, 140, 141, 142, 143, 144, 145, 146, 147, 148, 149, 150, 151, 152, 153, 154, 155, 156, 157, 158, 159, 160, 161, 162, 163, 164, 165, 166, 167, 168, 169, 170, 171, 172, 173, 174, 175, 176, 177, 178, 179, 180, 181, 182, 183, 184, 185, 186, 187, 188, 189, 190, 191, 192, 193, 194, 195, 196, 197, 198, 199, 200, 201, 202, 203, 204, 205, 206, 207, 208, 209, 210, 211, 212, 213, 214, 215, 216, 217, 218, 219, 220, 221, 222, 223, 224, 225, 226, 227, 228, 229, 230, 231, 232, 233, 234, 235, 236, 237, 238, 239, 240, 241, 242, 243, 244, 245, 246, 247, 248, 249, 250, 251, 252, 253, 254, 255, 256, 257, 258, 259, 260, 261, 262, 263, 264, 265, 266, 267, 268, 269, 270, 271, 272, 273, 274, 275, 276, 277, 278, 279, 280, 281, 282, 283, 284, 285, 286, 287, 288, 289, 290, 291, 292, 293, 294, 295, 296, 297, 298, 299, 300, 301, 302, 303, 304, 305, 306, 307, 308, 309, 310, 311, 312, 313, 314, 315, 316, 317, 318, 319, 320, 321, 322, 323, 324, 325, 326, 327, 328, 329, 330, 331, 332, 333, 334, 335, 336, 337, 338, 339, 340, 341, 342, 343, 344, 345, 346, 347, 348, 349, 350, 351, 352, 353, 354, 355, 356, 357, 358, 359, 360, 361, 362, 363, 364, 365, 366, 367, 368, 369, 370, 371, 372, 373, 374, 375, 376, 377, 378, 379, 380, 381, 382, 383, 384, 385, 386, 387, 388, 389, 390, 391, 392, 393, 394, 395, 396, 397, 398, 399, 400, 401, 402, 403, 404, 405, 406, 407, 408, 409, 410, 411, 412, 413, 414, 415, 416, 417, 418, 419, 420, 421, 422, 423, 424, 425, 426, 427, 428, 429, 430, 431, 432, 433, 434, 435, 436, 437, 438, 439, 440, 441, 442, 443, 444, 445, 446, 447, 448, 449, 450, 451, 452, 453, 454, 455, 456, 457, 458, 459, 460, 461, 462, 463, 464, 465, 466, 467, 468, 469, 470, 471, 472, 473, 474, 475, 476, 477, 478, 479, 480, 481, 482, 483, 484, 485, 486, 487, 488, 489, 490, 491, 492, 493, 494, 495, 496, 497, 498, 499, 500, 501, 502, 503, 504, 505, 506, 507, 508, 509, 510, 511, 512, 513, 514, 515, 516, 517, 518, 519, 520, 521, 522, 523, 524, 525, 526, 527, 528, 529, 530, 531, 532, 533, 534, 535, 536, 537, 538, 539, 540, 541, 542, 543, 544, 545, 546, 547, 548, 549, 550, 551, 552, 553, 554, 555, 556, 557, 558, 559, 560, 561, 562, 563, 564, 565, 566, 567, 568, 569, 570, 571, 572, 573, 574, 575, 576, 577, 578, 579, 580, 581, 582, 583, 584, 585, 586, 587, 588, 589, 590, 591, 592, 593, 594, 595, 596, 597, 598, 599, 600, 601, 602, 603, 604, 605, 606, 607, 608, 609, 610, 611, 612, 613, 614, 615, 616, 617, 618, 619, 620, 621, 622, 623, 624, 625, 626, 627, 628, 629, 630, 631, 632, 633, 634, 635, 636, 637, 638, 639, 640, 641, 642, 643, 644, 645, 646, 647, 648, 649, 650, 651, 652, 653, 654, 655, 656, 657, 658, 659, 660, 661, 662, 663, 664, 665, 666, 667, 668, 669, 670, 671, 672, 673, 674, 675, 676, 677, 678, 679, 680, 681, 682, 683, 684, 685, 686, 687, 688, 689, 690, 691, 692, 693, 694, 695, 696, 697, 698, 699, 700, 701, 702, 703, 704, 705, 706, 707, 708, 709, 710, 711, 712, 713, 714, 715, 716, 717, 718, 719, 720, 721, 722, 723, 724, 725, 726, 727, 728, 729, 730, 731, 732, 733, 734, 735, 736, 737, 738, 739, 740, 741, 742, 743, 744, 745, 746, 747, 748, 749, 750, 751, 752, 753, 754, 755, 756, 757, 758, 759, 760, 761, 762, 763, 764, 765, 766, 767, 768, 769, 770, 771, 772, 773, 774, 775, 776, 777, 778, 779, 780, 781, 782, 783, 784, 785, 786, 787, 788, 789, 790, 791, 792, 793, 794, 795, 796, 797, 798, 799, 800, 801, 802, 803, 804, 805, 806, 807, 808, 809, 810, 811, 812, 813, 814, 815, 816, 817, 818, 819, 820, 821, 822, 823, 824, 825, 826, 827, 828, 829, 830, 831, 832, 833, 834, 835, 836, 837, 838, 839, 840, 841, 842, 843, 844, 845, 846, 847, 848, 849, 850, 851, 852, 853, 854, 855, 856, 857, 858, 859, 860, 861, 862, 863, 864, 865, 866, 867, 868, 869, 870, 871, 872, 873, 874, 875, 876, 877, 878, 879, 880, 881, 882, 883, 884, 885, 886, 887, 888, 889, 890, 891, 892, 893, 894, 895, 896, 897,				

3040



3041 House Private



3041



3041 House Private

[illegible]

3041



3042 House Private

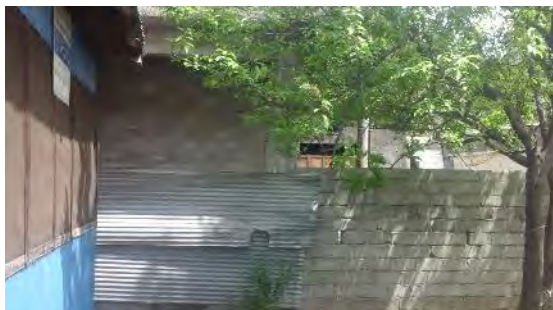

3042

[illegible]

Table of Contents: 1.1-1.2, 1.3-1.4, 1.5-1.6, 1.7-1.8, 1.9-1.10, 1.11-1.12, 1.13-1.14, 1.15-1.16, 1.17-1.18, 1.19-1.20, 1.21-1.22, 1.23-1.24, 1.25-1.26, 1.27-1.28, 1.29-1.30, 1.31-1.32, 1.33-1.34, 1.35-1.36, 1.37-1.38, 1.39-1.40, 1.41-1.42, 1.43-1.44, 1.45-1.46, 1.47-1.48, 1.49-1.50, 1.51-1.52, 1.53-1.54, 1.55-1.56, 1.57-1.58, 1.59-1.60, 1.61-1.62, 1.63-1.64, 1.65-1.66, 1.67-1.68, 1.69-1.70, 1.71-1.72, 1.73-1.74, 1.75-1.76, 1.77-1.78, 1.79-1.80, 1.81-1.82, 1.83-1.84, 1.85-1.86, 1.87-1.88, 1.89-1.90, 1.91-1.92, 1.93-1.94, 1.95-1.96, 1.97-1.98, 1.99-2.00, 2.01-2.02, 2.03-2.04, 2.05-2.06, 2.07-2.08, 2.09-2.10, 2.11-2.12, 2.13-2.14, 2.15-2.16, 2.17-2.18, 2.19-2.20, 2.21-2.22, 2.23-2.24, 2.25-2.26, 2.27-2.28, 2.29-2.30, 2.31-2.32, 2.33-2.34, 2.35-2.36, 2.37-2.38, 2.39-2.40, 2.41-2.42, 2.43-2.44, 2.45-2.46, 2.47-2.48, 2.49-2.50, 2.51-2.52, 2.53-2.54, 2.55-2.56, 2.57-2.58, 2.59-2.60, 2.61-2.62, 2.63-2.64, 2.65-2.66, 2.67-2.68, 2.69-2.70, 2.71-2.72, 2.73-2.74, 2.75-2.76, 2.77-2.78, 2.79-2.80, 2.81-2.82, 2.83-2.84, 2.85-2.86, 2.87-2.88, 2.89-2.90, 2.91-2.92, 2.93-2.94, 2.95-2.96, 2.97-2.98, 2.99-3.00, 3.01-3.02, 3.03-3.04, 3.05-3.06, 3.07-3.08, 3.09-3.10, 3.11-3.12, 3.13-3.14, 3.15-3.16, 3.17-3.18, 3.19-3.20, 3.21-3.22, 3.23-3.24, 3.25-3.26, 3.27-3.28, 3.29-3.30, 3.31-3.32, 3.33-3.34, 3.35-3.36, 3.37-3.38, 3.39-3.40, 3.41-3.42, 3.43-3.44, 3.45-3.46, 3.47-3.48, 3.49-3.50, 3.51-3.52, 3.53-3.54, 3.55-3.56, 3.57-3.58, 3.59-3.60, 3.61-3.62, 3.63-3.64, 3.65-3.66, 3.67-3.68, 3.69-3.70, 3.71-3.72, 3.73-3.74, 3.75-3.76, 3.77-3.78, 3.79-3.80, 3.81-3.82, 3.83-3.84, 3.85-3.86, 3.87-3.88, 3.89-3.90, 3.91-3.92, 3.93-3.94, 3.95-3.96, 3.97-3.98, 3.99-4.00, 4.01-4.02, 4.03-4.04, 4.05-4.06, 4.07-4.08, 4.09-4.10, 4.11-4.12, 4.13-4.14, 4.15-4.16, 4.17-4.18, 4.19-4.20, 4.21-4.22, 4.23-4.24, 4.25-4.26, 4.27-4.28, 4.29-4.30, 4.31-4.32, 4.33-4.34, 4.35-4.36, 4.37-4.38, 4.39-4.40, 4.41-4.42, 4.43-4.44, 4.45-4.46, 4.47-4.48, 4.49-4.50, 4.51-4.52, 4.53-4.54, 4.55-4.56, 4.57-4.58, 4.59-4.60, 4.61-4.62, 4.63-4.64, 4.65-4.66, 4.67-4.68, 4.69-4.70, 4.71-4.72, 4.73-4.74, 4.75-4.76, 4.77-4.78, 4.79-4.80, 4.81-4.82, 4.83-4.84, 4.85-4.86, 4.87-4.88, 4.89-4.90, 4.91-4.92, 4.93-4.94, 4.95-4.96, 4.97-4.98, 4.99-5.00, 5.01-5.02, 5.03-5.04, 5.05-5.06, 5.07-5.08, 5.09-5.10, 5.11-5.12, 5.13-5.14, 5.15-5.16, 5.17-5.18, 5.19-5.20, 5.21-5.22, 5.23-5.24, 5.25-5.26, 5.27-5.28, 5.29-5.30, 5.31-5.32, 5.33-5.34, 5.35-5.36, 5.37-5.38, 5.39-5.40, 5.41-5.42, 5.43-5.44, 5.45-5.46, 5.47-5.48, 5.49-5.50, 5.51-5.52, 5.53-5.54, 5.55-5.56, 5.57-5.58, 5.59-5.60, 5.61-5.62, 5.63-5.64, 5.65-5.66, 5.67-5.68, 5.69-5.70, 5.71-5.72, 5.73-5.74, 5.75-5.76, 5.77-5.78, 5.79-5.80, 5.81-5.82, 5.83-5.84, 5.85-5.86, 5.87-5.88, 5.89-5.90, 5.91-5.92, 5.93-5.94, 5.95-5.96, 5.97-5.98, 5.99-6.00, 6.01-6.02, 6.03-6.04, 6.05-6.06, 6.07-6.08, 6.09-6.10, 6.11-6.12, 6.13-6.14, 6.15-6.16, 6.17-6.18, 6.19-6.20, 6.21-6.22, 6.23-6.24, 6.25-6.26, 6.27-6.28, 6.29-6.30, 6.31-6.32, 6.33-6.34, 6.35-6.36, 6.37-6.38, 6.39-6.40, 6.41-6.42, 6.43-6.44, 6.45-6.46, 6.47-6.48, 6.49-6.50, 6.51-6.52, 6.53-6.54, 6.55-6.56, 6.57-6.58, 6.59-6.60, 6.61-6.62, 6.63-6.64, 6.65-6.66, 6.67-6.68, 6.69-6.70, 6.71-6.72, 6.73-6.74, 6.75-6.76, 6.77-6.78, 6.79-6.80, 6.81-6.82, 6.83-6.84, 6.85-6.86, 6.87-6.88, 6.89-6.90, 6.91-6.92, 6.93-6.94, 6.95-6.96, 6.97-6.98, 6.99-7.00, 7.01-7.02, 7.03-7.04, 7.05-7.06, 7.07-7.08, 7.09-7.10, 7.11-7.12, 7.13-7.14, 7.15-7.16, 7.17-7.18, 7.19-7.20, 7.21-7.22, 7.23-7.24, 7.25-7.26, 7.27-7.28, 7.29-7.30, 7.31-7.32, 7.33-7.34, 7.35-7.36, 7.37-7.38, 7.39-7.40, 7.41-7.42, 7.43-7.44, 7.45-7.46, 7.47-7.48, 7.49-7.50, 7.51-7.52, 7.53-7.54, 7.55-7.56, 7.57-7.58, 7.59-7.60, 7.61-7.62, 7.63-7.64, 7.65-7.66, 7.67-7.68, 7.69-7.70, 7.71-7.72, 7.73-7.74, 7.75-7.76, 7.77-7.78, 7.79-7.80, 7.81-7.82, 7.83-7.84, 7.85-7.86, 7.87-7.88, 7.89-7.90, 7.91-7.92, 7.93-7.94, 7.95-7.96, 7.97-7.98, 7.99-8.00, 8.01-8.02, 8.03-8.04, 8.05-8.06, 8.07-8.08, 8.09-8.10, 8.11-8.12, 8.13-8.14, 8.15-8.16, 8.17-8.18, 8.19-8.20, 8.21-8.22, 8.23-8.24, 8.25-8.26, 8.27-8.28, 8.29-8.30, 8.31-8.32, 8.33-8.34, 8.35-8.36, 8.37-8.38, 8.39-8.40, 8.41-8.42, 8.43-8.44, 8.45-8.46, 8.47-8.48, 8.49-8.50, 8.51-8.52, 8.53-8.54, 8.55-8.56, 8.57-8.58, 8.59-8.60, 8.61-8.62, 8.63-8.64, 8.65-8.66, 8.67-8.68, 8.69-8.70, 8.71-8.72, 8.73-8.74, 8.75-8.76, 8.77-8.78, 8.79-8.80, 8.81-8.82, 8.83-8.84, 8.85-8.86, 8.87-8.88, 8.89-8.90, 8.91-8.92, 8.93-8.94, 8.95-8.96, 8.97-8.98, 8.99-9.00, 9.01-9.02, 9.03-9.04, 9.05-9.06, 9.07-9.08, 9.09-9.10, 9.11-9.12, 9.13-9.14, 9.15-9.16, 9.17-9.18, 9.19-9.20, 9.21-9.22, 9.23-9.24, 9.25-9.26, 9.27-9.28, 9.29-9.30, 9.31-9.32, 9.33-9.34, 9.35-9.36, 9.37-9.38, 9.39-9.40, 9.41-9.42, 9.43-9.44, 9.45-9.46, 9.47-9.48, 9.49-9.50, 9.51-9.52, 9.53-9.54, 9.55-9.56, 9.57-9.58, 9.59-9.60, 9.61-9.62, 9.63-9.64, 9.65-9.66, 9.67-9.68, 9.69-9.70, 9.71-9.72, 9.73-9.74, 9.75-9.76, 9.77-9.78, 9.79-9.80, 9.81-9.82, 9.83-9.84, 9.85-9.86, 9.87-9.88, 9.89-9.90, 9.91-9.92, 9.93-9.94, 9.95-9.96, 9.97-9.98, 9.99-10.00, 10.01-10.02, 10.03-10.04, 10.05-10.06, 10.07-10.08, 10.09-10.10, 10.11-10.12, 10.13-10.14, 10.15-10.16, 10.17-10.18, 10.19-10.20, 10.21-10.22, 10.23-10.24, 10.25-10.26, 10.27-10.28, 10.29-10.30, 10.31-10.32, 10.33-10.34, 10.35-10.36, 10.37-10.38, 10.39-10.40, 10.41-10.42, 10.43-10.44, 10.45-10.46, 10.47-10.48, 10.49-10.50, 10.51-10.52, 10.53-10.54, 10.55-10.56, 10.57-10.58, 10.59-10.60, 10.61-10.62, 10.63-10.64, 10.65-10.66, 10.67-10.68, 10.69-10.70, 10.71-10.72, 10.73-10.74, 10.75-10.76, 10.77-10.78, 10.79-10.80, 10.81-10.82, 10.83-10.84, 10.85-10.86, 10.87-10.88, 10.89-10.90, 10.91-10.92, 10.93-10.94, 10.95-10.96, 10.97-10.98, 10.99-11.00, 11.01-11.02, 11.03-11.04, 11.05-11.06, 11.07-11.08, 11.09-11.10, 11.11-11.12, 11.13-11.14, 11.15-11.16, 11.17-11.18, 11.19-11.20, 11.21-11.22, 11.23-11.24, 11.25-11.26, 11.27-11.28, 11.29-11.30, 11.31-11.32, 11.33-11.34, 11.35-11.36, 11.37-11.38, 11.39-11.40, 11.41-11.42, 11.43-11.44, 11.45-11.46, 11.47-11.48, 11.49-11.50, 11.51-11.52, 11.53-11.54, 11.55-11.56, 11.57-11.58, 11.59-11.60, 11.61-11.62, 11.63-11.64, 11.65-11.66, 11.67-11.68, 11.69-11.70, 11.71-11.72, 11.73-11.74, 11.75-11.76, 11.77-11.78, 11.79-11.80, 11.81-11.82, 11.83-11.84, 11.85-11.86, 11.87-11.88, 11.89-11.90, 11.91-11.92, 11.93-11.94, 11.95-11.96, 11.97-11.98, 11.99-12.00, 12.01-12.02, 12.03-12.04, 12.05-12.06, 12.07-12.08, 12.09-12.10, 12.11-12.12, 12.13-12.14, 12.15-12.16, 12.17-12.18, 12.19-12.20, 12.21-12.22, 12.23-12.24, 12.25-12.26, 12.27-12.28, 12.29-12.30, 12.31-12.32, 12.33-12.34, 12.35-12.36, 12.37-12.38, 12.39-12.40, 12.41-12.42, 12.43-12.44, 12.45-12.46, 12.47-12.48, 12.49-12.50, 12.51-12.52, 12.53-12.54, 12.55-12.56, 12.57-12.58, 12.59-12.60, 12.61-12.62, 12.63-12.64, 12.65-12.66, 12.67-12.68, 12.69-12.70, 12.71-12.72, 12.73-12.74, 12.75-12.76, 12.77-12.78, 12.79-12.80, 12.81-12.82, 12.83-12.84, 12.85-12.86, 12.87-12.88, 12.89-12.90, 12.91-12.92, 12.93-12.94, 12.95-12.96, 12.97-12.98, 12.99-13.00, 13.01-13.02, 13.03-13.04, 13.05-13.06, 13.07-13.08, 13.09-13.10, 13.11-13.12, 13.13-13.14, 13.15-13.16, 13.17-13.18, 13.19-13.20, 13.21-13.22, 13.23-13.24, 13.25-13.26, 13.27-13.28, 13.29-13.30, 13.31-13.32, 13.33-13.34, 13.35-13.36, 13.37-13.38, 13.39-13.40, 13.41-13.42, 13.43-13.44, 13.45-13.46, 13.47-13.48, 13.49-13.50, 13.51-13.52, 13.53-13.54, 13.55-13.56, 13.57-13.58, 13.59-13.60, 13.61-13.62, 13.63-13.64, 13.65-13.66, 13.67-13.68, 13.69-13.70, 13.71-13.72, 13.73-13.74, 13.75-13.76, 13.77-13.78, 13.79-13.80, 13.81-13.82, 13.83-13.84, 13.85-13.86, 13.87-13.88, 13.89-13.90, 13.91-13.92, 13.93-13.94, 13.95-13.96, 13.97-13.98, 13.99-14.00, 14.01-14.02, 14.03-14.04, 14.05-14.06, 14.07-14.08, 14.09-14.10, 14.11-14.12, 14.13-14.14, 14.15-14.16, 14.17-14.18, 14.19-14.20, 14.21-14.22, 14.23-14.24, 14.25-14.26, 14.27-14.28, 14.29-14.30, 14.31-14.32, 14.33-14.34, 14.35-14.36, 14.37-14.38, 14.39-14.40, 14.41-14.42, 14.43-14.44, 14.45-14.46, 14.47-14.48, 14.49-14.50, 14.51-14.52, 14.53-14.54, 14.55-14.56, 14.57-14.58, 14.59-14.60, 14.61-14.62, 14.63-14.64, 14.65-14.66, 14.67-14.68, 14.69-14.70, 14.71-14.72, 14.73-14.74, 14.75-14.76, 14.77-14.78, 14.79-14.80, 14.81-14.82, 14.83-14.84, 14.85-14.86, 14.87-14.88, 14.89-14.90, 14.91-14.92, 14.93-14.94, 14.95-14.96, 14.97-14.98, 14.99-15.00, 15.01-15.02, 15.03-15.04, 15.05-15.06, 15.07-15.08, 15.09-15.10, 15.11-15.12, 15.13-15.14, 15.15-15.16, 15.17-15.18, 15.19-15.20, 15.21-15.22, 15.23-15.24, 15.25-15.26, 15.27-15.28, 15.29-15.30, 15.31-15.32, 15.33-15.34, 15.35-15.36, 15.37-15.38, 15.39-15.40, 15.41-15.42, 15.43-15.44, 15.45-15.46, 15.47-15.48, 15.49-15.50, 15.51-15.52, 15.53-15.54, 15.55-15.56, 15.57-15.58, 15.59-15.60, 15.61-15.62, 15.63-15.64, 15.65-15.66, 15.67-15.68, 15.69-15.70, 15.71-15.72, 15.73-15.74, 15.75-15.76, 15.77-15.78, 15.79-15.80, 15.81-15.82, 15.83-15.84, 15.85-15.86, 15.87-15.88, 15.89-15.90, 15.91-15.92, 15.93-15.94, 15.95-15.96, 15.97-15.98, 15.99-16.00, 16.01-16.02, 16.03-16.04, 16.05-16.06, 16.07-16.08, 16.09-16.10, 16.11-16.12, 16.13-16.14, 16.15-16.16, 16.17-16.18, 16.19-16.20, 16.21-16.22, 16.23-16.24, 16.25-16.26, 16.27-16.28, 16.29-16.30, 16.31-16.32, 16.33-16.34, 16.35-16.36, 16.37-16.38, 16.39-16.40, 16.41-16.42, 16.43-16.44, 16.45-16.46, 16.47-16.48, 16.49-16.50, 16.51-16.52, 16.53-16.54, 16.55-16.56, 16.57-16.58, 16.59-16.60, 16.61-16.62, 16.63-16.64, 16.65-16.66, 16.67-16.68, 16.69-16.70, 16.71-16.72, 16.73-16.74, 16.75-16.76, 16.77-16.78, 16.79-16.80, 16.81-16.82, 16.83-16.84, 16.85-16.86, 16.87-16.88, 16.89-16.90, 16.91-16.92, 16.93-16.94, 16.95-16.96, 16.97-16.98, 16.99-17.00, 17.01-17.02, 17.03-17.04, 17.05-17.06, 17.07-17.08, 17.09-17.10, 17.11-17.12, 17.13-17.14, 17.15-17.16, 17.17-17.18, 17.19-17.20, 17.21-17.22, 17.23-17.24, 17.25-17.26, 17.27-17.28, 17.29-17.30, 17.31-17.32, 17.33-17.34, 17.35-17.36, 17.37-17.38, 17.39-17.40, 17.41-17.42, 17.43-17.44, 17.45-17.46, 17.47-17.48, 17.49-17.50, 17.51-17.52, 17.53-17.54, 17.55-17.56, 17.57-17.58, 17.59-17.60, 17.61-17.62, 17.63-17.64, 17.65-17.66, 17.67-17.68, 17.69-17.70, 17.71-17.72, 17.73-17.74, 17.75-17.76, 17.77-17.78, 17.79-17.80, 17.81-17.82, 17.83-17.84, 17.85-17.86, 17.87-17.88, 17.89-17.90, 17.91-17.92, 17.93-17.94, 17.95-17.96, 17.97-17.98, 17.99-18.00, 18.01-18.02, 18.03-18.04, 18.05-18.06, 18.07-18.08, 18.09-18.10, 18.11-18.12, 18.13-18.14, 18.15-18.16, 18.17-18.18, 18.19-18.20, 18.21-18.22, 18.23-18.24, 18.25-18.26, 18.27-18.28, 18.29-18.30, 18.31-18.32, 18.33-18.34, 18.35-18.36, 18.37-18.38, 18.39-18.40, 18.41-18.42, 18.43-18.44, 18.45-18.46, 18.47-18.48, 18.49-18.50, 18.51-18.52, 18.53-18.54, 18.55-18.56, 18.57-18.58, 18.59-18.60, 18.61-18.62, 18.63-18.64, 18.65-18.66, 18.67-18.68, 18.69-18.70, 18.71-18.72, 18.73-18.74, 18.75-18.76, 18.77-18.78, 18.79-18.80, 18.81-18.82, 18.83-18.84, 18.85-18.86, 18.87-18.88, 18.89-18.90, 18.91-18.92, 18.93-18.94, 18.95-18.96, 18.97-18.98, 18.99-19.00, 19.01-19.02, 19.03-19.04, 19.05-19.06, 19.07-19.08, 19.09-19.10, 19.11-19.12, 19.13-19.14, 19.15-19.16, 19.17-19.18, 19.19-19.20, 19.21-19.22, 19.23-19.24, 19.25-19.26, 19.27-19.28, 19.29-19.30, 19.31-19.32, 19.33-19.34, 19.35-19.36, 19.37-19.38, 19.39-19.40, 19.41-19.42, 19.43-19.44, 19.45-19.46, 19.47-19.48, 19.49-19.50, 19.51-19.52, 19.53-19.54, 19.55-19.56, 19.57-19.58, 19.59-19.60, 19.61-19.62, 19.63-19.64, 19.65-19.66, 19.67-19.68, 19.69-19.70, 19.71-19.72, 19.73-19.74, 19.75-19.76, 19.77-19.78, 19.79-19.80, 19.81-19.82, 19.83-19.84, 19.85-19.86, 19.87-19.88, 19.89-19.90, 19.91-19.92, 19.93-19.94, 19.95-19.96, 19.97-19.98, 19.99-20.00, 20.01-20.02, 20.03-20.04, 20.05-20.06, 20.07-20.08, 20.09-20.10, 20.11-20.12, 20.13-20.14, 20.15-20.16, 20.17-20.18, 20.19-20.20, 20.21-20.22, 20.23-20.24, 20.25-20.26, 20.27-20.28, 20.29-20.30, 20.31-20.32, 20.33-20.34, 20.35-20.36, 20.37-20.38, 20.39-20.40, 20.41-20.42, 20.43-20.44, 20.45-20.46, 20.47-20.48, 20.49-20.50, 20.51-20.52, 20.53-20.54, 20.55-20.56, 20.57-20.58, 20.59-20.60, 20.61-20.62, 20.63-20.64, 20.65-20.66, 20.67-20.68, 20.69-20.70, 20.71-20.72, 20.73-20.74, 20.75-20.76, 20.77-20.78, 20.79-20.80, 20.81-20.82, 20.83-20.84, 20.85-20.86, 20.87-20.88, 20.89-20.90, 20.91-20.92, 20.93-20.94, 20.95-20.96, 20.97-20.98, 20.99-21.00, 21.01-21.02, 21.03-21.04, 21.05-21.06, 21.07-21.08, 21.09-21.10, 21.11-21.12, 21.13-21.14, 21.15-21.16, 21.17-21.18, 21.19-21.20, 21.21-21.22, 21.23-21.24, 21.25-21.26, 21.27-21.28, 21.29-21.30, 21.31-21.3

*Land Acquisition and Resettlement Plan of
Hydropower Development Investment Project*



3047 School Public



3047

[illegible]

3047



3048 House Private



3048

[illegible]

3048



0049 House Private



0049

0049

0049



3052 House Private



3052

3052

3052



3053 House Private



3053

3053

Household Survey Form

Household ID: 3053

Household Name: [Handwritten Name]

Household Address: [Handwritten Address]

Household Type: [Handwritten Type]

Household Size: [Handwritten Size]

Household Head: [Handwritten Name]

Household Head Gender: [Handwritten Gender]

Household Head Age: [Handwritten Age]

Household Head Education: [Handwritten Education]

Household Head Occupation: [Handwritten Occupation]

Household Head Income: [Handwritten Income]

Household Head Assets: [Handwritten Assets]

Household Head Debts: [Handwritten Debts]

Household Head Other: [Handwritten Other]

Household Head Signature: [Handwritten Signature]

Household Head Date: [Handwritten Date]

Household Head Stamp: [Handwritten Stamp]

Household Head Seal: [Handwritten Seal]

Household Head Photo: [Handwritten Photo]

Household Head Video: [Handwritten Video]

Household Head Audio: [Handwritten Audio]

Household Head Other: [Handwritten Other]

Household Head Signature: [Handwritten Signature]

Household Head Date: [Handwritten Date]

Household Head Stamp: [Handwritten Stamp]

Household Head Seal: [Handwritten Seal]

Household Head Photo: [Handwritten Photo]

Household Head Video: [Handwritten Video]

Household Head Audio: [Handwritten Audio]

Household Head Other: [Handwritten Other]

Household Head Signature: [Handwritten Signature]

Household Head Date: [Handwritten Date]

Household Head Stamp: [Handwritten Stamp]

Household Head Seal: [Handwritten Seal]

Household Head Photo: [Handwritten Photo]

Household Head Video: [Handwritten Video]

Household Head Audio: [Handwritten Audio]

Household Head Other: [Handwritten Other]

3053



3054 House Private



3054

3054

Household Survey Form

Household ID: 3054

Household Name: [Handwritten Name]

Household Address: [Handwritten Address]

Household Type: [Handwritten Type]

Household Size: [Handwritten Size]

Household Head: [Handwritten Name]

Household Head Gender: [Handwritten Gender]

Household Head Age: [Handwritten Age]

Household Head Education: [Handwritten Education]

Household Head Occupation: [Handwritten Occupation]

Household Head Income: [Handwritten Income]

Household Head Assets: [Handwritten Assets]

Household Head Debts: [Handwritten Debts]

Household Head Other: [Handwritten Other]

Household Head Signature: [Handwritten Signature]

Household Head Date: [Handwritten Date]

Household Head Stamp: [Handwritten Stamp]

Household Head Seal: [Handwritten Seal]

Household Head Photo: [Handwritten Photo]

Household Head Video: [Handwritten Video]

Household Head Audio: [Handwritten Audio]

Household Head Other: [Handwritten Other]

Household Head Signature: [Handwritten Signature]

Household Head Date: [Handwritten Date]

Household Head Stamp: [Handwritten Stamp]

Household Head Seal: [Handwritten Seal]

Household Head Photo: [Handwritten Photo]

Household Head Video: [Handwritten Video]

Household Head Audio: [Handwritten Audio]

Household Head Other: [Handwritten Other]

3054



2001 House Private



2001



2002 House Private



2002



2002 House Private



2002



2002 House Private



2002



2003 House Private



2003

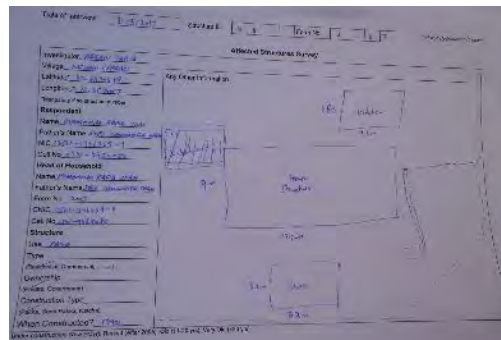

2003



2004 House Private



2004

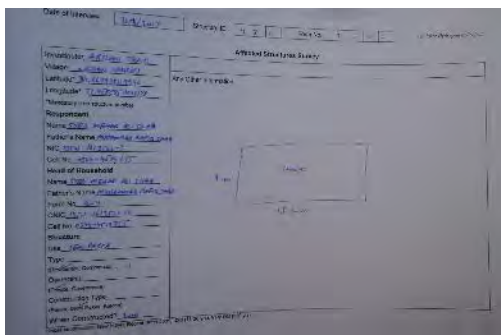

2004

Land Acquisition and Resettlement Plan of Hydropower Development Investment Project



2005 House Private

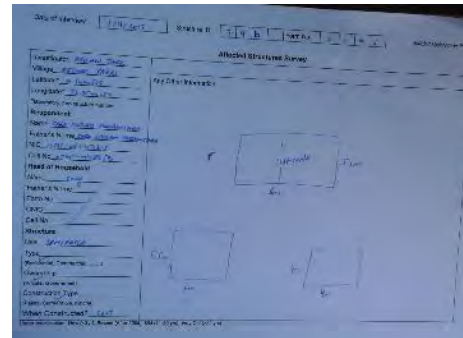

2005



2006 House Private

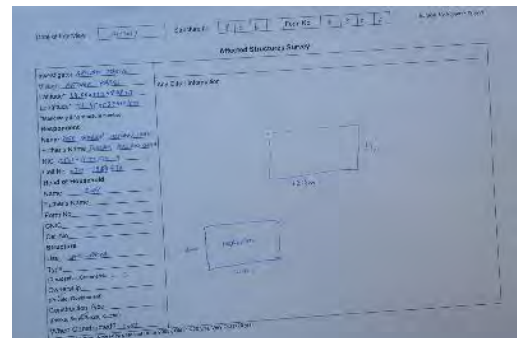

2006



2007 House Private

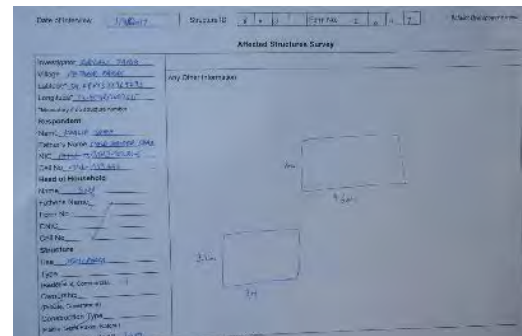

2007



2008 House Private

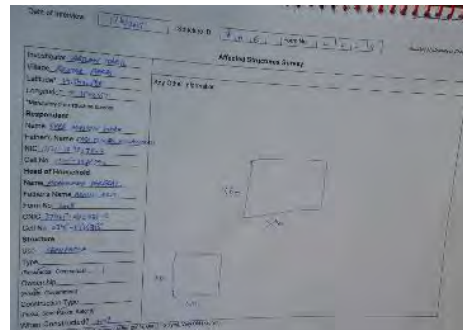

2008



2009 House Private

Date of Interview: 24/4/2011 Status: B 2 Family: 2 No. of Children: 2

Investigator: Ahsan Ullah
Village: Chak 1B
Latitude: 34° 15' 00" N
Longitude: 73° 15' 00" E
Household Type: Private
Household Head: Ahsan Ullah
Father's Name: Ahsan Ullah
Family Size: 2
Form No.: 1
Date of Interview: 24/4/2011
Interviewer: Ahsan Ullah
When Completed: 24/4/2011

Affected Structures Survey

Any Other Information:

7m
2.5m

2009



2010 House Private

Date of Interview: 24/4/2011 Status: B 2 Family: 2 No. of Children: 2

Investigator: Ahsan Ullah
Village: Chak 1B
Latitude: 34° 15' 00" N
Longitude: 73° 15' 00" E
Household Type: Private
Household Head: Ahsan Ullah
Father's Name: Ahsan Ullah
Family Size: 2
Form No.: 1
Date of Interview: 24/4/2011
Interviewer: Ahsan Ullah
When Completed: 24/4/2011

Affected Structures Survey

Any Other Information:

7m
2.5m

2010



2011 House Private

Date of Interview: 24/4/2011 Status: B 2 Family: 2 No. of Children: 2

Investigator: Ahsan Ullah
Village: Chak 1B
Latitude: 34° 15' 00" N
Longitude: 73° 15' 00" E
Household Type: Private
Household Head: Ahsan Ullah
Father's Name: Ahsan Ullah
Family Size: 2
Form No.: 1
Date of Interview: 24/4/2011
Interviewer: Ahsan Ullah
When Completed: 24/4/2011

Affected Structures Survey

Any Other Information:

7m
2.5m

2011



2012 House Private

Date of Interview: 24/4/2011 Status: B 2 Family: 2 No. of Children: 2

Investigator: Ahsan Ullah
Village: Chak 1B
Latitude: 34° 15' 00" N
Longitude: 73° 15' 00" E
Household Type: Private
Household Head: Ahsan Ullah
Father's Name: Ahsan Ullah
Family Size: 2
Form No.: 1
Date of Interview: 24/4/2011
Interviewer: Ahsan Ullah
When Completed: 24/4/2011

Affected Structures Survey

Any Other Information:

7m
2.5m

2012



2013 House Private

Date of Interview: 27/Jan/17 Structure ID: 13000000000000000000

Investigator: Ali Khan, Shafiq

Village: Gule, District: Peshawar

Latitude: 33.5123456789 Longitude: 71.5123456789

Household Number: 13000000000000000000

Respondent: Father's Name: Ali Khan

Household Name: Gule

Form No: 13000000000000000000

Structure: 13000000000000000000

Any Other Information:

2013



2014 House Private

Date of Interview: 27/Jan/17 Structure ID: 13000000000000000000

Investigator: Ali Khan, Shafiq

Village: Gule, District: Peshawar

Latitude: 33.5123456789 Longitude: 71.5123456789

Household Number: 13000000000000000000

Respondent: Father's Name: Ali Khan

Household Name: Gule

Form No: 13000000000000000000

Structure: 13000000000000000000

Any Other Information:

2014



2015 House Private

Date of Interview: 27/Jan/17 Structure ID: 13000000000000000000

Investigator: Ali Khan, Shafiq

Village: Gule, District: Peshawar

Latitude: 33.5123456789 Longitude: 71.5123456789

Household Number: 13000000000000000000

Respondent: Father's Name: Ali Khan

Household Name: Gule

Form No: 13000000000000000000

Structure: 13000000000000000000

Any Other Information:

2015



2016 House Private

Date of Interview: 27/Jan/17 Structure ID: 13000000000000000000

Investigator: Ali Khan, Shafiq

Village: Gule, District: Peshawar

Latitude: 33.5123456789 Longitude: 71.5123456789

Household Number: 13000000000000000000

Respondent: Father's Name: Ali Khan

Household Name: Gule

Form No: 13000000000000000000

Structure: 13000000000000000000

Any Other Information:

2016

*Land Acquisition and Resettlement Plan of
Hydropower Development Investment Project*



2017 House Private

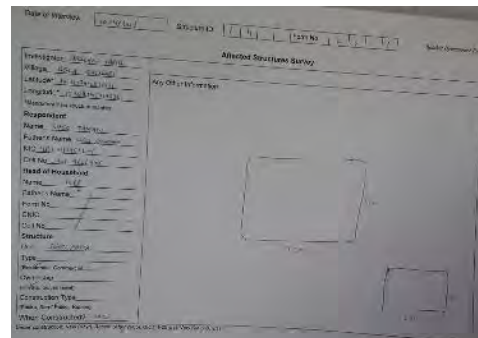

2017



2018 House Private

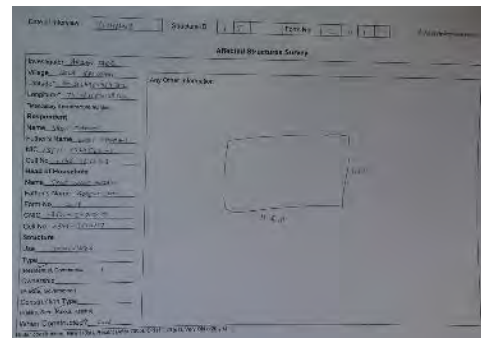

2018



2019 House Private

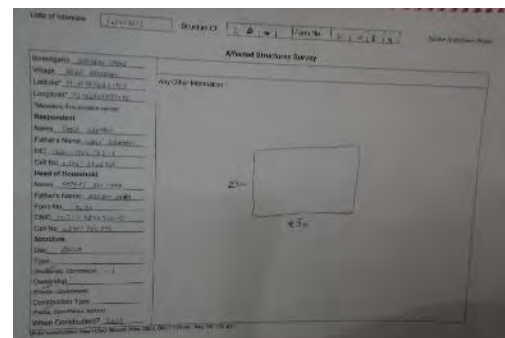

2019



2020 House Private

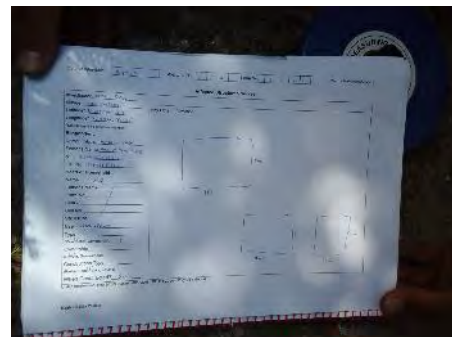

2020

*Land Acquisition and Resettlement Plan of
Hydropower Development Investment Project*



2021 House Private

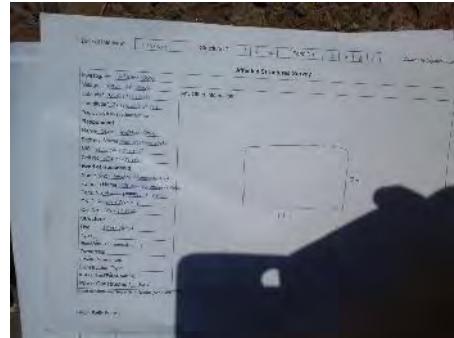

2021



2022 House Private

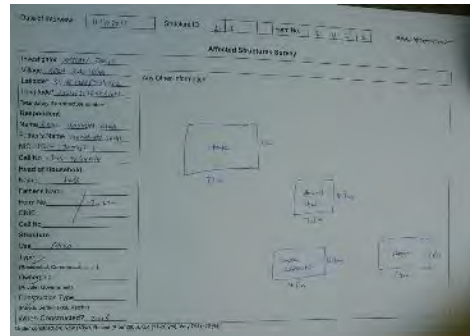

2022



2023 House Private

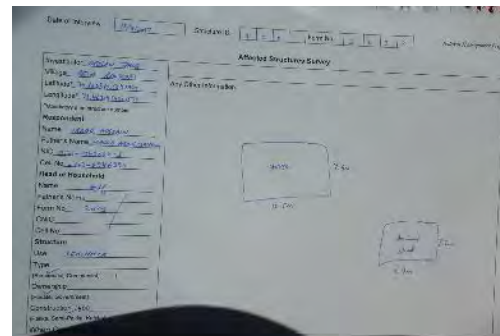

2023



2024 House Private

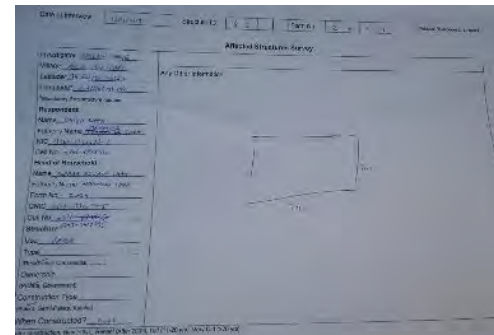

2024



2025 House Private

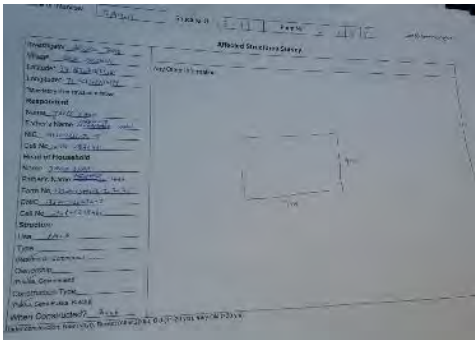

2025



2026 House Private

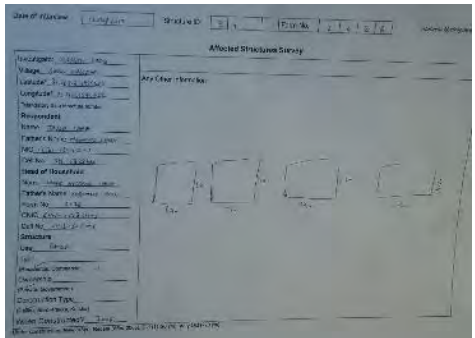

2026



2027 House Private



2027

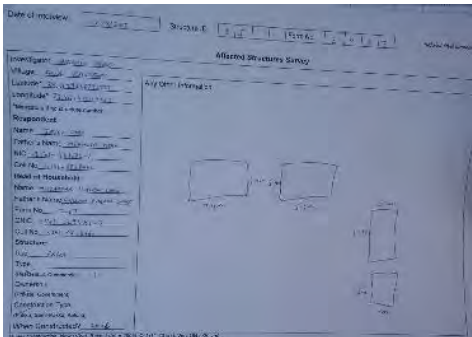

2027

Date: 11/11/2014
 Project No: 11111111
 Project Name: Project Name
 Project Location: Project Location
 Project Description: Project Description
 Project Status: Project Status
 Project Manager: Project Manager
 Project Sponsor: Project Sponsor
 Project Stakeholders: Project Stakeholders
 Project Risks: Project Risks
 Project Budget: Project Budget
 Project Timeline: Project Timeline
 Project Deliverables: Project Deliverables
 Project Milestones: Project Milestones
 Project Issues: Project Issues
 Project Change Log: Project Change Log
 Project Communication: Project Communication
 Project Reporting: Project Reporting
 Project Documentation: Project Documentation
 Project Tools: Project Tools
 Project Templates: Project Templates
 Project Forms: Project Forms
 Project Reports: Project Reports
 Project Charts: Project Charts
 Project Tables: Project Tables
 Project Diagrams: Project Diagrams
 Project Maps: Project Maps
 Project Photos: Project Photos
 Project Videos: Project Videos
 Project Audio: Project Audio
 Project Other: Project Other

[illegible][illegible]Appendix E
E-41

Land Acquisition and Resettlement Plan of
Hydropower Development Investment Project



2033 House Private

Date of Interview: 12/1/19 Sheet ID: 2.1.1 Form No: 2.1.1

Investigator: [Name] Village: [Name] Location: [Name] Longitude: [Name] Altitude: [Name] Measurement (in square meter): [Name]

Respondent: [Name] Name: [Name] Father's Name: [Name] H.O. [Name] Call No. [Name] Head of Household: [Name] Name: [Name] Father's Name: [Name] Form No: [Name] Call No. [Name] Structure: [Name] Use: [Name] Type: [Name] Measurement (in square meter): [Name] Construction Type: [Name] Construction Type: [Name] Public Distribution System: [Name] Village Construction: [Name]

Any Other Information: [Name]

Diagram: [Diagram showing a rectangular plot with dimensions 10m x 10m and 10m x 10m]

2033



2034 House Private

Date of Interview: 12/1/19 Sheet ID: 2.1.1 Form No: 2.1.1

Investigator: [Name] Village: [Name] Location: [Name] Longitude: [Name] Altitude: [Name] Measurement (in square meter): [Name]

Respondent: [Name] Name: [Name] Father's Name: [Name] H.O. [Name] Call No. [Name] Head of Household: [Name] Name: [Name] Father's Name: [Name] Form No: [Name] Call No. [Name] Structure: [Name] Use: [Name] Type: [Name] Measurement (in square meter): [Name] Construction Type: [Name] Construction Type: [Name] Public Distribution System: [Name] Village Construction: [Name]

Any Other Information: [Name]

Diagram: [Diagram showing a rectangular plot with dimensions 10m x 10m]

2034



2035 House Private

Date of Interview: 12/1/19 Sheet ID: 2.1.1 Form No: 2.1.1

Investigator: [Name] Village: [Name] Location: [Name] Longitude: [Name] Altitude: [Name] Measurement (in square meter): [Name]

Respondent: [Name] Name: [Name] Father's Name: [Name] H.O. [Name] Call No. [Name] Head of Household: [Name] Name: [Name] Father's Name: [Name] Form No: [Name] Call No. [Name] Structure: [Name] Use: [Name] Type: [Name] Measurement (in square meter): [Name] Construction Type: [Name] Construction Type: [Name] Public Distribution System: [Name] Village Construction: [Name]

Any Other Information: [Name]

Diagram: [Diagram showing a rectangular plot with dimensions 10m x 10m]

2035



2036 House Private

Date of Interview: 12/1/19 Sheet ID: 2.1.1 Form No: 2.1.1

Investigator: [Name] Village: [Name] Location: [Name] Longitude: [Name] Altitude: [Name] Measurement (in square meter): [Name]

Respondent: [Name] Name: [Name] Father's Name: [Name] H.O. [Name] Call No. [Name] Head of Household: [Name] Name: [Name] Father's Name: [Name] Form No: [Name] Call No. [Name] Structure: [Name] Use: [Name] Type: [Name] Measurement (in square meter): [Name] Construction Type: [Name] Construction Type: [Name] Public Distribution System: [Name] Village Construction: [Name]

Any Other Information: [Name]

Diagram: [Diagram showing a rectangular plot with dimensions 10m x 10m]

2036



2037 House Private



2037

DATE OF SURVEY: 12/05/2017

STRUCTURE NO: 1

TYPE: House

OWNER: Mr. [Name]

LOCATION: [Address]

PROJECT: [Project Name]

RESPONDENT: [Name]

NAME: [Name]

RELATIONSHIP: [Relationship]

AGE: [Age]

SEX: [Sex]

EDUCATION: [Education]

STATUS: [Status]

TYPE: [Type]

STRUCTURE: [Structure]

USE: [Use]

CONSTRUCTION: [Construction]

DATE OF CONSTRUCTION: [Date]

REMARKS: [Remarks]

2037



2038 School private

DATE OF SURVEY: 12/05/2017

STRUCTURE NO: 2

TYPE: School

OWNER: [Name]

LOCATION: [Address]

PROJECT: [Project Name]

RESPONDENT: [Name]

NAME: [Name]

RELATIONSHIP: [Relationship]

AGE: [Age]

SEX: [Sex]

EDUCATION: [Education]

STATUS: [Status]

TYPE: [Type]

STRUCTURE: [Structure]

USE: [Use]

CONSTRUCTION: [Construction]

DATE OF CONSTRUCTION: [Date]

REMARKS: [Remarks]

2038



2041 House Private

DATE OF SURVEY: 12/05/2017

STRUCTURE NO: 3

TYPE: House

OWNER: [Name]

LOCATION: [Address]

PROJECT: [Project Name]

RESPONDENT: [Name]

NAME: [Name]

RELATIONSHIP: [Relationship]

AGE: [Age]

SEX: [Sex]

EDUCATION: [Education]

STATUS: [Status]

TYPE: [Type]

STRUCTURE: [Structure]

USE: [Use]

CONSTRUCTION: [Construction]

DATE OF CONSTRUCTION: [Date]

REMARKS: [Remarks]

2041



2042 House Private



2042

Date of Interview	Structure ID	Form No.	Area/Volume
Investigator: [Name]	Affected Structures Survey		
Village: [Name]	Any Other Information		
Location: [Name]			
Longitude: [Name]			
Latitude: [Name]			
Structure Name			
Respondent			
Name: [Name]			
Phone No. [Name]			
Club No. [Name]			
Household			
Name of Household			
Name: [Name]	Type: [Name] Structure: [Name] Date: [Name] District: [Name] Division: [Name] Construction Type: [Name] Other: [Name] Other Construction: [Name]		

2042



2043 House Private



2043

Date of Interview	Structure ID	Form No.	Area/Volume
Investigator: [Name]	Affected Structures Survey		
Village: [Name]	Any Other Information		
Location: [Name]			
Longitude: [Name]			
Latitude: [Name]			
Structure Name			
Respondent			
Name: [Name]			
Phone No. [Name]			
Club No. [Name]			
Household			
Name of Household			
Name: [Name]	Type: [Name] Structure: [Name] Date: [Name] District: [Name] Division: [Name] Construction Type: [Name] Other: [Name] Other Construction: [Name]		

2043



2044 House Private



2044

Date of Interview	Structure ID	Form No.	Project No.
20/07/2017	2044	1	1

Affected Structures Survey

Investigator: [Name] Date: [Date]
 Village: [Name]
 Location: [Name]
 Longitude: [Name]
 Respondent: [Name]
 Name: [Name]
 Father's Name: [Name]
 Age: [Name]
 Cell No.: [Name]
 Head of Household: [Name]
 Name: [Name]
 Father's Name: [Name]
 Form No.: [Name]
 Date: [Name]
 Structure: [Name]
 Type: [Name]
 Description: [Name]
 Construction Type: [Name]
 Other Comments: [Name]

Area: [Name]
 Area: [Name]

2044



2045 House Private

Date of Interview	Structure ID	Form No.	Project No.
20/07/2017	2045	1	1

Affected Structures Survey

Investigator: [Name] Date: [Date]
 Village: [Name]
 Location: [Name]
 Longitude: [Name]
 Respondent: [Name]
 Name: [Name]
 Father's Name: [Name]
 Age: [Name]
 Cell No.: [Name]
 Head of Household: [Name]
 Name: [Name]
 Father's Name: [Name]
 Form No.: [Name]
 Date: [Name]
 Structure: [Name]
 Type: [Name]
 Description: [Name]
 Construction Type: [Name]
 Other Comments: [Name]

Area: [Name]

2045