

# **Due Diligence Report – Social Safeguards**

---

Project Number: 51190-001

February 2020

## **Nepal: Disaster Resilience of Schools Project**

### **Construction of Schools in Dolakha District (Reconstruction Phase II)**

Prepared by Central Level Project Implementation Unit (Education) of National Reconstruction Authority for the Asian Development Bank.

This Due Diligence Report is a document of the borrower. The views expressed herein do not necessarily represent those of ADB's Board of Directors, Management, or staff, and may be preliminary in nature.

In preparing any country program or strategy, financing any project, or by making any designation of or reference to a particular territory or geographic area in this document, the Asian Development Bank does not intend to make any judgments as to the legal or other status of any territory or area.

## TABLE OF CONTENTS

ABBREVIATIONS .....	III
I. INTRODUCTION .....	1
II. APPROACH AND METHODOLOGY IN DUE DILIGENCE .....	2
III. SCOPE OF LIKELY IMPACTS OF THE PROJECTS .....	2
A. INVOLUNTARY RESETTLEMENT .....	2
B. INDIGENOUS PEOPLES .....	ERROR! BOOKMARK NOT DEFINED.
IV. CONSULTATIONS .....	4
V. CONCLUSION AND RECOMMENDATIONS .....	4

## LIST OF ANNEXES

Annex 1: List of School Selected for First Batch (Recon 2) under DRSP & their Land Ownership Status ..	5
Annex 2: Involuntary resettlement impact screening checklist of sample Schools.....	7
Annex 3: IP impact screening checklist of sample Schools (subprojects) .....	8
Annex 4: Balodaya SS.....	9
Annex 5: Devi SS .....	15
Annex 6: Thampu SS .....	22
Annex 7: Lapilang SS.....	29
Annex 8: Pashupati Kanya SS.....	34
Annex 9: Sarada SS.....	40
Annex 10: Janajyoti SS .....	47
Annex 11: Chitre SS.....	58
Annex 12: Janajyoti SS, Putalikat .....	67
Annex 13: Kalika SS .....	73
Annex 16: Satyeshwor SS .....	80

## **CURRENCY EQUIVALENTS**

**(As of December 2019)**

Currency Unit -Nepalese Rupee (NRs)

NRs 1.00 =		\$ 0.008742782005
\$ 1.00	=	NRs 114.38

## **WEIGHTS AND MEASURES**

**Kilometer - km**

Note

In this report, "\$" refers to US dollars unless otherwise stated

## **ABBREVIATIONS**

ADB	Asian Development Bank
CLPIU	Central Level Project Implementation Unit
CSA	Concerned Sector Agency
CSSF	Comprehensive School Safety Framework
DDR	Due Diligence Report
DLPIU	District Level Project Implementation Unit
DOE	Department of Education
DRM	Disaster Risk Management
DRSP	Disaster Resilience of Schools Project
DSC	Design and Supervision Consultants
EEAP	Earthquake Emergency Assistance Project
EMIS	Education Management Information System
GoN	Government of Nepal
GRC	Grievance Redress Committee
GRM	Grievance Redress Mechanism
IA	Implementing Agency
IFB	Invitation for Bid
LG	Local Government
LOC	Land Ownership Certificate
MOE	Ministry of Education
NGO	Nongovernmental Organization
NRA	National Reconstruction Authority
O&M	Operation and Maintenance
PPTA	Project Preparation Technical Assistance
PMU	Project Management Unit
RECON	Reconstruction
RF	Resettlement Framework
SPS	Safeguards Policy Statement 2009
SMC	School Management Committee
ToR	Terms of Reference
TLC	Temporary Learning Center

## I. INTRODUCTION

1. The proposed project will improve disaster resilience of school infrastructure and communities in 3 provinces of Nepal. The project will support school infrastructure investments, disaster risk management and institutional strengthening. More specifically, it will upgrade 174 distinct schools through either reconstructing or retrofitting their damaged buildings. 154 will be secondary education schools (74 up to grade 10 and 80 up to grade 12) and 20 feeder basic education schools (up to grade 8). 70% of them will be in rural areas and 30% in urban areas and collectively they will provide a safe learning environment to 64,300 students of which 33,600 will be girls.
2. These schools have been selected based on the total enrollment, the scale of the physical damages incurred, and the proportion of girls and underprivileged students. They are located in 14 districts affected by the earthquake. The investment works will also include the provision of laboratories, information communication and technology, library, gender segregated toilets, and amenities designed to mitigate other potential weather-related disaster and ensure a safe learning environment. Along with the infrastructure investments, the project will train the school management and communities to increase awareness and reduce exposure and vulnerability to natural disaster.
3. The project (DRSP) is aligned with the following impact: Disaster risk management for human resources enhanced. The expected project outcome is: disaster resilience of schools and communities increased and learning environment improved. The three expected project outputs are: (i) heavily damaged schools reconstructed and improved; (ii) unsafe schools retrofitted and disaster risks reduced; and (iii) institutional capacity for management and disaster resilience strengthened.
4. This due diligence report (DDR) has been prepared covering 11 schools of Dolakha district proposed to be considered for second batch financing to assess the likely social impacts of the subprojects as per the applicable government policies/procedures and ADB Safeguard Policies as observed during the review of master plans and individual DDRs of school, interaction with SMC members as well as the information received from CLPIU and DLPIU.

### List of Schools of Dolakha District

S. N	EMIS	Name	District	Location
1	220270004	Balodaya SS	Dolakha	Kalinchowk RM-1, Dusikharka
2	220310002	Chitre SS	Dolakha	Bigu Rural Municipality-4, Chitre
3	220080005	Devi SS	Dolakha	Bimeshwor Rural Municipality-8, Boach
4	220170002	Janajyoti SS, Gairimudi	Dolakha	Putalikath, Baiteshwor RM-2
5	220350003	Janajyoti SS, Leptung	Dolakha	Leptung, Kalinchowk Municipality -6
6	220200003	Kalika SS	Dolakha	Tamakoshi Rural Municipality – 7 Hanwa
7	220350001	Lapilang SS	Dolakha	Kalinchowk RM-5, Lapilang, Bhimsenthan
8	220040033	Pashupati Kanya SS	Dolakha	Bhimeshwor municipality-3, Charikot
9	220460001	Sarada SS	Dolakha	Shailung Rural Municipality- 8, Bhaise
10	220440006	Satyashwar SS	Dolakha	Pawati Rural Municipality-1, Pawati
11	220010002	Thampu SS	Dolakha	Bigu rural municipality-6, Alampu

5. The main objective of the DDR is to assess the land availability, ownership status of the schools selected for second batch reconstruction of buildings and assess likely social impacts due to implementation of the proposed reconstruction activities with respect to land acquisition, compensation and involuntary resettlement, common properties (if any) and in terms of displacement, loss of incomes, and restriction on access to private properties and common community resources.

## **II. APPROACH AND METHODOLOGY IN DUE DILIGENCE**

6. As part of the due diligence, a desk review of the project concept notes, project DDR, design, drawings were carried out. ADB's safeguard policy requirements and government of Nepal's legal framework in relation to social safeguards were reviewed thoroughly for identifying gap between ADB policy and GoN legal framework. Consultations were held with central level stakeholders (informal meetings with CLPIU and ADB). Likewise, respective RE and SMs conducted discussions with DLPIU and SMC members during revision of individual DDRs (Recon 2). Consultation meetings were organized by EEAP design team with all 11 schools during master plan design and DDR preparation phase. The details of the participants in the discussion have been provided in Annex (meeting minutes Annex 4). Due diligence assessment of the likely involuntary resettlement and indigenous people impacts were carried out on the basis of desk review, information and documents provided by the central level project implementation unit (CLPIU) and district level project implementation unit (DLPIU) and interactions and discussions with school teachers, members of the school management committee (SMC), representatives of local governments, students, parents and local communities and other stakeholders while conducting site observation and verification by DSC team at field level. A construction master plan has been prepared for identified schools and total land requirements have been assessed following scope of the master plan.

7. All 11 schools selected for second batch of reconstruction in this district have been selected for due diligence of the involuntary resettlement and indigenous people impacts. Design of all the schools was completed and available. The DRSP team at both central and field level collected missing information from the field. Information thus collected have been analyzed and substantiated with the findings of desk reviews and interactions. Individual due diligence report was prepared by EEAP (edu) team and the same was revised and updated by the DRSP/DSC based on which this consolidated DDR has been prepared. The key findings from the desk review have been further substantiated and verified by informal consultation with stakeholders and came to conclusion that all government schools more or less have similar types of land ownership pattern (either own land title or possession of occupancy right from local government. Also, establishment of schools through privately or publicly/community donated lands remains a historical legacy in Nepal but transfer of land ownership to school is still largely ignored) and face more or less similar types of issues. Thus, it is assumed that the findings of this due diligence assessment will be applicable for all schools under DRSP. A resettlement framework (RF) is in place to provide policy and procedural guidance to address issues related to lands and indigenous people. Any unanticipated impacts and issue will be documented during the implementation phase and mitigated based on provision made in the RF. The implementing agency (IA) and project implementation authorities will finalize the entitlements in line with the GoN legal provisions and ADB's SPS, 2009.

## **III. SCOPE OF LIKELY IMPACTS OF THE PROJECTS**

### **A. *Involuntary Resettlement***

8. Consultation discussions with CLPIU, DSC, DLPIU and district DSC team members and review of design of the school building indicate that the construction activity will be confined within the existing boundaries of the schools having their own titled lands or occupancy right issued by local government. Nine schools of the total 11 schools in Dolakha own lands (with landownership certificate) required for reconstruction of school buildings. The land occupied by Janajyoti SS,

Lapting and Sarada SS, Bhaire are public (government) land with the evidence of occupancy from local government (scanned copies of land ownership certificates for 9 schools and sample evidence of occupancy for 2 school have been attached in Annex---LOC and land use right provided by LG).The due diligence of schools to be considered for second batch financing in this district have sufficient land (either having land ownership certificate or with land use right document) within their existing boundary.

9. The construction activity will be limited within the existing boundaries of the schools. According to the assessment of land availability for the proposed schools considered for project design and readiness, there is no need of new land acquisition and there won't be physical as well as economic displacement for the schools.

10. During construction period, these schools may lack sufficient number of classrooms to run classes which may require schools to merge classes or conduct classes out in the open to accommodate students. To overcome this problem, the establishment of the Temporary Learning Centers (TLCs) has been envisaged within the school compound or in the vicinity of the area. Establishment of TLCs will help the students to continue their study and the schools will have enough time to plan and reconstruct the destroyed classrooms. SMC and local people will facilitate to get suitable site for TLC construction (if required) and a lease agreement (if applicable) will be made as per provision in resettlement framework.

11. Based on the analysis of pattern of land availability of the second batch schools and considering the historical practices of school establishment in Nepal, the schools considered for funding by the project are unlikely to require additional land. DRSP project is aligned with the objective of GoN's School Sector Development Plan (2017-2022) for disaster risk reduction and safer school and primarily involves the reconstruction and rehabilitation of earthquake damaged school buildings. A consolidated involuntary resettlement screening form has been prepared for the project is attached in Annex 2.

## ***B. Indigenous Peoples***

12. The project is classified as category 'C' for indigenous people as no impact on indigenous people have been reported for the school studied for due diligence report (DDR) preparation. The project is classified as category 'C' for indigenous people as no impact on indigenous people have been reported for the school studied for due diligence report (DDR) preparation. The project is primarily designed to improve the physical infrastructure of the existing school buildings to reduce disaster risk including improved facilities (e.g. class rooms, library and laboratories). The land being used by the schools is exclusively for education purposes where the indigenous peoples have no collective attachments. The improved school facilities and disaster resilient school infrastructures built under the proposed project will be beneficial to the children of indigenous peoples who are among the students of the schools pursuing their basic and secondary education. Children of the indigenous peoples and non-indigenous peoples both follow the similar modes of educational system. Implementation of the project activities neither directly nor indirectly affects the dignity, human rights, livelihood systems, or culture of indigenous people. Hence, the safeguard requirements 3 will not trigger. Thus, the project fits into category 'C' for indigenous peoples according to ADB's Safeguard Policy Statement (2009). The IP impacts screening form for the project is attached in Annex IP impact screening checklist).

## ***C. Road Shift***

13. A road passes through the school compound of Janajyoti Secondary School, Leptung. According to the information obtained from school management committee, the trial road passing through the school boundary will be shifted as required using adjoining available public land by the local government (Refer to meeting minute annex page 52-54).

#### **IV. CONSULTATIONS**

14. Consultation with stakeholders was held with various stakeholders during design and master plan preparation phase of the schools. Further consultation and discussion were conducted with concerned school personnel/SMC members where more clarifications wherever required during DDR and master plan review phase on case wise basis. Following are the key issues raised by the stakeholders and observed during consultation and site observation:

1. All the participants were highly positive toward the ADB funded DRSP and their expectation were to start project (building construction) as soon as possible.
2. All schools have lands sufficient for construction of school building with various land ownership pattern. Nine schools of the total 11 schools' own lands (with landownership certificate) required for reconstruction of school buildings. The land occupied by Janajyoti SS, Leptung and Sarada SS, Bhaise are public (government) lands with evidence of occupancy from local government.

#### **V. CONCLUSION AND RECOMMENDATIONS**

15. Based on the review of land ownership document, the land within existing boundary of all 11 schools selected for 1<sup>st</sup> package of Recon 2 is sufficient to reconstruct the schools. There will not be involuntary resettlement impacts as there will be no involuntary resettlement under the project. All the construction works will be carried out on the existing lands owned or occupied by the schools. Consultation with officials of DLPIUs, SMCs, teachers and local communities confirmed that the proposed lands for school construction are legally owned or occupied by the schools for only educational purposes, it has no collective attachments of indigenous peoples and the proposed construction activities will not result in any loss of residential land, or loss of shelter and loss of assets, access to assets, income sources, or means of livelihoods of the local people. The project activities neither directly nor indirectly affect the dignity, human rights, livelihood systems, or culture of indigenous people. Thus, it seems that the subprojects do not appear to involve reputational risk to the Asian Development Bank on social safeguards and it is recommended for funding under the proposed project.

16. All the proposed sites have more than sufficient land with legal ownership or user rights, so no foreseeable safeguard issues are observed. Wherever the user rights have been issued these have done prior to the planning and design of the DRSP so the issue of user rights has not been triggered by DRSP. There are no issues of land donation in the selected project sites

17. There are no historical, cultural, archaeological sites situated within and close to the proposed school sites. Moreover, no underground utilities, protected areas, wetland, buffer zone of protected area exist close to the proposed school sites.

18. School-wise separate DDR has been prepared considering the availability of lands, land ownership and occupancy patterns of the proposed reconstruction of schools under DRSP. Any changes in this regard between this date and actual construction shall be substantiated by preparing an updated report.



**Annex 1: List of School Selected for First Batch (Recon 2) under DRSP & their Land Ownership Status**

Sn.	EMIS	School Name	District	Address	Total area of land owned by school as per land ownership certificate.	Total area of Land within existing school boundary	Total area of land required as per master plan (sqm)	Total area required for reconstruction	Land ownership status of existing land (sqm.)			Area of additional land required to implement master plan	How additional land arranged	Remarks
									With Land owners hip certificate	User right with local government or owner agency approval	Voluntary donation by private owner			
1	220270004	Balodaya SS	Dolakha	Kalinchowk RM-1, Dusikharka	9045	5201.95	5201.95	446.26	9045	NA	NA	NA	NA	
2	220310002	Chitre SS	Dolakha	Bigu Rural Municipality-4, Chitre	6696	1933.5	1933.5	176.56	6696	NA	NA	NA	NA	
3	220080005	Devi SS	Dolakha	Bimeshwor Rural Municipality-8, Boach	2930	2793.63	2793.63	434.4	2930	NA	NA	NA	NA	
4	220170002	Janajyoti SS, Gairimudi	Dolakha	Putalikath, Baiteshwor RM-2	6395	441.18	441.18	176.54	6395	NA	NA	NA	NA	
5	220350003	Janajyoti SS, Leptung	Dolakha	Leptung, Kalinchowk Municipality -6	NA	2871.28	2871.28	446.26	NA	20349	NA	NA	NA	Local Government has issued land use right on 2076/7/27. Trail shifting by LG (2076/10/9).
6	220200003	Kalika SS	Dolakha	Tamakoshi Rural Municipality – 7 Hanwa	5665	3940.58	3940.58	240.86	5665	NA	NA	NA	NA	

Sn.	EMIS	School Name	District	Address	Total area of land owned by school as per land ownership certificate.	Total area of Land within existing school boundary	Total area of land required as per master plan (sqm)	Total area required for reconstruction	Land ownership status of existing land (sqm.)			Area of additional land required to implement master plan	How additional land arranged	Remarks
									With Land ownership certificate	User right with local government or owner agency approval	Voluntary donation by private owner			
7	220350001	Lapilang SS	Dolakha	Kalinchowk RM-5, Lapilang, Bhimsenthana	1230	847.45	847.45	338.96	1230	NA	NA	NA	NA	
8	220040033	Pashupati Kanya SS	Dolakha	Bhimeshwar municipality-3, Charikot	3608	3157.14	3157.14	240.86	3608	NA	NA	NA	NA	
9	220460001	Sarada SS	Dolakha	Shailung Rural Municipality- 8, Bhaise	NA	9956.8	9956.8	446.26	NA	20349.48	NA	NA	NA	Users right issued by both Shailung RM-8 and Phalame Pokhari CFUG
10	220440006	Satyashwar SS	Dolakha	Pawati Rural Municipality-1, Pawati	10010	2016.55	2016.55	465.2	10010	NA	NA	NA	NA	
11	220010002	Thampu SS	Dolakha	Bigu rural municipality-6, Alampu	830	830	830	249.72	830	NA	NA	NA	NA	

## Annex 2: Involuntary resettlement impact screening checklist of sample Schools

Probable Involuntary Resettlement Effects	Yes	No	Not Known	Remarks
<b>Involuntary Acquisition of Land</b>				
1. Will there be land acquisition?		X		All the construction works will be carried out on the existing lands owned or occupied by the schools. Any lands required for implementation of DR-PSIC will be acquired only through voluntary donation
2. Is the site for land acquisition known?		X		
3. Is the ownership status and current usage of land to be acquired known?		X		
4. Will easement be utilized within an existing Right of Way (ROW)?			X	
5. Will there be loss of shelter and residential land due to land acquisition?		X		
6. Will there be loss of agricultural and other productive assets due to land acquisition?		X		
7. Will there be losses of crops, trees, and fixed assets due to land acquisition?		X		Trees or crops of private persons shall not be affected. While there are some trees in some school premises, it is unlikely that they shall be affected by the construction.
8. Will there be loss of businesses or enterprises due to land acquisition?		X		
9. Will there be loss of income sources and means of livelihoods due to land acquisition?		X		
<b>Involuntary restrictions on land use or on access to legally designated parks and protected areas</b>				
10. Will people lose access to natural resources, communal facilities and services?		X		If the trails pass through the schools will be closed or blocked by compounding or fencing without giving suitable alternative then local people may lose access to natural resources and communal facilities and services
11. If land use is changed, will it have an adverse impact on social and economic activities?		X		
12. Will access to land and resources owned communally or by the state be restricted?		X		Public foot trail passes through the compound of some schools. The relocation of foot trail passes outside of the school compound (fencing) but within school's land (boundary) will be included in the project design
<b>Information on Displaced Persons:</b>				
Any estimate of the likely number of persons that will be displaced by the Project?				[ X ] No [ ] Yes
If yes, approximately how many? _____				
Are any of them poor, female-heads of households, or vulnerable to poverty risks?				[ X ] No [ ] Yes
Are any displaced persons from indigenous or ethnic minority groups?				[ X ] No [ ] Yes

### Annex 3: IP impact screening checklist of sample Schools (subprojects)

Impact on the indigenous peoples (IPs)/Ethnic Minority (EM)	Yes	No	Remarks or identified problems, if any
Are there any IPs or EM groups present in the project locations?		X	The field observation reveals that all the settlements/ clusters around the proposed schools are heterogeneous in terms of caste/ ethnicity and no specific territory of indigenous people has been observed and reported
Do they maintain distinctive customs or economic activities that may make them vulnerable to hardships?		X	The IPs share similar economic and political system with non-indigenous groups in terms of livelihood patterns, and access to health and educational opportunities. Children of the indigenous peoples and non-indigenous peoples both follow the similar modes of educational system
Will the project restrict their economic and social activity and make them particularly vulnerable in the context of the project?		X	No physical displacement and economic displacement (loss of land, assets, access to assets, income sources, or means of livelihoods) of indigenous people is anticipated as a result of implementation of the subprojects.
Will the project change their socio economic and cultural integrity?		X	The improved school facilities and disaster resilient school infrastructures built under the proposed project will be beneficial to the children of indigenous peoples who are among the students of the schools pursuing their basic and secondary education.
Will the project disrupt their community life?		X	Project will have no impact on IP's community life
Will the project positively affect their health, education, livelihood or social security status?		X	The improved school facilities and disaster resilient school infrastructures built under the proposed project will be beneficial to the children of indigenous peoples who are among the students of the schools pursuing their basic and secondary education
Will the project alter or undermine the recognition of their knowledge, preclude customary behaviours or undermine customary institutions?		X	The project activities neither directly nor indirectly affects the dignity, human rights, livelihood systems, or culture of indigenous people
In case no disruption of indigenous community life as a whole, will there be loss of housing, strip of land, crops, trees and other fixed assets owned or controlled by individual indigenous households?			neither physical displacement nor economic displacement will be occurred as a result of the project

### Anticipated Project Impacts on Indigenous Peoples

Project Activities & Outputs	Anticipated Positive effect	Anticipated Negative effect
Improvement of physical infrastructure of the existing school buildings to reduce disaster risk including improved facilities (e.g. class rooms, library and laboratories)	Beneficial to the children of indigenous peoples who are among the students of the schools pursuing their basic and secondary education	None

#### Annex 4: Balodaya SS

##### A: Details of the Land Availability and Requirements (Balodaya SS- Dolakha)

Details	Area (sqm)	Details	No.	Remarks
Total area of land owned by school as per land ownership certificate.	9045	Classroom Block: 3-C- 9	2	2x205 sqm
Total area of Land within existing school boundary	5201.95			
Total area of land required as per master plan	5201.95	Toilet Block: 1-T-5	1	35.36 sqm
Total area required for reconstruction	446.26			
Land ownership status of existing land				
i) With Land ownership certificate	9045	Septic Tank (ST-300) & Soak Pit (SP-300)	1	
ii) User right with local government or owner agency approval	NA			
iii) Voluntary donation by private owner	NA			
Area of additional land required to implement master plan	NA	Underground Water Tank	1	15000 L
How additional land arranged	NA			

[illegible]

## C: Minute of Meeting



आज मीले २०६४ ~~२५~~ २५ जून २५ श्री बालादेव मा  
 नि. को नि. ०४० को २ को केवळ समितिके अध्यक्ष श्री वृष्ण  
 बहादुर पाखोने के अध्यक्षतामा वकी तपस्वीले आदुशा को  
 प्रस्तावद्वारा मा धी कलापुल गरी वितीय गरियो।

तपस्वीले

- १) श्री कृष्ण बं. पाखोने (अध्यक्ष) रु. ०५
- २) श्री कालुमान धामी रु. ०५
- ३) श्री चन्द्रमाया धामी रु. ०५
- ४) श्री चन्द्रकला धामी रु. ०५
- ५) श्री प्रफुल्ल पाखोने रु. ०५
- ६) श्री चन्द्रमाया धामी रु. ०५
- ७) श्री राध. बं. २ लागाड रु. ०५
- ८) श्री मित. बं. धामी (अध्यक्षी) रु. ०५
- ९) श्री बालुमान धामी (पदेन अध्यक्ष) रु. ०५
- १०) श्री कुमलबं. पाखोने (अध्यक्षी) रु. ०५

अथ उपस्थित मान्यमान्यः:-

- १) श्री लालदेव धामी रु. ०५
- २) श्री निर. बं. धामी रु. ०५
- ३) अश्वि के तमाड रु. ०५
- ४) बालकृष्ण धामिनेवा रु. ०५
- ५) प्रफुल्ल धामी (अध्यक्षी) रु. ०५
- ६) उषा बं. धामी रु. ०५
- ७) सरस्वती खोनेवाडा रु. ०५
- ८) प्रेम कुमार धामी रु. ०५
- ९) पुष्पा धामी रु. ०५
- १०) सुभाष धामी रु. ०५
- ११) देवी बस्नेले (अध्यक्षी) रु. ०५
- १२) इन्द्र मिश्र (अध्यक्षी) रु. ०५
- १३) मधुसूदन शायक (अध्यक्षी) रु. ०५



प्रस्तावः

१) विद्यालय पुनर्निर्माण समूह द्वारा

प्रस्ताव लघु विद्यालय नं. १ माझी हलपुल जर्दी अर्ध डेल्टा जिला कालिग चौक गाव पालिका वडा नं. १ स्मीत की वल्लौख मा. वि. मा. विद्यालय अवन पुनर्निर्माण गर्ने CLP/IV/ADB/ NRA को संलग्न गमा EPMC JV को प्रस्ताव अनुसार बन्ने विद्यालय अवनको लागी आवश्यक पर्ने अउग निरधारण द्वारा उपलब्ध गराउने प्रतिवद्धता साथै अर्ध विद्यालयको गौ. व. २०६२ सालको अर्ध रेन्ड अनुसार खालउमा हेरिने उमा. - पक्षमा क्षेत्र संख्या १४६ र क्षेत्र संख्या १३३ गरी जम्मा २८२ अर्धो नुमत काट निर्धार पातु पारित गरियो।

लेख  
महेश्वर  
काय





D: Existing Site Plan

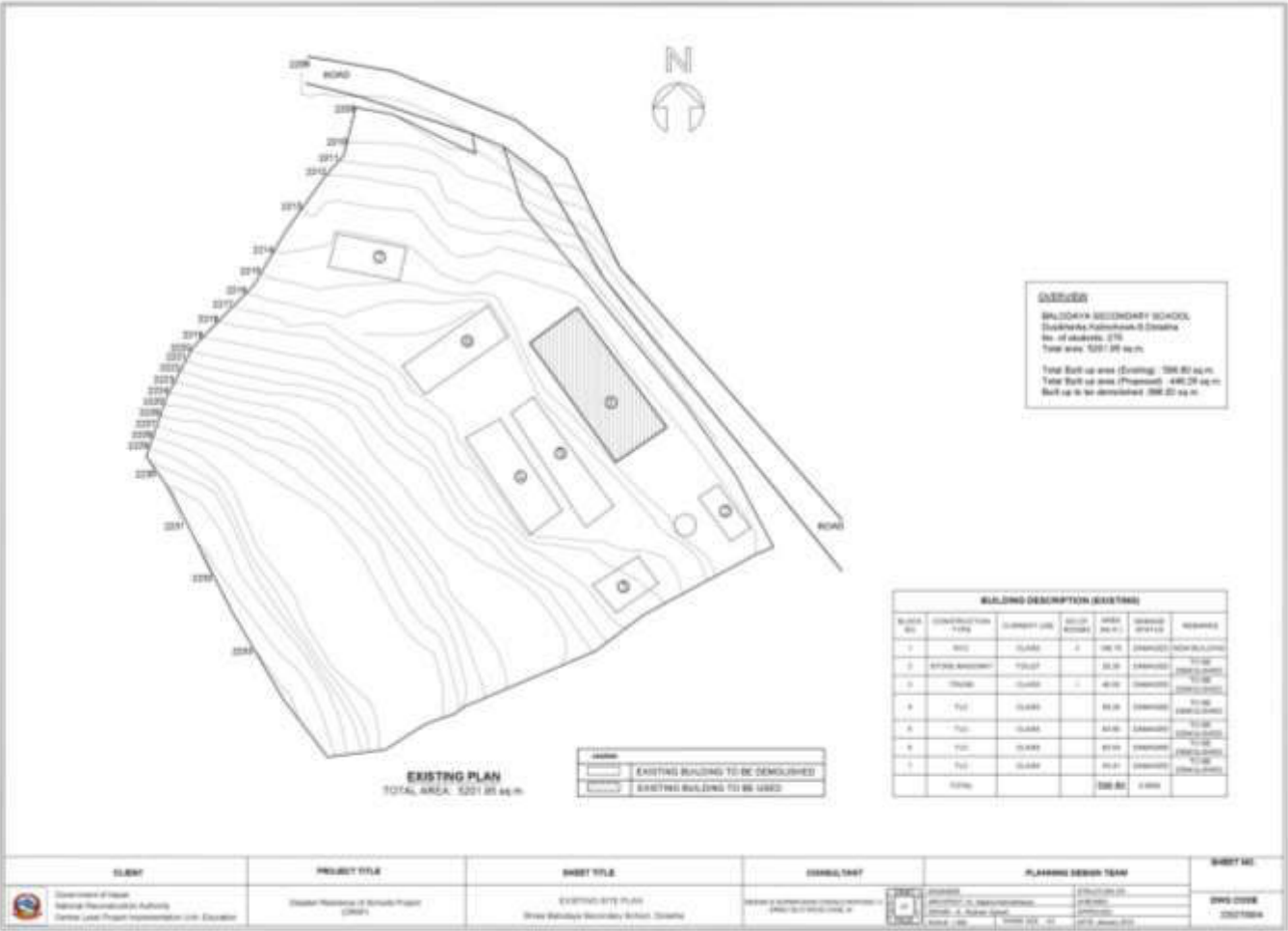

## E: Proposed Master Plan

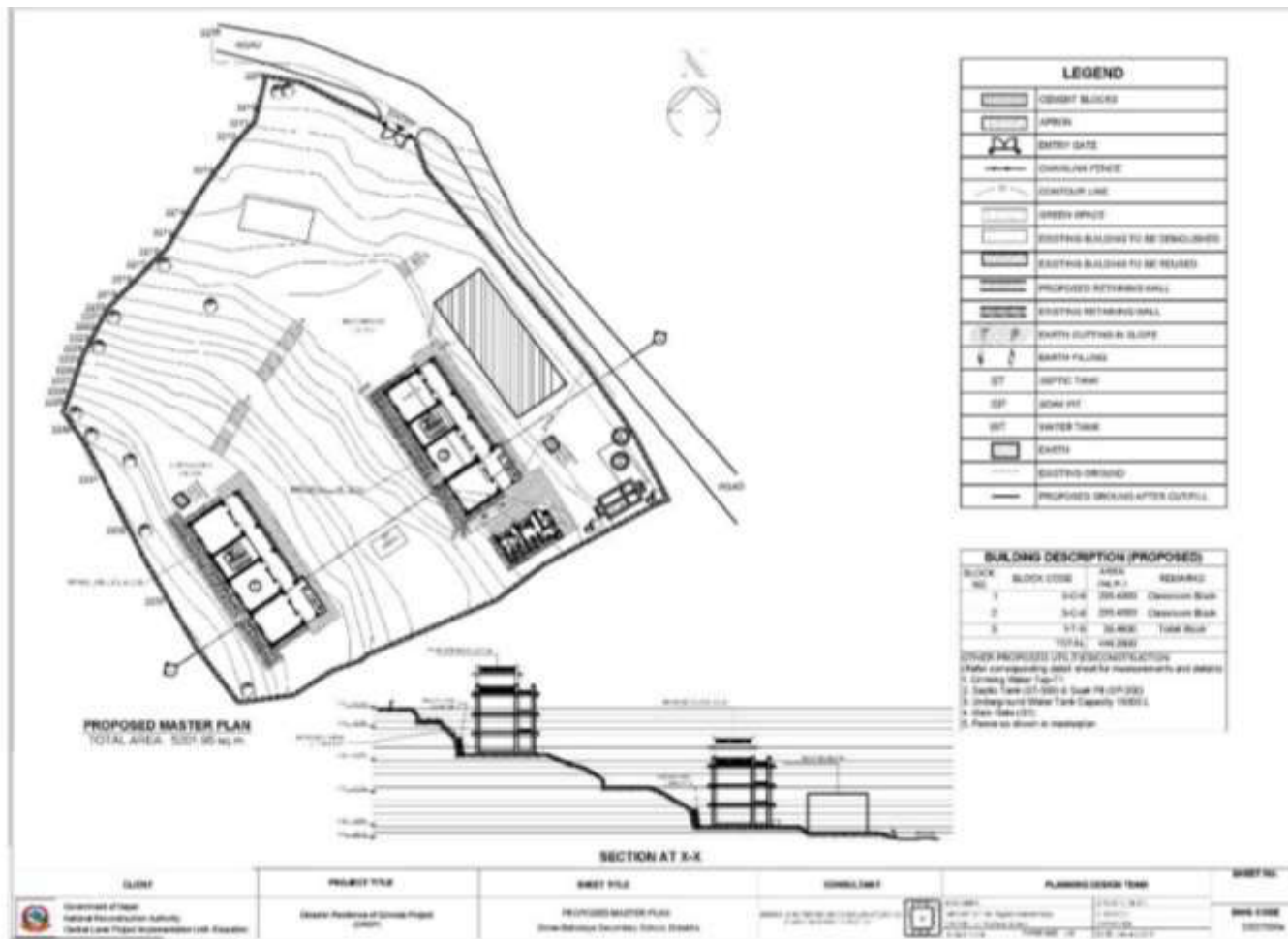

## Annex 5: Devi SS

### A: Details of the Land Availability, Requirements and Proposed Structures

Details of Land	Area (sqm)	Details	No.	Remarks
Total area of land owned by school as per land ownership certificate.	2930	Classroom Block: 3-C- 9	2	152.9 sqm
Total area of Land within existing school boundary	2793.63			
Total area of land required as per master plan	2793.63			
Total area required for reconstruction	434.4	Toilet Block: 1-T-5	1	23 sqm
Land ownership status of existing land				
i) With Land ownership certificate	2930	Septic Tank (ST-300) & Soak Pit (SP-300)	1	
ii) User right with local government or owner agency approval	NA			
iii) Voluntary donation by private owner	NA			
Area of additional land required to implement master plan	NA	Underground Water Tank	1	15000 L
How additional land arranged	NA			

**B: Land Ownership Certificate**

**भीमेश्वर नगरपालिका**  
**चरीकोट, दोलखा**

सं. १०८२/१०८३/१०८४  
२०७३/०८/०९

सु. मं. प्रमुख, नगरपालिका

सं. १०८२/१०८३/१०८४

मिति: २०७३/०८/०९

जो जससंग सम्बन्ध छ ।

विषय :- भिफार्म गरिएको बारे ।

एस्तै विषयमा यस नगरपालिका वडा नं. ८ स्थित देवी माध्यमिक विद्यालय बाथ भवनको क्षेत्र नं. ९ को वि. नं. २९ को जग्गा विगत २०६२ सालदेखि विद्यालयन भागधनन गर्दै प्रयोजन हाल उक्त विद्यालय भवन निर्माण (XDI NEAH) ले सम्पूर्ण डिजाइन नक्सा (DPR) वमोजिम मोही किल्ला विद्यालय भवन निर्माणको फरक नरने भएकोले मोही च्यापरा भिफार्ममाथ प्रनुरोध छ ।

  
नगर प्रमुख

बोधार्थ  
श्री देवी माध्यमिक विद्यालय,  
बोच, दोलखा





## C: Minutes of Meeting



આજ પ્રતિ ૨૦૧૨ સન ડાલ્ગુન ૧૨ ગેતે આઠતવાઠો દિન યજ  
દેવી માન્કિ પ્રી ન.પા-૮, વેચઠો વિન્ધ્યાય. વેઠઠ અધ્યક્ષા શ્રી મુવન  
કે.સી.કો ઇચ્છાસતપ્રા વણે તપાયેલમા હેચિણ પ્રસાવ પ્રાચે ફલફલગરિ  
નિર્ણય સમેત ગણિયો.

### ઉપસ્થિતિ

અધ્યક્ષ - શ્રી મુવન કે.સી.  
સહાય (વડાધ્યક્ષ) શ્રી નકુલ કે.સી.  
સહાય - શ્રી કલ્પતા વસંતે  
સહાય - શ્રી વિદ્યુકુમાર મુન્સ  
સહાય - શ્રી જાન તપાડ  
સહાય - શ્રી અશ્વિતા કાર્તી  
સહાય - શ્રી ઘનલક્ષ્મી તપાડ  
સહાય (ગ્રિફ્થ પ્રતિનિધિ) શ્રી પ્રીયલેન કે.સી.  
સહાયદાચિવ (પ્ર.અ.) શ્રી વિશ્વેશ્વર દહલ

### પ્રસ્તાવ તથા નિર્ણયસ્થ :

#### ૧. અનુરોધ ગૌર સમન્ધમા ?

પ્રસ્તાવ નં. ૧ પ્રાચે ફલફલગદી ૨૦૧૨ વૈરાસ ૧૨.૧૬૨ ૨૨ ગેતે  
વિતાસઠરી મુકમ્પઠો કારણ વિદ્યાલયઠા ૨૧ કૌઠા મુવન ર્ણા કાપા કાતિ  
મ્પઠો ર ફાલ યમ્પ રાઠ્ઠિય પુનર્નિર્માણ રૂકાર (મિશ્રા) તાટ આઠ કૌઠા ર  
વિદ્યાલયઠો આમ્પે કોલ્કાર દુરકોઠા નિર્માણ ગરી ૧૦ કોરા માત્ર પાવ્કિ મુવન  
મ્પઠો તથા વાલવિઠાય દેલિ ૧૨ કુદા સમ્પ સન્ધાલિત મ્પ વિદ્યાલયમા કુદા  
કોદાકો અમ્પલે વિદાની યત્ર ર દિવાયત્ર ગરી વિદ્યાલય દુરક યત્રમા સન્ધ  
લિત રદેકો ર ઇચ્છ પદાડી મુમ્પમા અમ્પલિત યજ વિદ્યાલય વિદાનીક  
સન્ધાલમ સમેત ચિઠોકો કારણ પ્રમાવિત મ્પઠો ર આમ્પે કુતલે કુદાકો  
નિર્માણ ગર્મ નસમ્પે ર મિશ્રા અવધિ સમેત પાલ્કમ્પલે તેલે કમોઝિપ્રદ્ધ  
ગૌર નસકિલ્કો અઠારો સમેત અનુરોધ ગૌર ર્ણા અધ્યાકા યાથ આવમ્પક  
પાવ્કિ કુદાકોઠા નિર્માણ ગરિકિતુ દુરકાલિ અનુરોધ ગૌર નિર્ણય ગણિ  
ક મુવન નિર્માણ સમન્ધમા ?

પ્રસ્તાવ નં. ૨ પ્રાચે ફલફલગદી અમ્પ પ્રતિ ૨૦૧૨ સન  
ડાલ્ગુન ૧૨ ગેતે વસેઠો વિન્ધ્યાય. કો વેઠઠલે અમ્પ વિદ્યાલયમા DLD

W/ NEAAB को सम्मोचना ERMCTV को डिजिटल अनुसार वने  
विद्यार्थी प्रवर्तन लाने आवधिक पौ जग्गा उपलब्ध जराइने निर्णय  
जाइयो ।

२, सर्व सम्मान भएँ सम्मोचना ?  
प्रस्ताव न. ३ माथि इलाकले जर्दा अज नयेको वि. वि. वि. को  
वेल्फेयर वि. वि. वि. को पाविके प्रवर्तन निर्माण लाने नखुजक वृद्धत  
सर्व सोली धारा मिति २०७८।११।१२ गतेका दिन सर्व भएँ निर्णय  
सम्मानित जाइयो ।

### D. Existing Site Plan



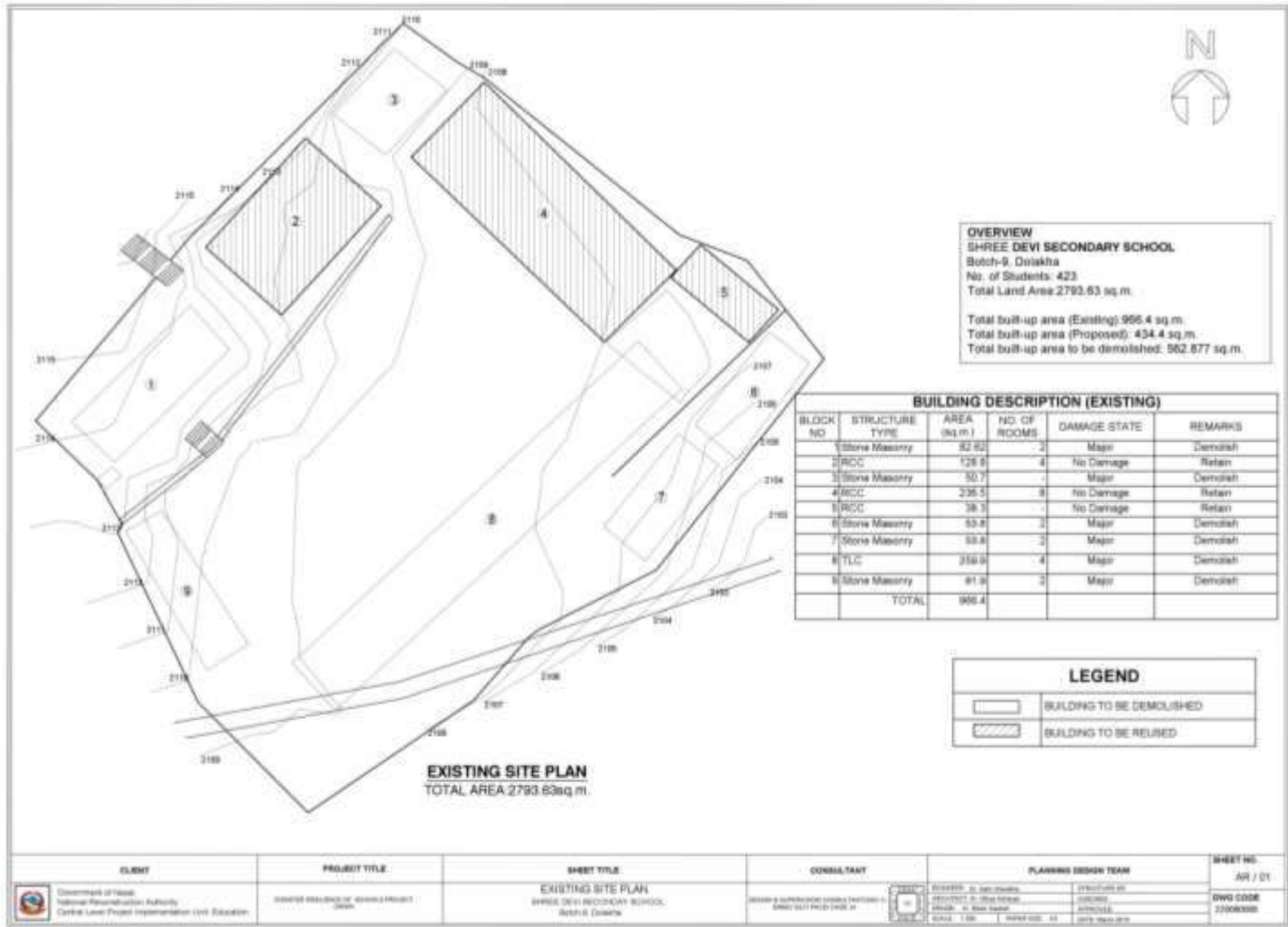

## E: Proposed Master Plan



## Annex 6: Thampu SS

### A. Details of the Land Availability, Requirements and Proposed Structures

Details of Land	Area (sqm)	Details	No	Remarks
Total area of land owned by school as per land ownership certificate.	830	Classroom Block: 3-C- 9	1	205 sqm
Total area of Land within existing school boundary	830			
Total area of land required as per master plan	830			
Total area required for reconstruction	249.72	Toilet Block: 1-T-5	1	44.32 sqm
Land ownership status of existing land				
i) With Land ownership certificate	830	Septic Tank (ST-300) & Soak Pit (SP-300)	1	
ii) User right with local government or owner agency approval	NA			
iii) Voluntary donation by private owner	NA			
Area of additional land required to implement master plan	NA	Underground Water Tank	1	15000 L
How additional land arranged	NA			

## B: Land Ownership Certificate

[illegible]

162039

સરકાર  
વ્યવસ્થા મંત્રાલય  
વ્યવસ્થાપન વિભાગ  
પ્રમાણ પૂર્ણ

નવાન  
મુનિમુખાર તથા  
નમિમુખાર તથા  
જગાધની દત્તા

ક્રમ નં.	વિનય	વરણીકા ના નં.	પ્રકાર નં.	કિલો નં.	કિલો ના નં.	કિલો ના નં.	કિલો ના નં.	કિલો ના નં.
1	162039	162039	162039	162039	162039	162039	162039	162039
2	162039	162039	162039	162039	162039	162039	162039	162039
3	162039	162039	162039	162039	162039	162039	162039	162039
4	162039	162039	162039	162039	162039	162039	162039	162039
5	162039	162039	162039	162039	162039	162039	162039	162039
6	162039	162039	162039	162039	162039	162039	162039	162039
7	162039	162039	162039	162039	162039	162039	162039	162039
8	162039	162039	162039	162039	162039	162039	162039	162039
9	162039	162039	162039	162039	162039	162039	162039	162039
10	162039	162039	162039	162039	162039	162039	162039	162039

ક્રમ નં.	વિનય	વરણીકા ના નં.	પ્રકાર નં.	કિલો નં.	કિલો ના નં.	કિલો ના નં.	કિલો ના નં.	કિલો ના નં.
1	162039	162039	162039	162039	162039	162039	162039	162039
2	162039	162039	162039	162039	162039	162039	162039	162039
3	162039	162039	162039	162039	162039	162039	162039	162039
4	162039	162039	162039	162039	162039	162039	162039	162039
5	162039	162039	162039	162039	162039	162039	162039	162039
6	162039	162039	162039	162039	162039	162039	162039	162039
7	162039	162039	162039	162039	162039	162039	162039	162039
8	162039	162039	162039	162039	162039	162039	162039	162039
9	162039	162039	162039	162039	162039	162039	162039	162039
10	162039	162039	162039	162039	162039	162039	162039	162039



# C: Minutes of Meeting



२०७३ साल - ३

गिति - २०७३ साल कार्तिक १८ गतेको दिन मा श्री धर्म शास्त्रि विजय शास्त्रि वर्य वर्य - ६ कालमा कोलकाता विष्णु मठ विष्णु मठ अखण्ड श्री सिंग बहादुर शास्त्रीको अध्यक्षतामा बैठक श्री लक्ष्मण शास्त्रि वर्य वर्यको अध्यक्षतामा गरियो।

उपस्थिति

- १) अध्यक्ष - श्री सिंग बहादुर शास्त्री
- २) सदस्य - श्री पद्म शास्त्री
- ३) " - श्री रत्न बहादुर शास्त्री
- ४) " - श्री स्वामी शास्त्री
- ५) " - श्री अरुण शास्त्री
- ६) " - श्री अरुण बहादुर शास्त्री
- ७) " - श्री वेद बहादुर शास्त्री
- ८) " - श्री रत्न शास्त्री
- ९) " - श्री रामेश्वर शास्त्री
- १०) " सचिव - श्री अरुण बहादुर शास्त्री

आगमन

- १) श्री पद्म बहादुर शास्त्री
- २) श्री पद्म वर्य शास्त्री (रा.प. अखण्ड)
- ३) श्री गिरजा शास्त्री
- ४) श्री अरुण शास्त्री
- ५) श्री अरुण शास्त्री (रा.प. अखण्ड)
- ६) श्री अरुण शास्त्री (रा.प. अखण्ड)

अध्यक्ष

१) अरुण शास्त्री वर्य वर्य



निर्णय नं.- १ को मसलन नं.- १ माघि अहम कयमा  
 कलकल गऊ पदु निबालमगा AEBICLPZU/NRA को  
 सहयोगा ERMCTU को सेकाइज कयमा कने दिबा-  
 कय गवनको लागि अउरशुक्त पने जग्गा निबालम कयमाउत य-  
 न उपलब्ध गपडेने निर्णय एवं सहपत्तिका प्रस्ताव माघि  
 हुलकल निर्णय पालि गयिगे

निर्णय नं.- २ को मसलन नं.- २ माघि अहम कयमा हुल-  
 कल गऊ पदु निबालमगा AEBICLPZU/NRA को सह-  
 योगा ERMCTU को सेकाइज कयमा कने दि-  
 बालम गवनको लागि निर्णय - २०८५/०६/१९ गतेका दिन  
 Setn। एवं ५ माघे परिकल्प ठाम हुमलन गएको निर्णय  
 एवं सहपत्तिका प्रस्ताव माघि हुलकल गार निर्णय पालि  
 गयिगे

*Handwritten signatures and initials*



## D: Existing Site Plan

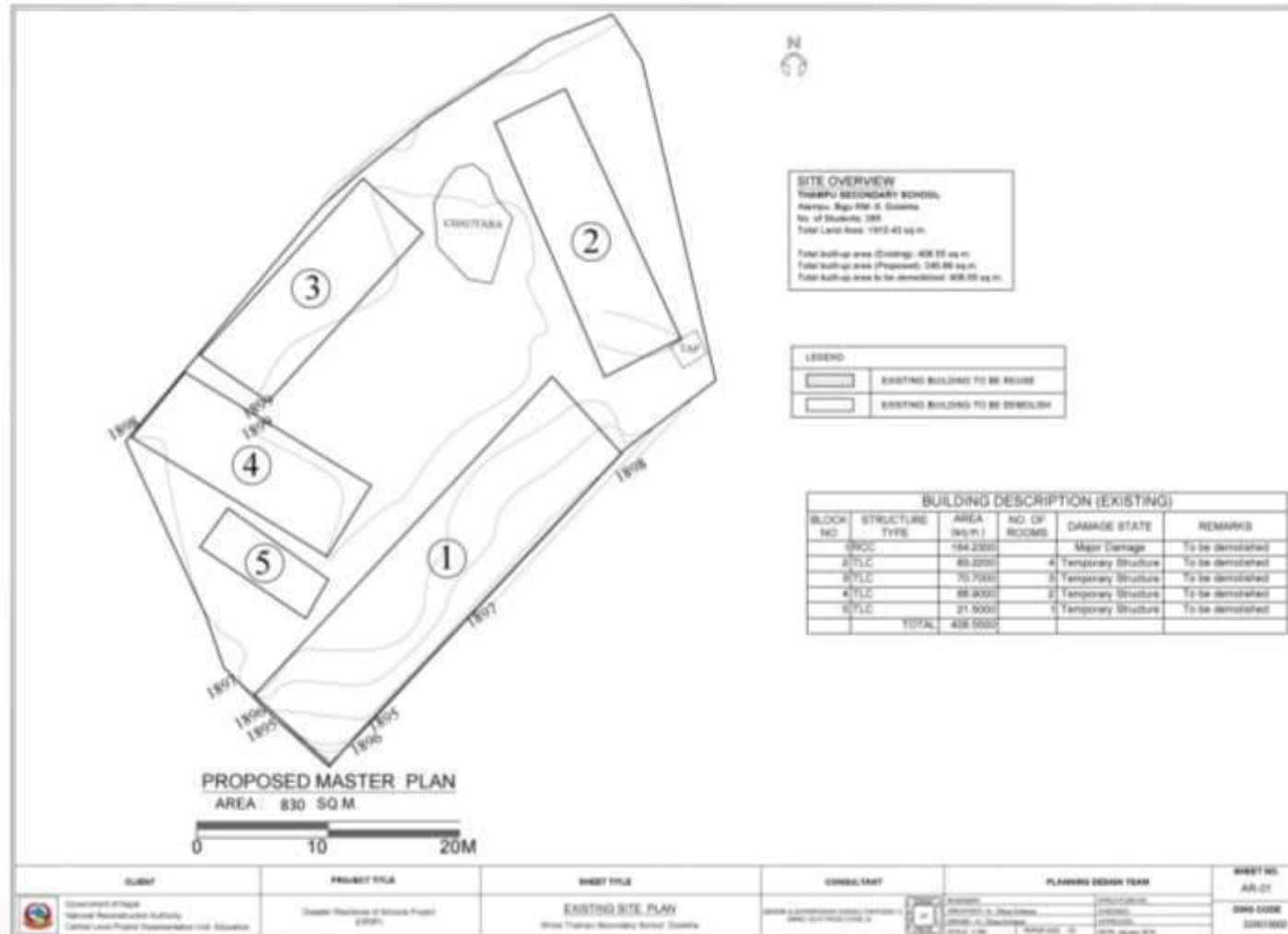

## E: Proposed Master Plan

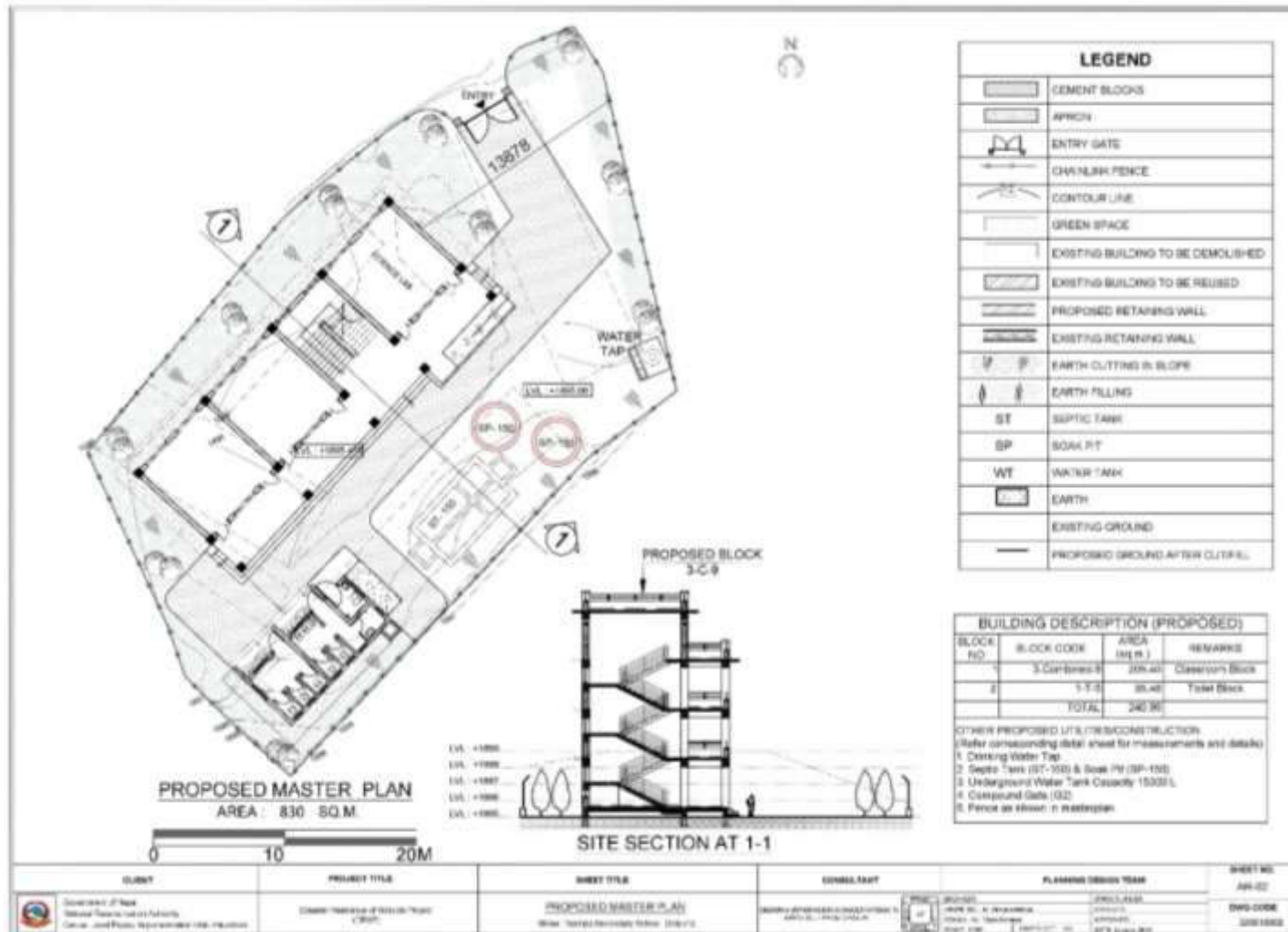



## Annex 7: Lapilang SS

### A: Details of the Land Availability, Requirements and Proposed Structures

Details of Land	Area (sqm)	Details	No.	Remarks
Total area of land owned by school as per land ownership certificate.	1230	Classroom Block: 3-COMB-22	1	338.96 sqm
Total area of Land within existing school boundary	847.45			
Total area of land required as per master plan	847.45	Septic Tank (ST-400) & Soak Pit (SP-400)	1	
Total area required for reconstruction	338.96			
Land ownership status of existing land		Underground Water Tank	1	15000 L
i) With Land ownership certificate	1230			
ii) User right with local government or owner agency approval	NA	Classroom Block: 3-COMB-22	1	338.96 sqm
iii) Voluntary donation by private owner	NA			
Area of additional land required to implement master plan	NA	Septic Tank (ST-400) & Soak Pit (SP-400)	1	
How additional land arranged	NA			

## B: Land Ownership Certificate

Land Ownership Certificate

Land No. \_\_\_\_\_

Area \_\_\_\_\_

Owner's Name \_\_\_\_\_

Address \_\_\_\_\_

Signature \_\_\_\_\_

Date \_\_\_\_\_

No.	Name of the Owner	Area (Acres)	Value (Rs.)	Remarks
1				
2				
3				
4				
5				
6				
7				
8				
9				
10				
11				
12				
13				
14				
15				
16				
17				
18				
19				
20				
21				
22				
23				
24				
25				
26				
27				
28				
29				
30				
31				
32				
33				
34				
35				
36				
37				
38				
39				
40				
41				
42				
43				
44				
45				
46				
47				
48				
49				
50				
51				
52				
53				
54				
55				
56				
57				
58				
59				
60				
61				
62				
63				
64				
65				
66				
67				
68				
69				
70				
71				
72				
73				
74				
75				
76				
77				
78				
79				
80				
81				
82				
83				
84				
85				
86				
87				
88				
89				
90				
91				
92				
93				
94				
95				
96				
97				
98				
99				
100				

## C: Minutes of Meeting

[illegible]

## D: Existing Site Plan

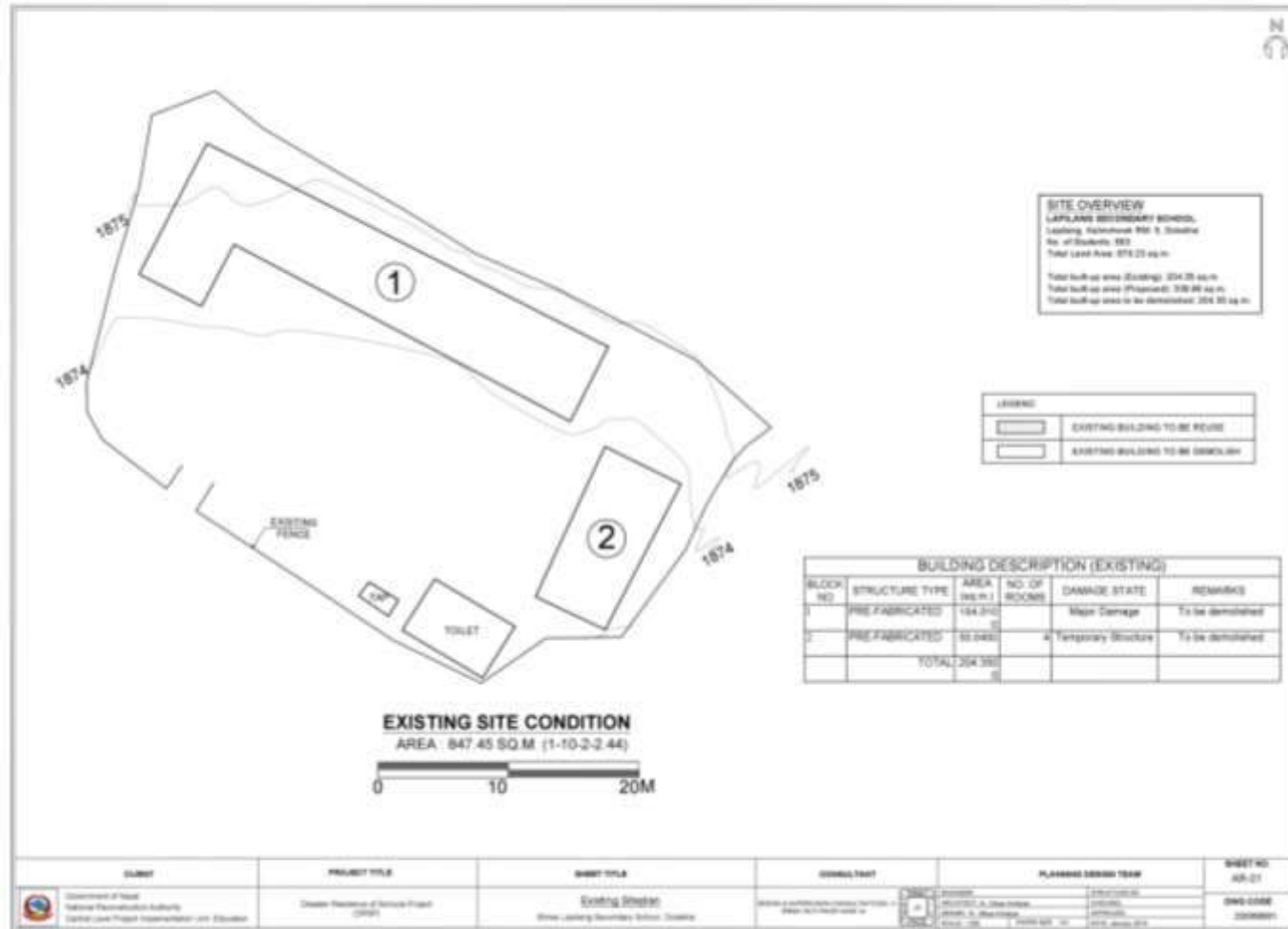

## E: Proposed Master Plan

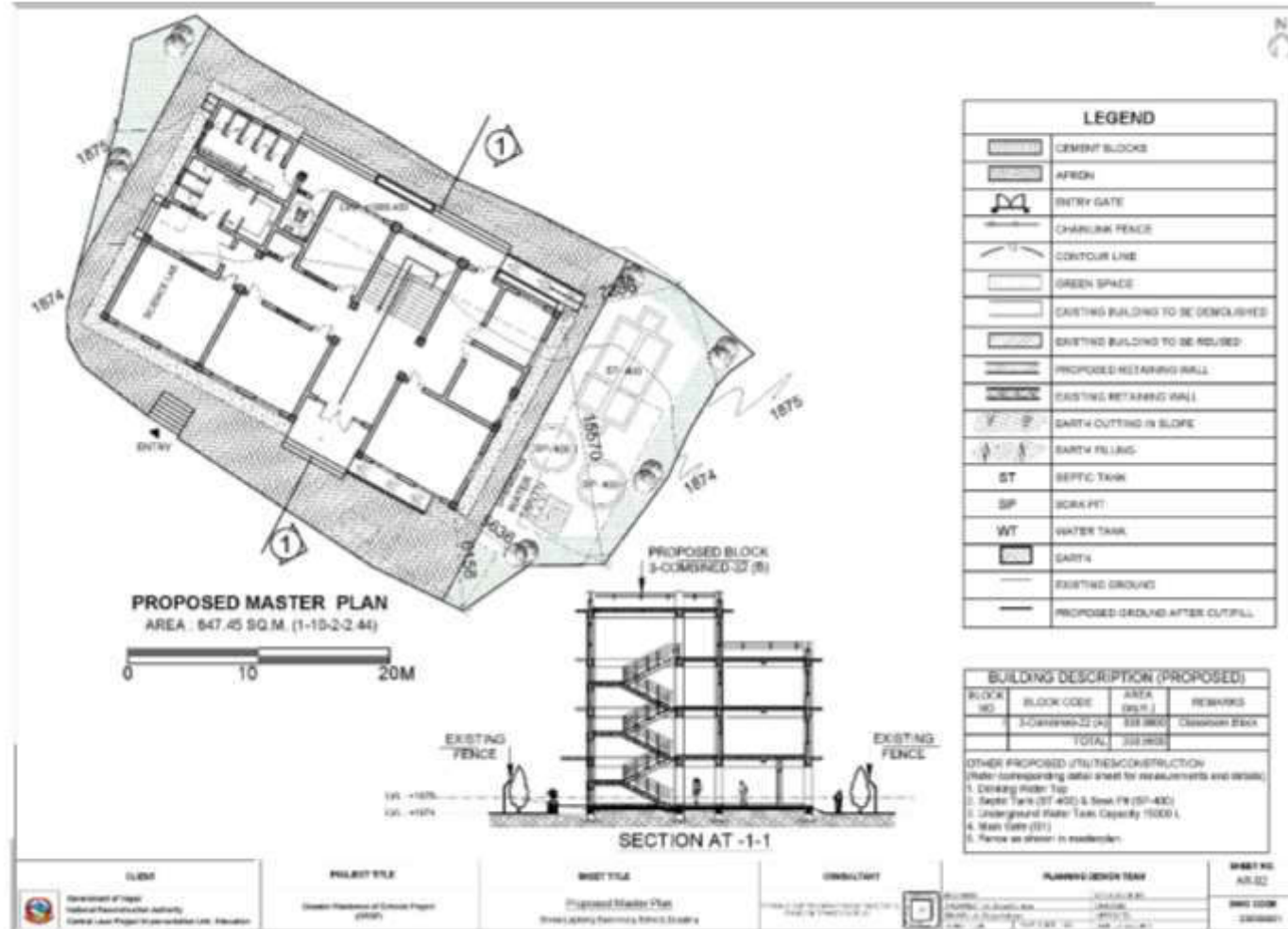

### Annex 8: Pashupati Kanya SS

#### A: Details of the Land Availability, Requirements and Proposed Structures

Details of Land	Area (sqm)	Details	No.	Remarks
Total area of land owned by school as per land ownership certificate.	3608	Classroom Block: 3-C- 9	1	205 sqm
Total area of Land within existing school boundary	3157.14			
Total area of land required as per master plan	3157.14			
Total area required for reconstruction	240.86	Toilet Block: 1-T-5	1	39.89 sqm
Land ownership status of existing land				
i) With Land ownership certificate	3608			
ii) User right with local government or owner agency approval	NA	Septic Tank (ST-250) & Soak Pit (SP-250)	1	
iii) Voluntary donation by private owner	NA			
Area of additional land required to implement master plan	NA	Underground Water Tank	1	15000 L
How additional land arranged	NA			

#### B: Land Ownership Certificate





आज दिनि २०७८ साल अक्टोबर ७ गते यस को प्रमुखीद्वारा मन्त्रि-को विद्यालय सम्वन्धित समिति को बैठक समिति को अध्यक्ष श्री हरिद्वारा त्रिलोचनी को अध्यक्षतामा कमी तथ्यको सम्वन्धित प्रस्तावहरूमा हलफल गरी लागू गर्ने कमी जिम्मा निर्धारण गरियो।

#### उपस्थित

१. अध्यक्ष : श्री हरिद्वारा त्रिलोचनी
२. सचिव : श्री विष्णु शर्मा
३. " : श्री सुनिल शर्मा
४. " : श्री प्रेमबहादुर शर्मा
५. " : श्री विष्णु शर्मा
६. " : श्री दामोदर शर्मा
७. शिक्षक प्रतिनिधि : श्री युग प्रसाद शर्मा
८. सचिव समिति : श्री जतिराम शर्मा

#### प्रस्ताव

१. आज उपलब्ध भएको सम्बन्धित
२. गते प्रयोग (Soil test) सम्बन्धित सम्बन्धित
३. अनुसन्धान सम्बन्धित सम्बन्धित
४. अतिरिक्त शैक्षिक संस्था निर्माण सम्बन्धित

#### निर्णय

१. प्रस्ताव नं १ को हलफल गरी यस विद्यालयको लागि CLP/VIAD को सहयोगमा ERM JV को डिजाइन गर्ने विद्यालय अवस्था लागि जमा उपलब्ध गराउने निर्णय गरियो।

२. प्रस्ताव नं २ को हलफल गरी यस विद्यालयको लागि निर्माणको लागि ERM JV को प्राविधिक सेवा-सहित तथ्य Soil test सम्बन्धित भएकोले सोको



[illegible]

28 Feb 90

~~12/1/18~~



## 10.1 Existing Site Plan

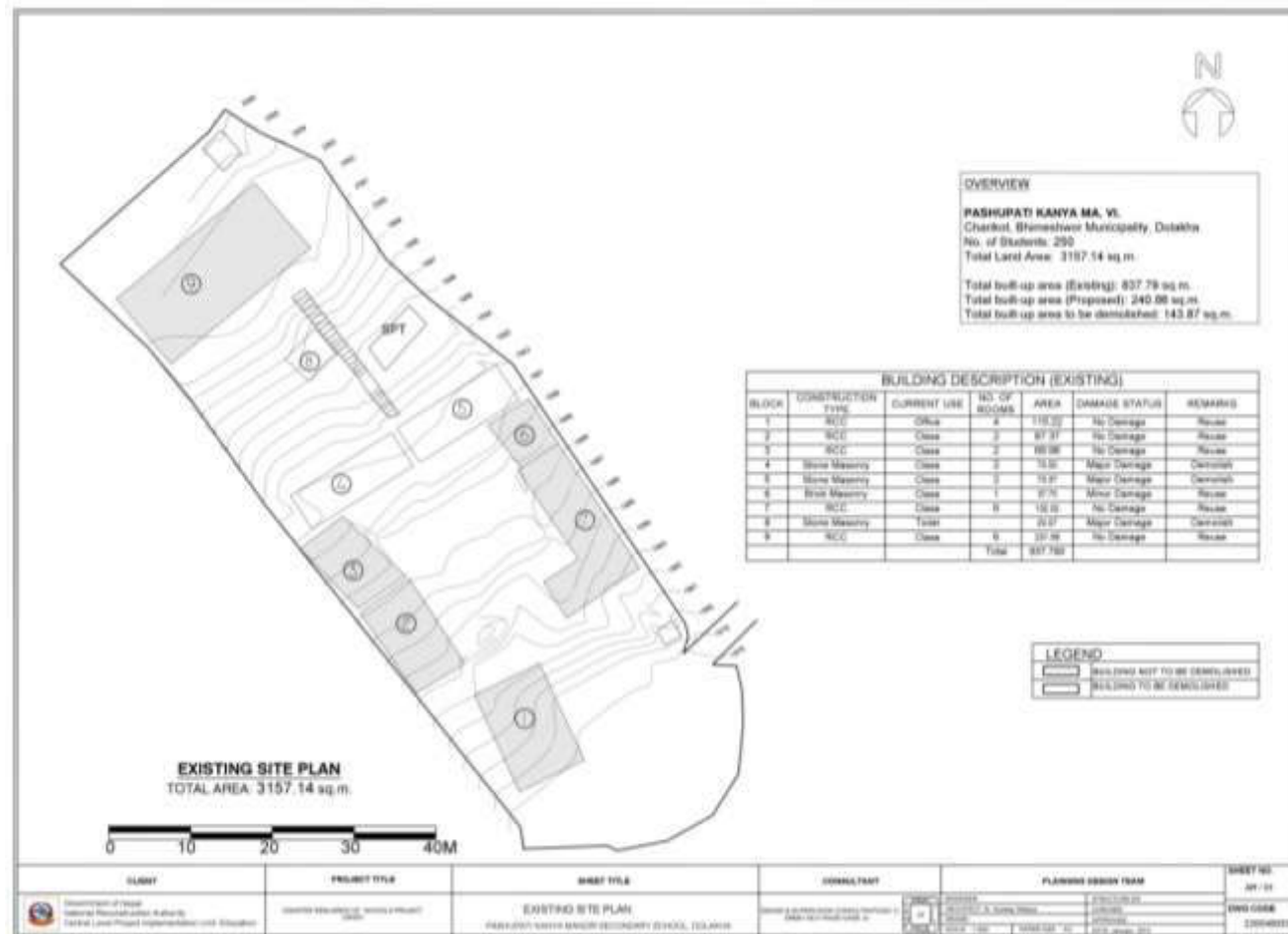

10.2

### 10.3 Proposed Master Plan

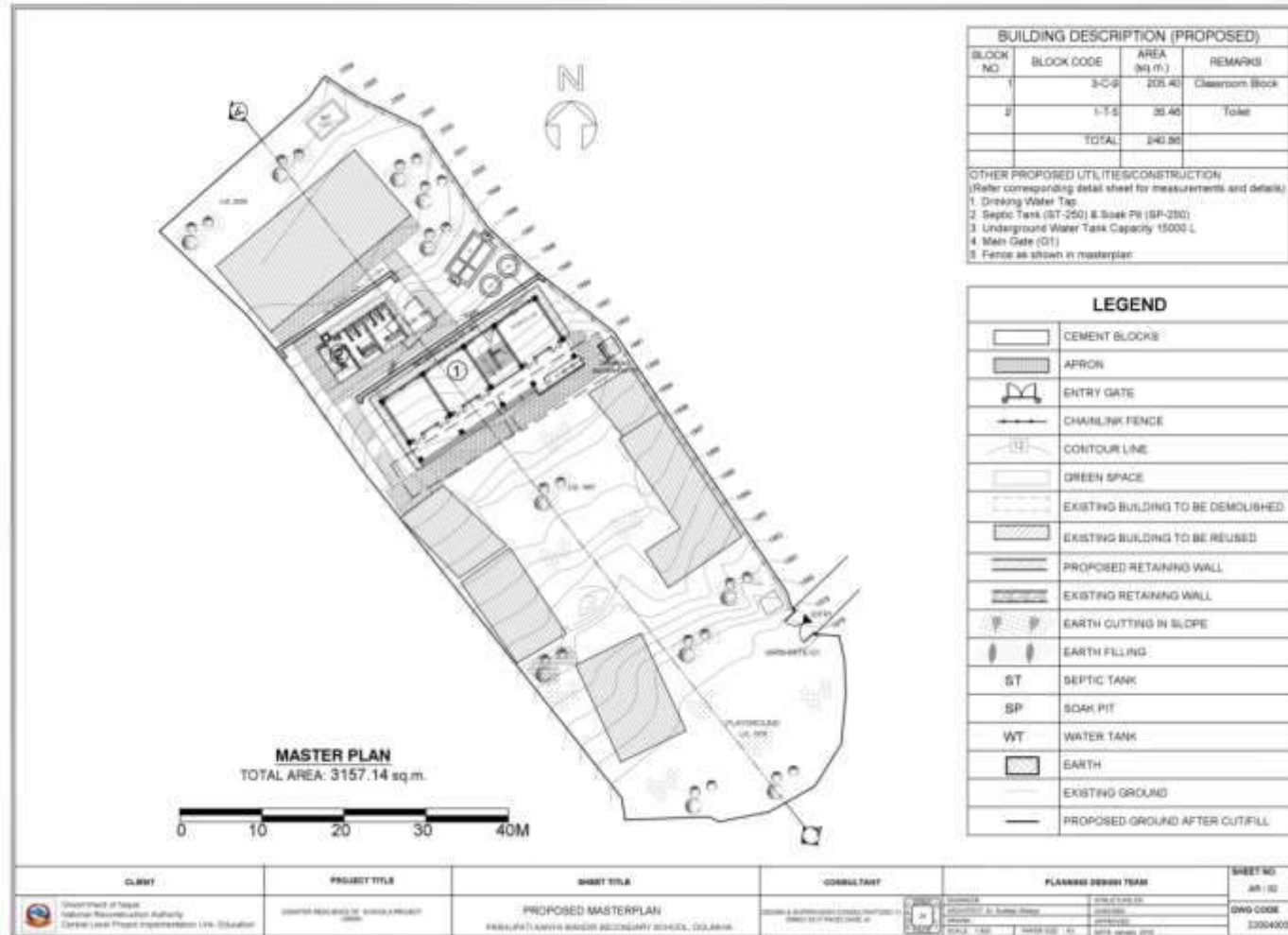

## Annex 9: Sarada SS

### A: Details of the Land Availability, Requirements and Proposed Structures

Details of Land	Area (sqm)	Details	No.	Remarks
Total area of land owned by school as per land ownership certificate.		Classroom Block: 3-C- 9	2	2x205 sqm
Total area of Land within existing school boundary	9956.8			
Total area of land required as per master plan	9956.8	Toilet Block: 1-T-5	1	35.46 sqm
Total area required for reconstruction	446.26			
Land ownership status of existing land				
i) With Land ownership certificate		Septic Tank (ST-300) & Soak Pit (SP-300)	1	
ii) User right with local government or owner agency approval	20349.48			
iii) Voluntary donation by private owner	NA			
Area of additional land required to implement master plan	NA	Underground Water Tank	1	15000 L
How additional land arranged	NA			

### B: Users Right Document



# फलाम पोखरी सामुदायिक वन उपभोक्ता समूह



पत्र संख्या : 062/062

चलायी नं. : 04

मिति : 2062/19/10

विषय :- जो जस सग सम्बाधक।

श्री झारफा मा.वि. मं. ६  
झोलुङ्गेवा. कोतवा

उपरोक्त विषयमा कोतवा जिल्ला झोलुङ्गेवा  
गा.वि.सं. ६ मा मिति २०५८ साल देखी शा-  
रदा मा.वि. को मा.वि. २ नि. मा.वि. कक्षा स-  
ञ्चालन यस फलामपोखरी सामुदायिक वन उप-  
झोलुङ्गेवा को सग भित्र पूर्व भू-मलुङ्गेवा  
पश्चिम जहात हिं काको को साथ उक्त कुंछ  
हिं तमाङ्ग साथ दक्षिण भेस वगा भित्र रहेको  
करिब ४० रोपती जग्गा यस सामुदायिक वन क्षेत्र  
वाट भोक्ताधिकार गर्न दिने २०६३ साल को आदेश  
भेल। वाट तिनीस भरेकोल यो पत्र प्रदान गरिएको  
छ।

*(Signature)*

अध्यक्ष :- दिपक भुजेल



राधादिनि

अनुसूचित जाति के लिए 24% आरक्षण

2) सदस्य :- लिला नारायण/ जेठ

ਸ੍ਰੀ ਸ਼ਾਕਤੀ : ਸ਼ਾਕਤੀ ਸ਼ਾਕਤੀ ਸ਼ਾਕਤੀ

५. व्यवस्था : विद्यार्थी छात्राणां संख्या

६) सदस्य : कानून उपर

6) सर्वोपनिषद् सामान्य : मानव समाज (सामाजिक) के

१२०३३

5) वेद का नामाङ्कः वेद १०. २४. अनाज आयाज्य - अनाज

अनं का तमः (मि.स.७)

19) विनोद क्या हाता 11 1

४) तबराज आन्योधि ( ११ )

8/15/19

॥ श्री गुरुभ्यो नमः ॥

6) अहं नः आपा

नवरात्रि का दिन

01. मोन at 26/11/2021

2) समझो कि काहें  मं.

प्राप्त ३२२१

निर्णय नं १

प्रेस्नान नं १३५१ व्यापक रुपमा धनकुला गङ्गा ८/१७०

PROBATIONER

आयुर्वेदशास्त्रेण चिकित्सायां प्रयुज्यमानाः अस्मिन्

आ/ १/३५३ निरालाकारिये ।

પ્રસ્તાવ નં ૨. સર્વેસર્વ તથા માટે પરીક્ષણ સ્વતંત્રતા !  
નિર્ણય નં ૨

પ્રસ્તાવ નં ૨ માંથી દલકાત ગદા આજુ મિત્ર  
૨૦૬૮ વ્સાલ મંચિર ૬ ગેટ યસ વિધાલય મનન વૃત્તે હાઉ  
વિસ્તૃત સર્વેસર્વ તથા માટે પરીક્ષણ ગર્તે ક્રાપે સ્વતંત્રતા  
નિર્ણય ગર્તે સ્વતંત્રતા ગર્તે.

૨.



## D: Existing Site Plan

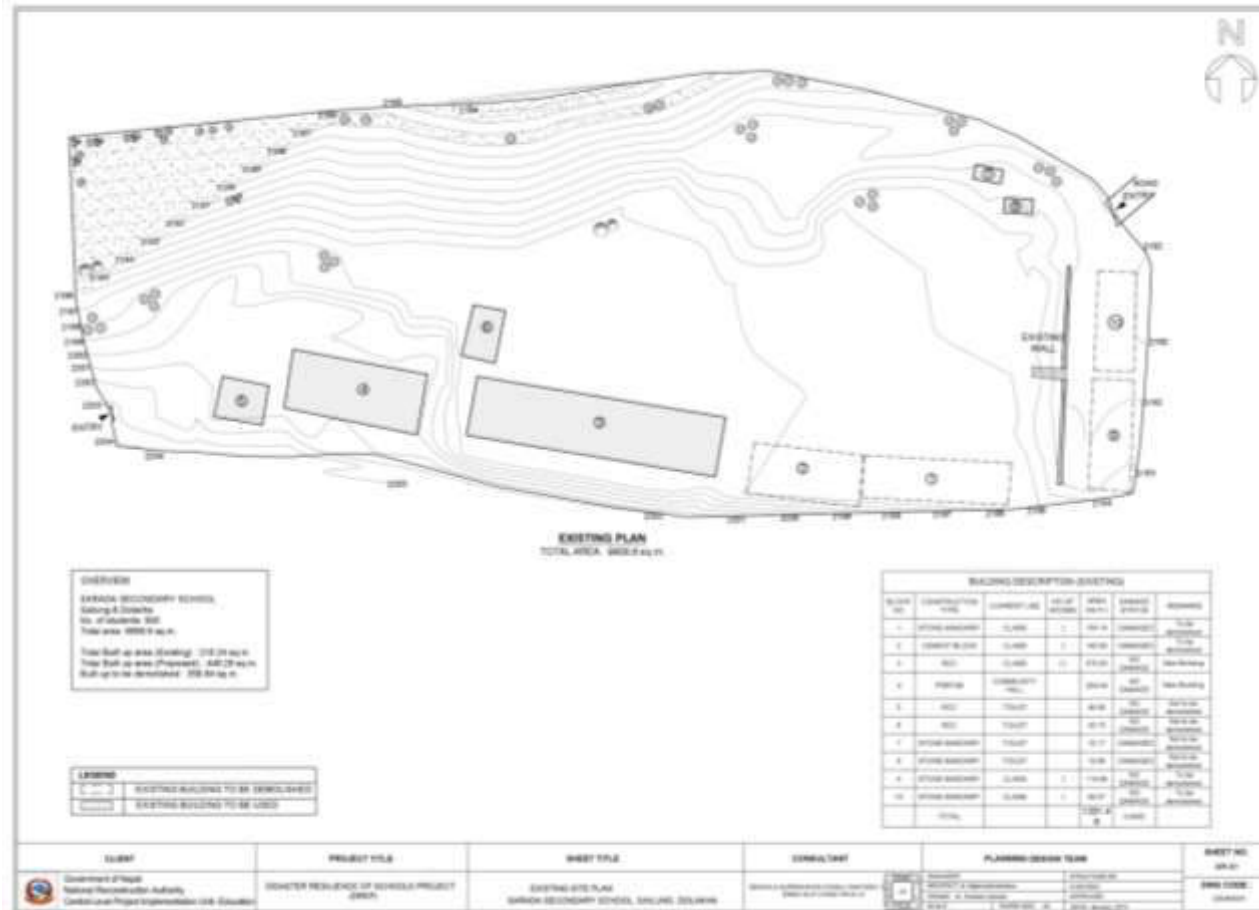

E: Proposed Master plan

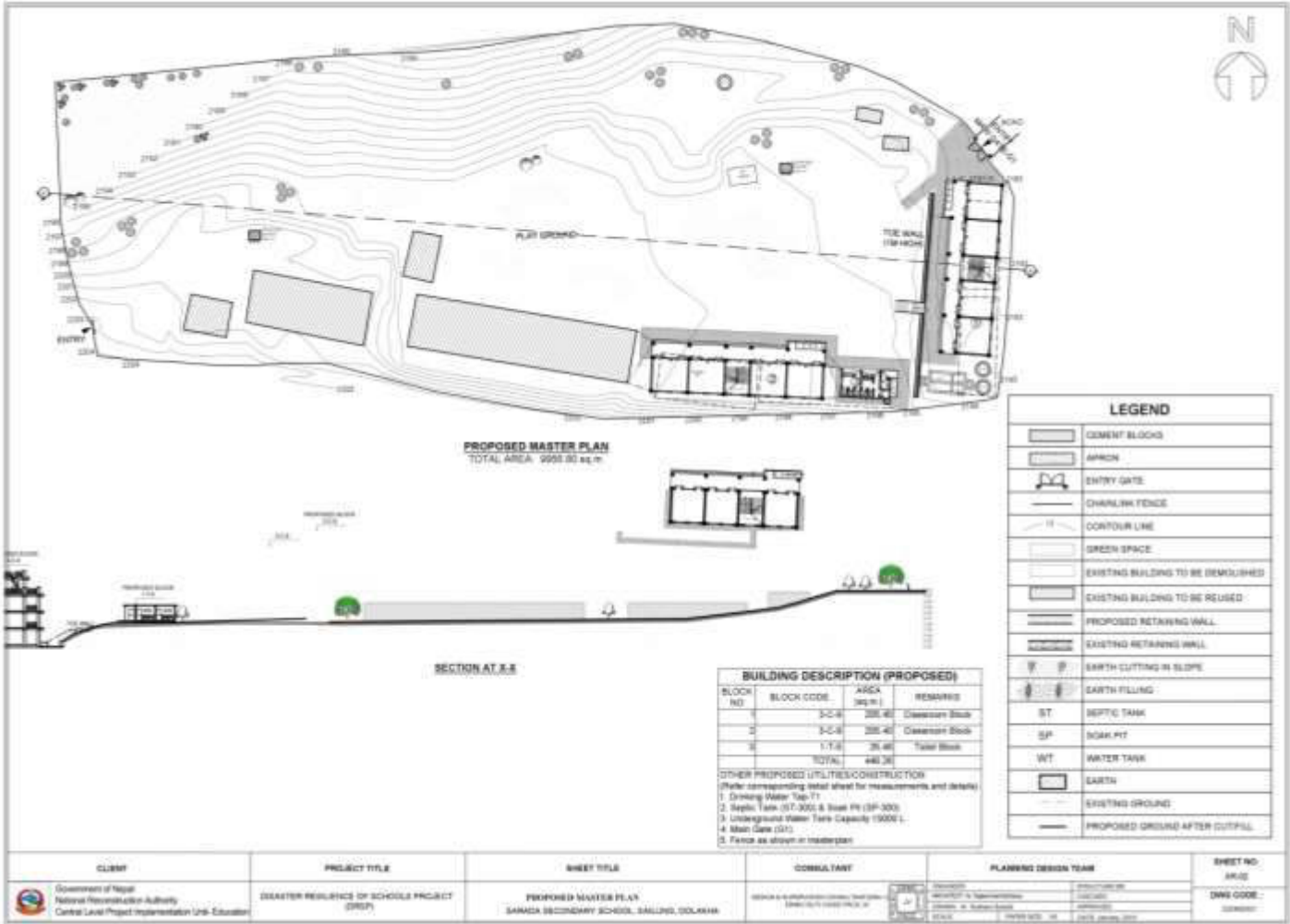

## Annex 10: Janajyoti SS

### A: Details of the Land Availability, Requirements and Proposed Structures

Details of Land	Area (sqm)	Details	No.	Remarks
Total area of land owned by school as per land ownership certificate.	NA	Classroom Block: 3-C- 9	2	2x205 sqm
Total area of Land within existing school boundary	2871.28			
Total area of land required as per master plan	2871.28	Toilet Block: 1-T-5	1	35.36 sqm
Total area required for reconstruction	446.26			
Land ownership status of existing land				
i) With Land ownership certificate	NA	Septic Tank (ST-250) & Soak Pit (SP-250)	1	
ii) User right with local government or owner agency approval	20349			
iii) Voluntary donation by private owner	NA			
Area of additional land required to implement master plan	NA	Underground Water Tank	1	15000 L
How additional land arranged	NA			

जिह्ला, दोलखा  
Dolakha  
१ नं. प्रदेश, नेपाल  
3 No Province, Nepal

Ref / Date: 206616124

विषय/Subject :- अक्षरालि तथा निष्कामिनि अभिलेखी कार्य

उपरोक्त स्थल पर जिला दौलत अलिचौक गाँव लिखित नं. ७ आस्थापना  
श्री अक्कोगति मा. वि. ले. यहाँ पर दो कक्षाओं के अने कक्षा में दो स्थापना  
अक्षांशों में आस्थापित पाठशाला किले के अक्षांश ७५०२ ७५१  
दुर्ग अक्षांशों अनुमानित क्षेत्र ३५-४० सेमी के अक्षांश क्षेत्र में विद्यालयों  
प्रधान अक्षांश अने अक्षांश प्रमाणित जहाँ अक्षांश अक्षेत्र अनुमानित प्रदान  
जैसे दो विद्यालयों पर ७५०२ ७५१ नं. जिला अक्षांश अक्षेत्र  
अक्षांश अक्षेत्र विद्यालयों में अक्षांश प्रदान करिले है।

206/6126  
मानसिं थानी

## C: Minutes of Meeting

<p>आज मिति २०८२।१२।२२ गतेको दिन यस अगमको माहगरी विधानसभाको सभासद गेला भने कालिम्चोक गाउँपालिका वडा नं. ०६ को माहिला सदस्य श्री दिलमाया धामी सीयोनकुल गेला बसे। सम्बन्धित व्यस्तता उपर फर्कनु गरि निवेदन पारित गरियो।</p>		
<p>लगाइल</p>		
क्र.सं.	इतिहासको नाम	
१)	दिलमाया धामी (वडा महिला सदस्य)	रि
२)	गणेश व. कुर्ते (प्र.सं.)	अवधि
३)	लाल व. बस्नेत (नि.सं. सदस्य)	
४)	श्यामली धामी ( " " )	१८५५३३८२२८ मेरावती
५)	लाला बस्नेत ( " " )	१८५१९५६३५८६ रि
६)	विष्णु भापा (स.प्र.भ.)	अवधि
७)	अमोक्तु रिवाकोटी (सि.सं.)	अवधि
८)	विशाल बस्नेत	अवधि
९)	सन्तोष बस्नेत	अवधि
१०)	ईश्वर बस्नेत	अवधि
११)	मानकाजी अधिकारी	अवधि
१२)	नवित बा. बस्नेत	ललीत
१३)	पार्वती अधिकारी	पार्वती
१४)	रविन्द्र बा. धामी	कान्छा बहादुर अधिकारी
१५)	पद्म बा. अधिकारी	इन्द्र
१६)	विमला बस्नेत	विमला
१७)	विमला शिवाकोटी	अवधि
१८)	मन्मथ काकी	अवधि
१९)	रहल बा. खत्री	अवधि
२०)	अमृतमाया अधिकारी	अवधि
२१)	कालिका बस्नेत	अवधि
२२)	साधका श्याम	साधका
२३)	गंगा शौभा श्याम	साधका
२४)	सिम्र कुमारी धामी	शुभाकु
२५)	कुल बा. श्याम	कुलबाहादुर
२६)	सिम्र बा. श्याम	सीमा कुमारी
२७)	सति बा. श्याम	अवधि







## Meeting minutes for trial shift

<p>आज मिति २०७३ चैत्र १३ गतेको दिन यस अन्त्येष्टि माःविः को विद्यालय नवगणपत समितिले २ अमरसिद्ध अमिमावतुको न सैवक मेला को अध्यक्ष श्री जीगा वः थापा को अध्यक्षतामा बसो, तयारिनेको प्रस्ताव उपर छलफल गरी निर्णय पारित गरियो ।</p>		
तयारिल		
१. जीगा वः थापा (अध्यक्ष)		राम
२. लाल वः थापा (सफर)		
३. शिला वः थापा ( " )		शिला
४. विष्णुमाना थामी ( " )	अ.ग.	
५. भगवती थामी ( " )		भगवती
६. सितहारा थामी ( " )		सित
७. विमल थामी ( " )		
८. सितहारा थामी ( " )		सित
९. गणेश वः थापा (सहस्य सचिव)		गणेश
अन्य उपस्थितहरू		
१०. विष्णु थापा (बिष्णु)		विष्णु
११. सुदीप वः थापा (अमिमावतु)		सुदीप
१२. कुल वः थापा ( " )		कुल
१३. नारायण वः थापा ( " )		नारायण
१४. बसन्त वः थापा ( " )		बसन्त
१५. सित वः थापा ( " )		सित
१६. हला थामी ( " )		हला
१७. देवी वः थापा ( " )		देवी
१८. राजु थामी ( " )		राजु
१९. चन्द्र वः थापा ( " )		चन्द्र
२०. राजु वः थापा ( " )		राजु
२१. तिलक वः थापा ( " )		तिलक थापा
२२. पूर्ण वः थापा ( " )		पूर्ण
२३. कुल वः थापा ( " )		कुल
२४. कृष्णमणि थामी ( " )		कृष्णमणि



### प्रस्ताव तथा निर्णयहरू

- १) वडा कार्यालयबाट विनियोजन भएको बजेट सम्बन्धमा
- २) ADB को सहयोगमा निर्माण हुने भवन सम्बन्धमा
- ३) नीजि-सुप्त शिक्षकको तलब जता सम्बन्धमा
- ४) तारआली माग गर्ने सम्बन्धमा
- ५) ETC को सहयोग संकौता गर्ने सम्बन्धमा
- ६) विद्यालय-सहायकको नियुक्ति सम्बन्धमा
- ७) विविध

#### निर्णय नं. १

प्रस्ताव नम्बर १ माथि हलफुल गर्दा आ.व. २०६३/६४ को वार्षिक बजेटबाट यस विद्यालयलाई खेल मैदान निर्माण गर्न अर्को विनियोजन भएको बजेट रु. ३००,०००/- तीन लाख (ह.नं. वडाको बजेट) बाट खेल मैदान निर्माणको काम सुरुवात गर्ने र अगस्तमा रु. ७५०/- (सात सय पचास) रुपैया तौलने निर्णय गरियो।

#### निर्णय नं. २

प्रस्ताव नम्बर २ माथि हलफुल गर्दा, ADB को सहयोगमा निर्माण हुन लागिरहेको नयाँ भवनको मास्टर प्लान तथा मेशिनको हतर रौ मास्टर प्लान निर्माण हुदा नयाँ बन्ने भवनको कारण रौ भवन पछाडीको सडक (कर्चि) ठुली मिटर सानुपर्ने देखिएकोले भवनको वेष्टमा उपस्थित वि.व्य.सं. पदाधिकाारी, नयाँ भवन बन्ने उम्माको सहयोग र बुद्धिजीवि बस्ती रौ कर्चि रोड सानु पर्ने भएमा सभै र रौ कार्यको लागि पुगे सार्वजनिक भूमा नभए नीजि भूमा समेत आवश्यक पैसा दिने अनि निर्णय गरियो। साथै नयाँ भवन निर्माण को काम सधसकय चाडो अगाडी बढाउन सम्बन्धित कार्यलयलाई अनुरोध गर्ने निर्णय गरियो।

#### निर्णय नं. ३

प्रस्ताव नम्बर ३ उपर हलफुल गर्दा यस विद्यालयमा नीजि सुप्त पढमा कार्यरत शिक्षकहरू रविन थामी, उमेश्वर शिवाकोटी र पितोफ थापले तलब दिएको माग राखी गर्नुभएको निवेदन उपर उहाँ वि.व्य.सं.को वेष्ट बस्ती निर्णय गर्ने गरी रौ प्रस्ताव निर्धारण पेश गरियो।

महिला सारको इति उपलब्ध वर्षको कक्षा हाल विद्यालय  
 रहेको छ भने भवनको पछाडीको भाग पुरै मरु सँगै रहेको भवन  
 ओखिपछो अवस्थामा रहेकोले सो को संरक्षण गर्न तारजाली लगाउन  
 पाल हातुपुर्ने भएकोले मिल्सा गृह तथा अलाहाद कार्यालय चर्किएर  
 दोलखा साथै सिन्धुवा डिभिजन कार्यालय चर्किएर दोलखालाई  
 र दानको २० घात र ५.२ घातको २० घात भाली भाग गर्ने  
 निर्णय गरियो ।

#### निर्णय नं. २

प्रस्ताव नं. २ माथि कलफल गरी श्री फर्सेलुङ्ग सामाजिक सेवा  
 नेपालले यस वर्षको कार्यकुशल यस विद्यालयलाई उपलब्ध गराउने  
 निम्न सहयोग रिवर्कन र कार्यालयको लागि उपलब्ध सहयोग  
 उपलब्ध गराउने निर्णय गरियो । यीसँगै पश्चात उपलब्ध हुने तपस्वि  
 बमोजिमको सहयोग गृहण गर्ने निर्णय गरियो :

१. Sanitation	1 set	RS. 2,500/-
2. Game item	1 set	" 1,200/-
3. Wall paint		" 12,000/-
4. computer	5 set	" 70,000/-
		85,700/-

सो सहयोगको लागि Educate the children तथा फर्सेलुङ्ग सामाजिक  
 सेवा नेपाललाई हार्दिक आभार व्यक्त गर्ने निर्णय गरियो ।

#### निर्णय नं. ६

प्रस्ताव नं. ६ पुर कलफल गरी यस विद्यालयमा रिक्त हुन  
 आएको विद्यालय सहायक पदको पदपुर्ति गर्न देहाय बमोजिमको  
 कार्यविधिमा आधारमा पदपुर्ति गर्ने निर्णय गरियो :

मिति २०७३/०८/०२ गते मिति २०७३/०८/०२ गते विद्यालय सहायकको रुपमा कार्यरत  
 अर्जुन थापाले मिति २०७३/०८/०२ गते नि.मा.मि. उम्मेदवारबाट  
 शिक्षक पदमा शिक्षक छुटोए परीक्षाबाट सिफारिस भई रिक्त हुन  
 आएको विद्यालय सहायक पदमा नियुक्ति गर्न देहाय बमोजिमको  
 कार्यविधिमा आधारमा गर्ने निर्णय गरियो :-

१. कार्यविधिको नामः विद्यालय सहायक पदको नियुक्ति गर्ने तथा  
 पारिखेको कार्यविधि २०७३

२. कार्यविधिले तयार गर्नुपर्ने औचित्यः प्रयत्नित शिक्षा रैन तथा नियमा-



३. हुनोट परीक्षा समिति : १. वि. व. सं. अध्यक्ष (संयोजक)

२. विद्यार्थी (नेता)

३. विद्यार्थी (कमजोर)

४. प्रधानाध्यापक (सहस्रचरित्र)

४. परीक्षा अवधि : १५ दिन

५. शैक्षणिक : तैयार भुविषय निर्देशावली अनुसार १०+२ व।  
सो स्तर उत्तीर्ण

६. परीक्षा विधि : लिखित (विषयगत ३ वस्तुगत दुई)

६. परीक्षाको अवधि प्रश्नको मुल विषय : पाठ्यशास्त्र सैद्धान्तिक २०%  
२ कम्प्युटर २०% ।

७. तालिम : दत्त १९२० (सहायक जनसंख्या आदि) २ नेपाल सरकार  
को निर्णय बमोजिम परिवर्तन गरिने सोही बमोजिम  
हुने ।

८. परीक्षा शुल्क : २०६०/१०/१२

१०. परीक्षा स्थापना : विद्यालयको कार्यनाममा ।

नियम नं. ६ विधि तालिम उपलब्धित निर्णयहरू जहाँ आफ्नो नेतृत्व  
गरियो ।

## D: Existing Site Plan

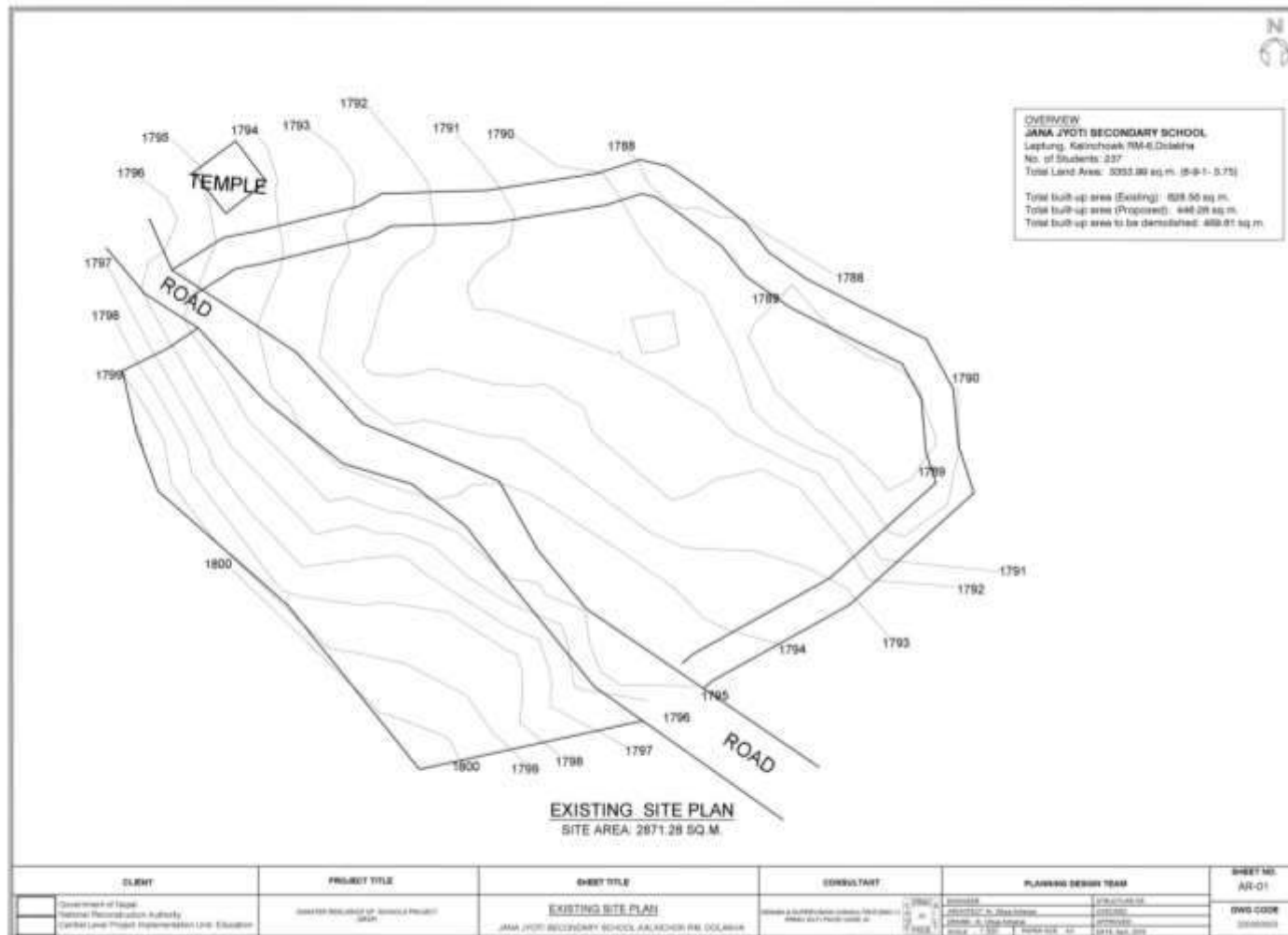

E: Proposed Master Plan

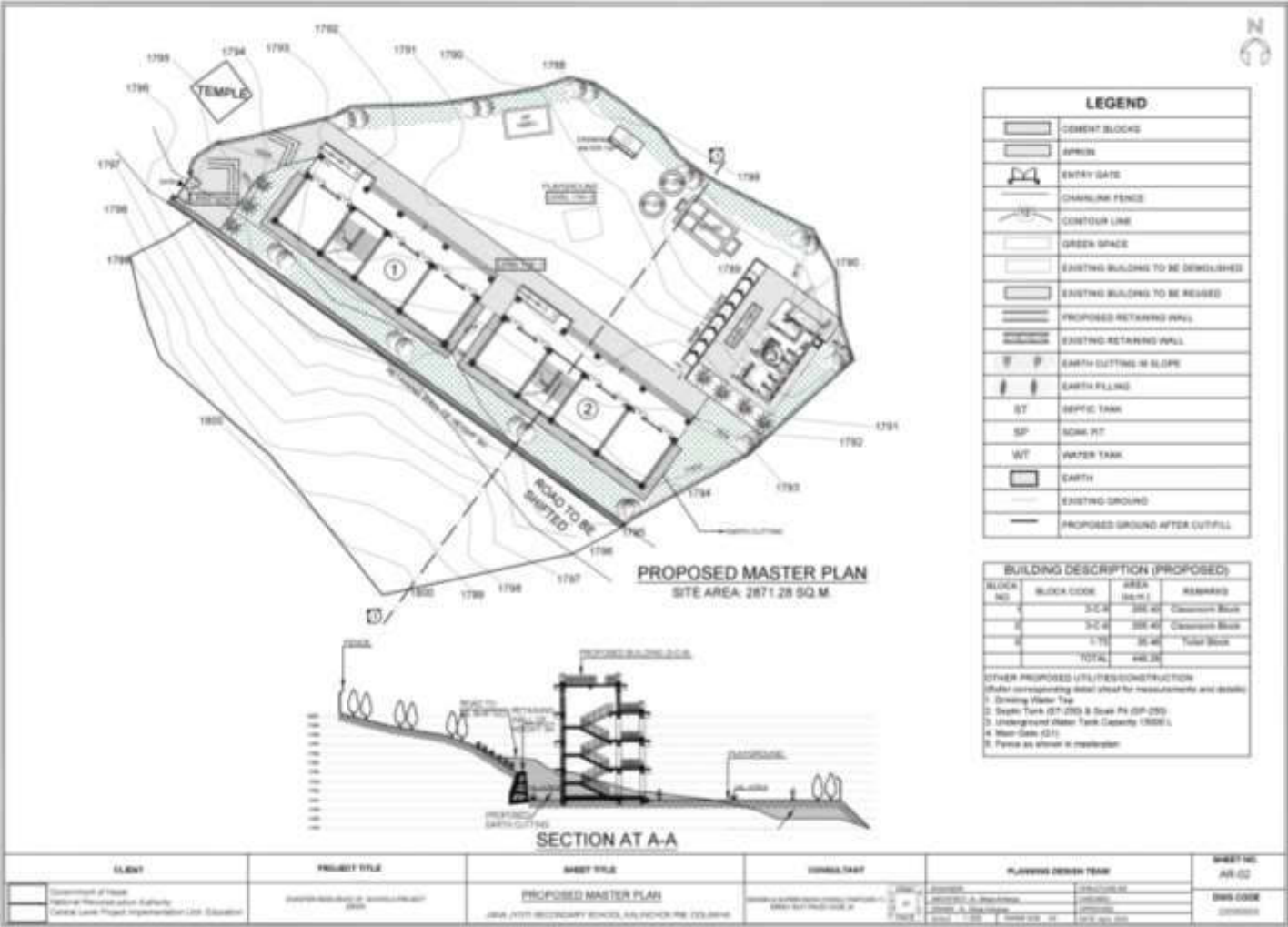

### Annex 11: Chitre SS

#### A: Details of the Land Availability, Requirements and Proposed Structures

Details of Land	Area (sqm)	Details	No.	Remarks
Total area of land owned by school as per land ownership certificate.	6696	Classroom Block: 3-C- 7	1	152.9 sqm
Total area of Land within existing school boundary	1933.5			
Total area of land required as per master plan	1933.5			
Total area required for reconstruction	176.56	Toilet Block: 1-T-7	1	23 sqm
Land ownership status of existing land				
i) With Land ownership certificate	6696			
ii) User right with local government or owner agency approval	NA	Septic Tank (ST-150) & Soak Pit (SP-150)	1	
iii) Voluntary donation by private owner	NA			
Area of additional land required to implement master plan	NA	Underground Water Tank	1	15000 L
How additional land arranged	NA			

#### B: Land Ownership Certificate





जगगाधनी दत्ता प्रमाण राज्ञा

29th Dec 22

Robert





[illegible]

जलगावची दुर्त प्रसिद्धी वोलबा

1. The first part of the paper is devoted to the study of the properties of the function  $f(x)$  defined by the equation

*Primer*:  $\text{CTGTTTGGTTCAGCCTT}$

1999

THE UNIVERSITY OF CHICAGO

五

[illegible]

अनुप (अनुप) १,११२.००

01-11-2007 12:30

区域

6/10/1980





## C: Minutes of Meeting

आम निर्माण कार्य के लिए 10.00 करोड़ रुपये का बजट निर्धारित है।  
 1. आवास : 1000 इकाई का निर्माण।  
 2. सड़क : 1000 मीटर का निर्माण।  
 3. पानी : 1000 मीटर का निर्माण।  
 4. बिजली : 1000 मीटर का निर्माण।  
 5. गैस : 1000 मीटर का निर्माण।  
 6. अन्य : 1000 मीटर का निर्माण।  
 7. कुल : 1000 मीटर का निर्माण।  
 8. अन्य : 1000 मीटर का निर्माण।  
 9. कुल : 1000 मीटर का निर्माण।  
 10. अन्य : 1000 मीटर का निर्माण।

## D: Existing Site Plan

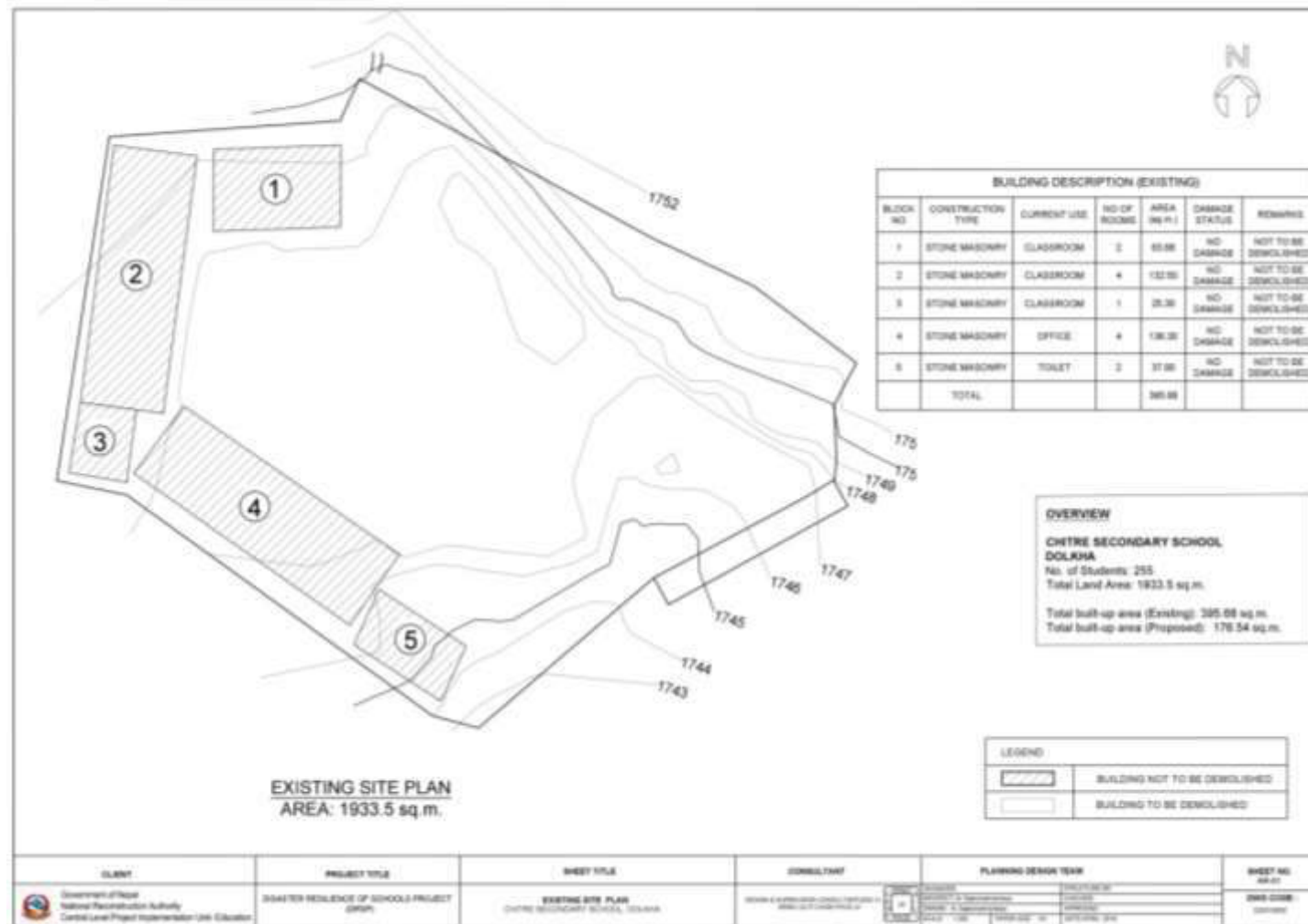

## E: Proposed Master Plan

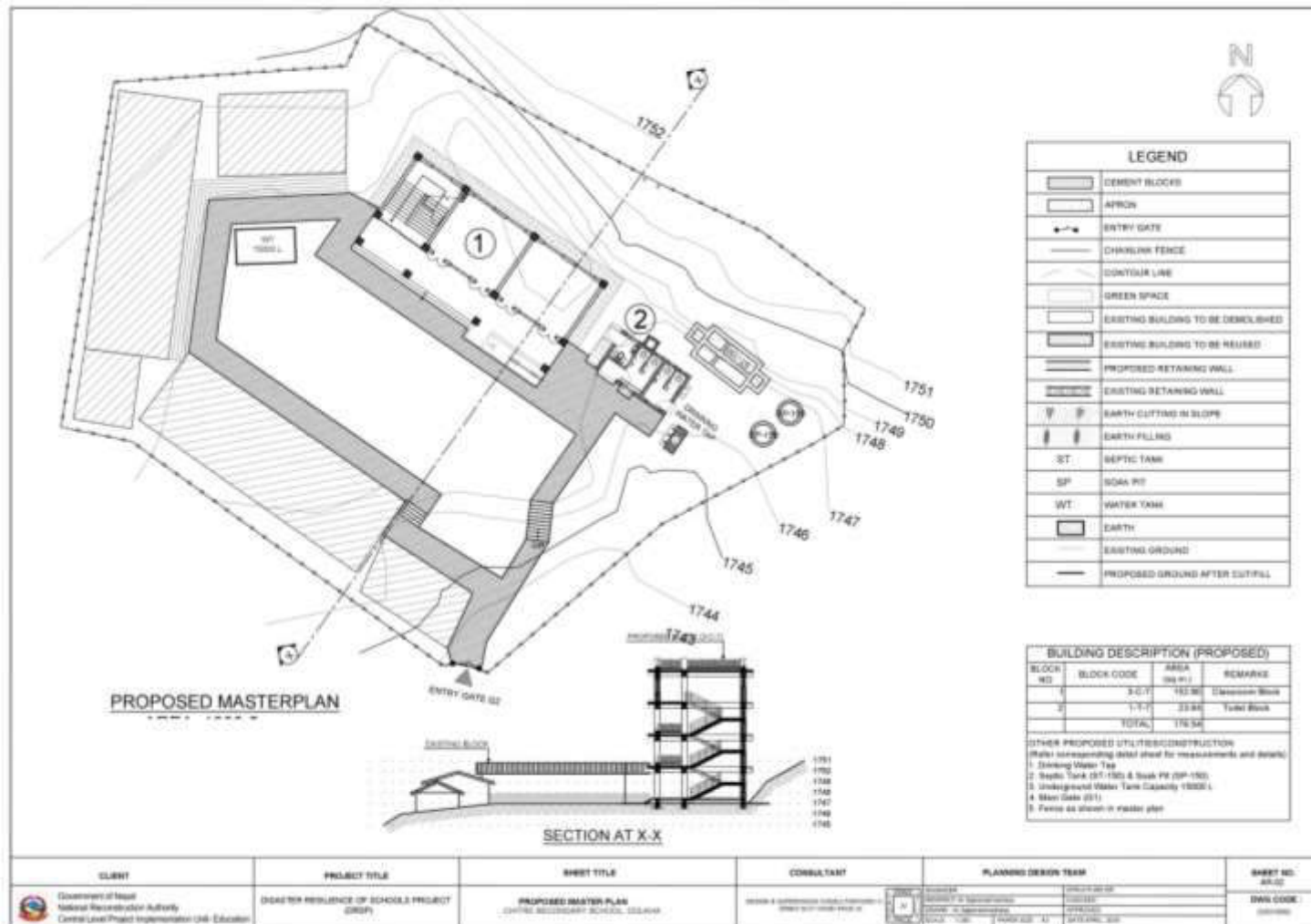

**Annex 12: Janajyoti SS, Putalikat**

**A: Details of the Land Availability, Requirements and Proposed Structures**

Details of Land	Area (sqm)	Details	No.	Remarks
Total area of land owned by school as per land ownership certificate.	6395	Classroom Block: 3-C- 7	1	152.9 sqm
Total area of Land within existing school boundary	441.18			
Total area of land required as per master plan	441.18			
Total area required for reconstruction	176.54	Toilet Block: 1-T-7	1	23 sqm
Land ownership status of existing land				
i) With Land ownership certificate	6395	Septic Tank (ST-150) & Soak Pit (SP-150)	1	
ii) User right with local government or owner agency approval	NA			
iii) Voluntary donation by private owner	NA			
Area of additional land required to implement master plan	NA	Underground Water Tank	1	15000 L
How additional land arranged	NA			

### C: Land Ownership Certificate

[illegible]



## C: Minutes of Meeting

काज मिति २०७२ साल कार्तिक १५ गतेका दिन राखी जगदीश्वरी  
माथि कै विष्णु महा स्थापनापछि समितिबाटै काँडेड समितिका अध्यक्ष श्री  
बालुवारा कान्छी बस्नेतले आस्थावानता तथा धार्मिकता छव्नेछिन् सबैलाई  
उपस्थितिमा ज्ञप्ति गिनिन निर्देशहरू पारित गरियो ।

उपस्थित रहें।

१. श्री बाबुलाल लामा - वि.व.स अकादमी - १३६४००१२  
 २. श्री चन्द्रकुमार गिरी - अकलेश चन्द्रगौरी  
 ३. श्री सुनिता लोकादानी - अकलेश सुनिता  
 ४. श्री विद्या लामा - अकलेश  
 ५. श्री ललित लाला - अकलेश  
 ६. श्री धीरेंद्र मोहन - अकलेश  
 ७. श्री बहालकुमार लामा - अकलेश  
 ८. श्री विद्यालाल गिरी - अकलेश प्रतिनिधि  
 ९. श्री उदय प्रसाद लामा - अकलेश सचिव - १३६४००१२

अभिभावक

1. अवधूत नामाङ्क ३० ३०  
2. अवधूत नामाङ्क ३० ३०  
3. अवधूत नामाङ्क ३० ३०

अमान्यता

9. श्री सुविष्णु आकाश  
 10. श्री सुविष्णु विजयलक्ष्मी  
 11. श्री सुविष्णु जीतलक्ष्मी  
 12. श्री सुविष्णु लाललक्ष्मी

प्रस्तावना

9. CLPIU/NRA/ADB की समीक्षा ERM CTU के Design अनुसार करें विद्यमान प्रणाली की समीक्षा करें और उपयुक्त आवश्यक विद्यमान व्यवस्थापन समिति को सूचित करें।



## D: Existing Site Plan

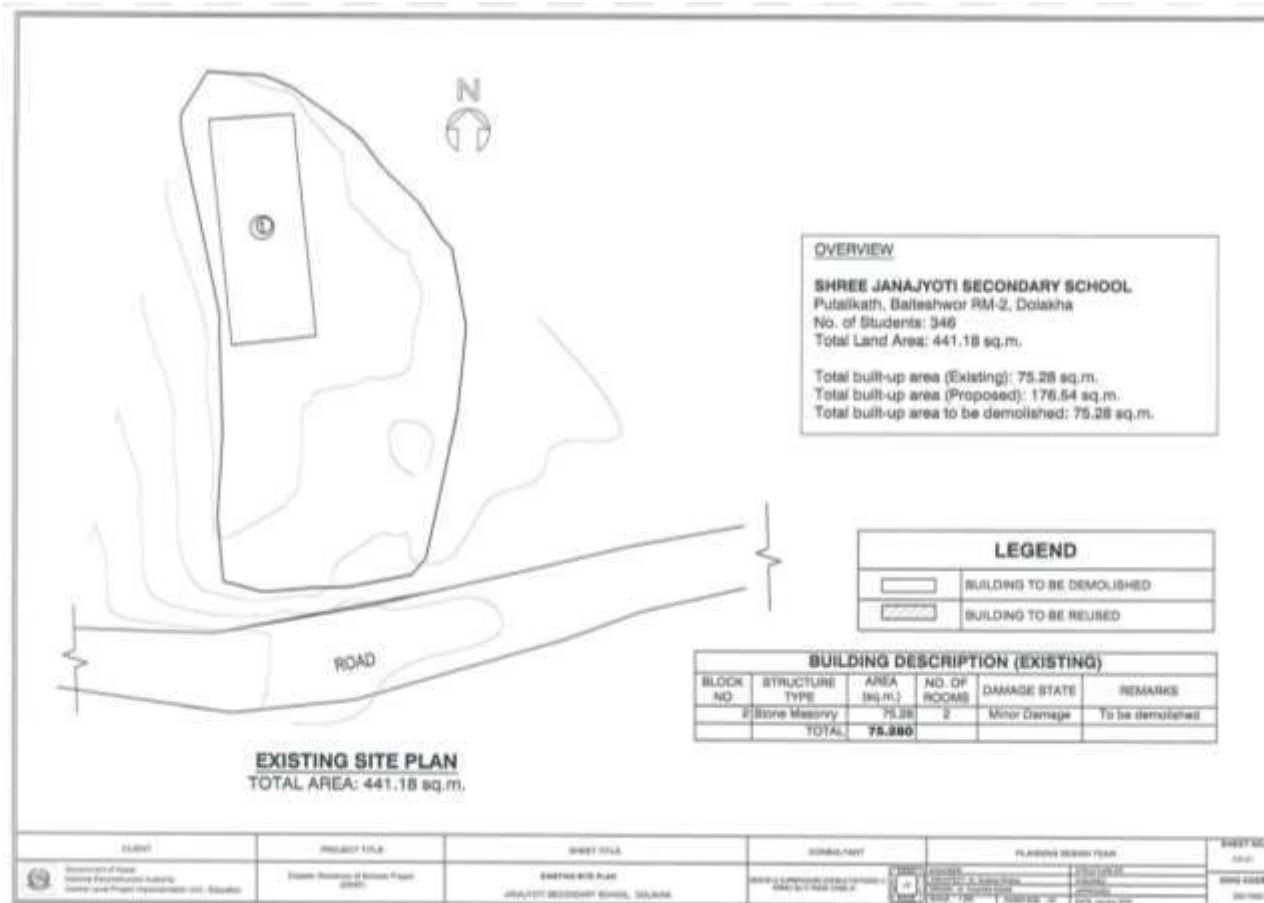

## E: Proposed Master Plan

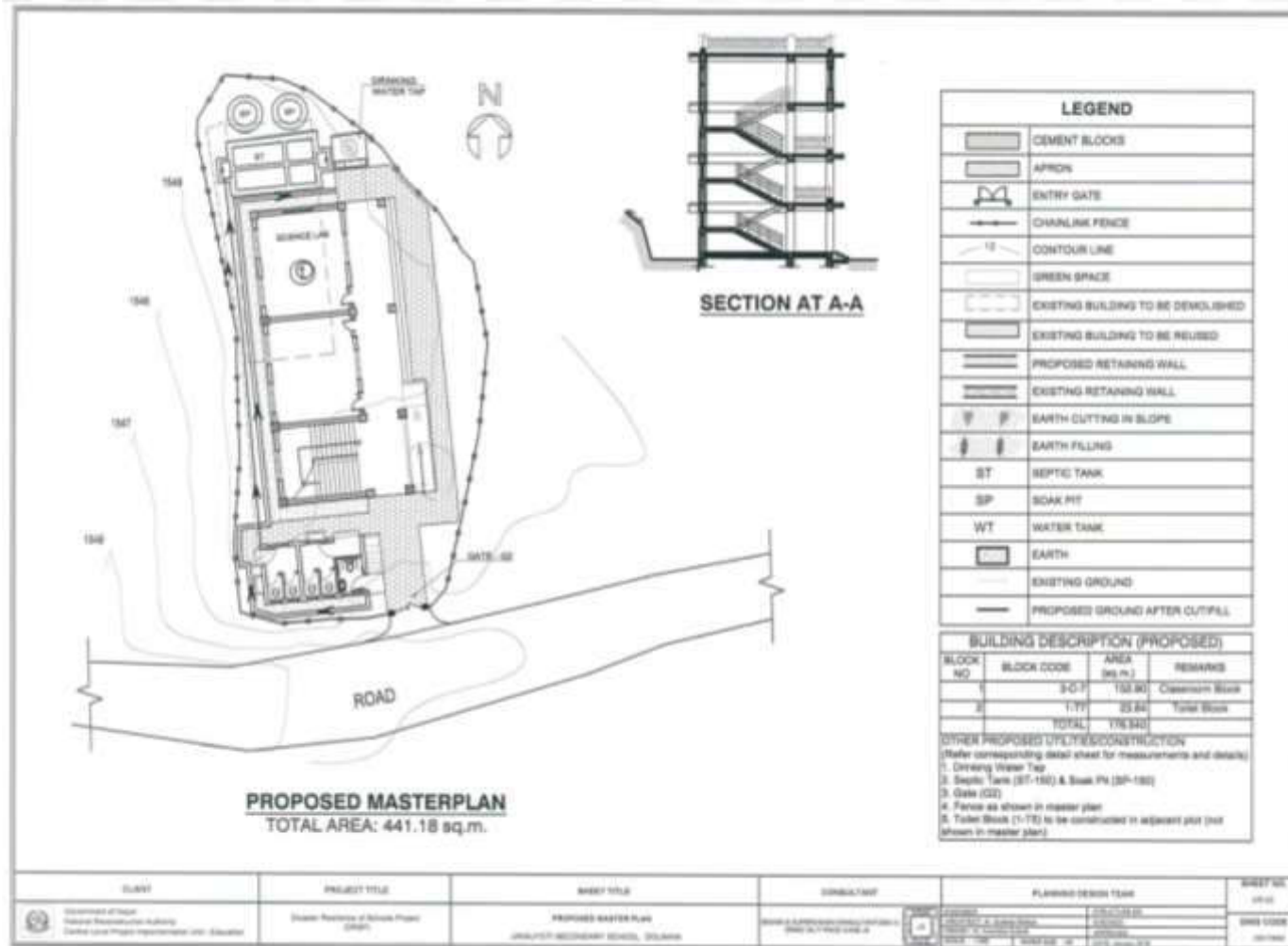

### Annex 13: Kalika SS

#### A: Details of the Land Availability, Requirements and Proposed Structures

Details	Area (sqm)	Details	No.	Remarks
Total area of land owned by school as per land ownership certificate.	5665	Classroom Block: 3-C- 9	1	205 sqm
Total area of Land within existing school boundary	3940.58			
Total area of land required as per master plan	3940.58	Toilet Block: 1-T-5	1	35.36 sqm
Total area required for reconstruction	240.86			
Land ownership status of existing land				
i) With Land ownership certificate	5665	Septic Tank (ST-300) & Soak Pit (SP-300)	1	
ii) User right with local government or owner agency approval	NA			
iii) Voluntary donation by private owner	NA			
Area of additional land required to implement master plan	NA	Underground Water Tank	1	15000 L
How additional land arranged	NA			

[illegible]











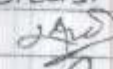
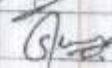
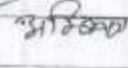

## C: Minutes of Meeting

आम्र मिति २०७४ असार मास मंसिर १२ गते का दिन लक्ष्मी  
कालिका प्राविधिक कालिका प्राविधिक अध्यक्ष श्री गोपाल सिंह सुवालको  
अध्यक्षतामा गरेको बैठकको विषय प्रस्तावहरूमा इलाफन गरी  
सर्वसम्मत निर्णय गरियो

### उपस्थिति

१. श्री गोपाल सिंह सुवाल - अध्यक्ष 
२. श्री सुर्य बहादुर सुवाल - सदस्य 
३. श्री सुर्य बहादुर सुवाल - सदस्य 
४. श्री अश्विनी सुवाल - सदस्य 
५. श्री कमलमाया सुवाल - सदस्य 
६. श्री पूर्णमाया सुवाल - सदस्य 
७. श्री रतनकुमार सुवाल - शिक्षक प्रतिनिधि 
८. श्री लख बहादुर सुवाल - पदेन सदस्य 
९. श्री भरत मुखिया - सदस्य सचिव 

### अतिथिहरू

१०. श्री रजिता सुवाल - रजिता
११. श्री चेतनराज सुवाल - चेतन
१२. श्री कुल बहादुर सुवाल - कुल

### आम्र मिति

१३. ADB कन्सल्टेन्ट - श्री सुदिप रायब
१४. श्री डोडी बास्नेता

### प्रस्तावहरू

१. CLPIV/NRA/ADB को सहयोगमा ERMCTV को  
Design अनुसार को विद्यार्थी भवनको लागि आवश्यक  
को भग्ना उपलब्ध गराउन विद्यार्थी व्यवस्थापन समिति  
को सहकार्यमा।
२. CLPIV/NRA/ADB को सहयोगमा ERMCTV को  
Design अनुसार मिति २०७४/०६/१५ मा यस विद्यार्थीको  
को भग्ना उपलब्ध गराउन विद्यार्थी व्यवस्थापन समिति



Date: / /

Page: /

निर्णय सं १

निर्णय सं १

प्रस्ताव सं १ माहि वहाफ्त गर्दा CLPPI/NRA/ADB को सहयोगमा ERMCTV को Design अनुसार बने विद्यालयको भवनको लागि आवश्यक पर्ने जग्गा विद्यलय-  
यंग प्रशासक भएको र भवनको लागि जग्गा उपलब्ध  
गर्दा विद्यालय निर्माण गर्न सक्ने प्रतिकूल हों भन्ने सर्व-  
सम्पत्ति निर्णय गरियो ।

निर्णय सं २

प्रस्ताव सं २ माहि वहाफ्त गर्दा ADB को आधुनिक  
प्राविधिककत आज मिति २०७५/०६/१५ गतेका दिन यस  
विद्यालयको भवन तथा प्राङ्गो परिक्षण गर्ने कार्य सम्पन्न  
भईसकेकोले समिति तथा अभिभावकको तर्फबाट गर्ने कार्य  
सहयोग गर्ने भन्ने आवश्यकताका साथ सम्बन्धित विद्यालय  
पेश गर्ने भन्ने सर्वसम्पत्ति निर्णय गरियो ।

आवश्यक पैसा जुनै ठोक् बस्ने गरि आफ्नो  
बेड अन्त गरियो ।

## D: Existing Site Plan

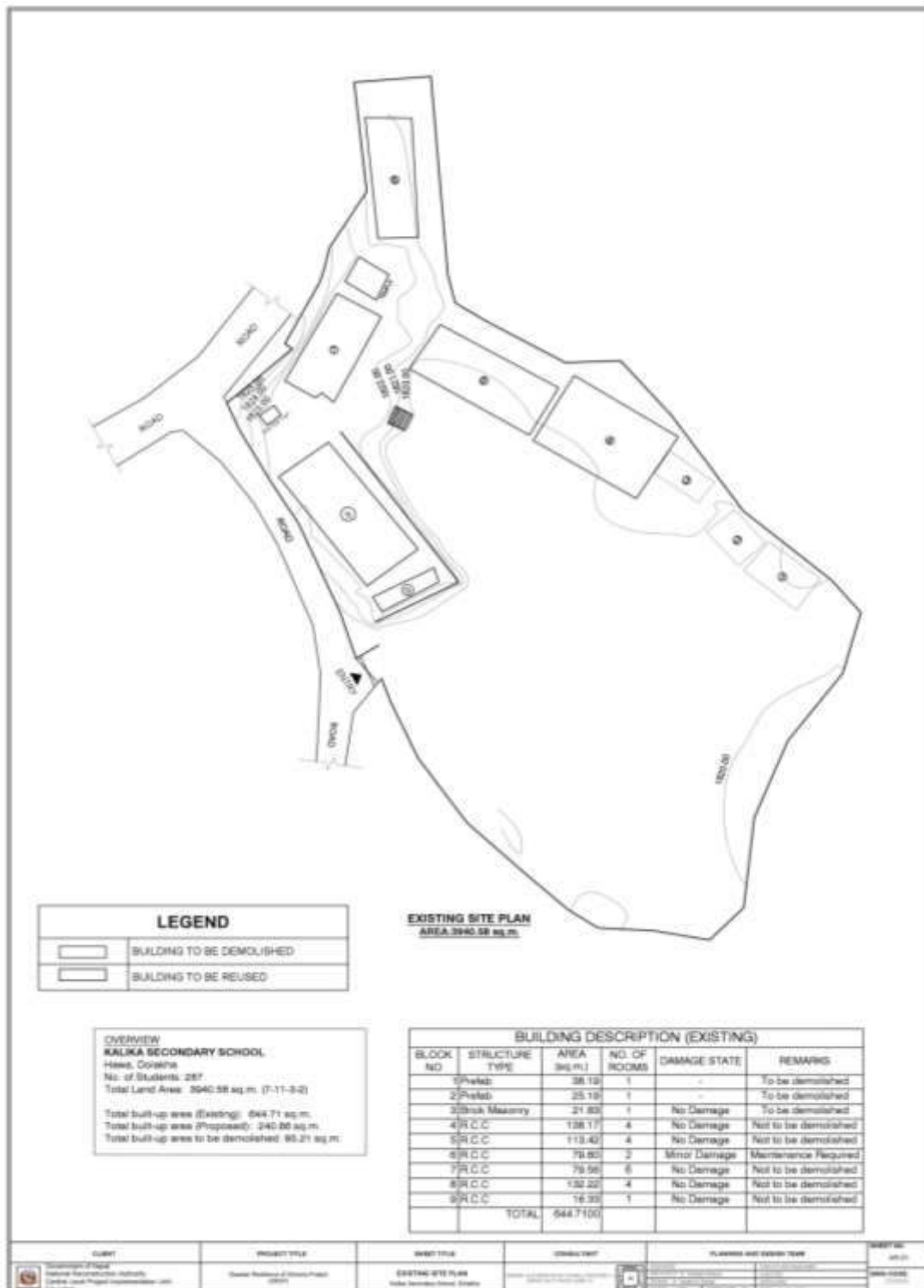

## E: Proposed Master Plan

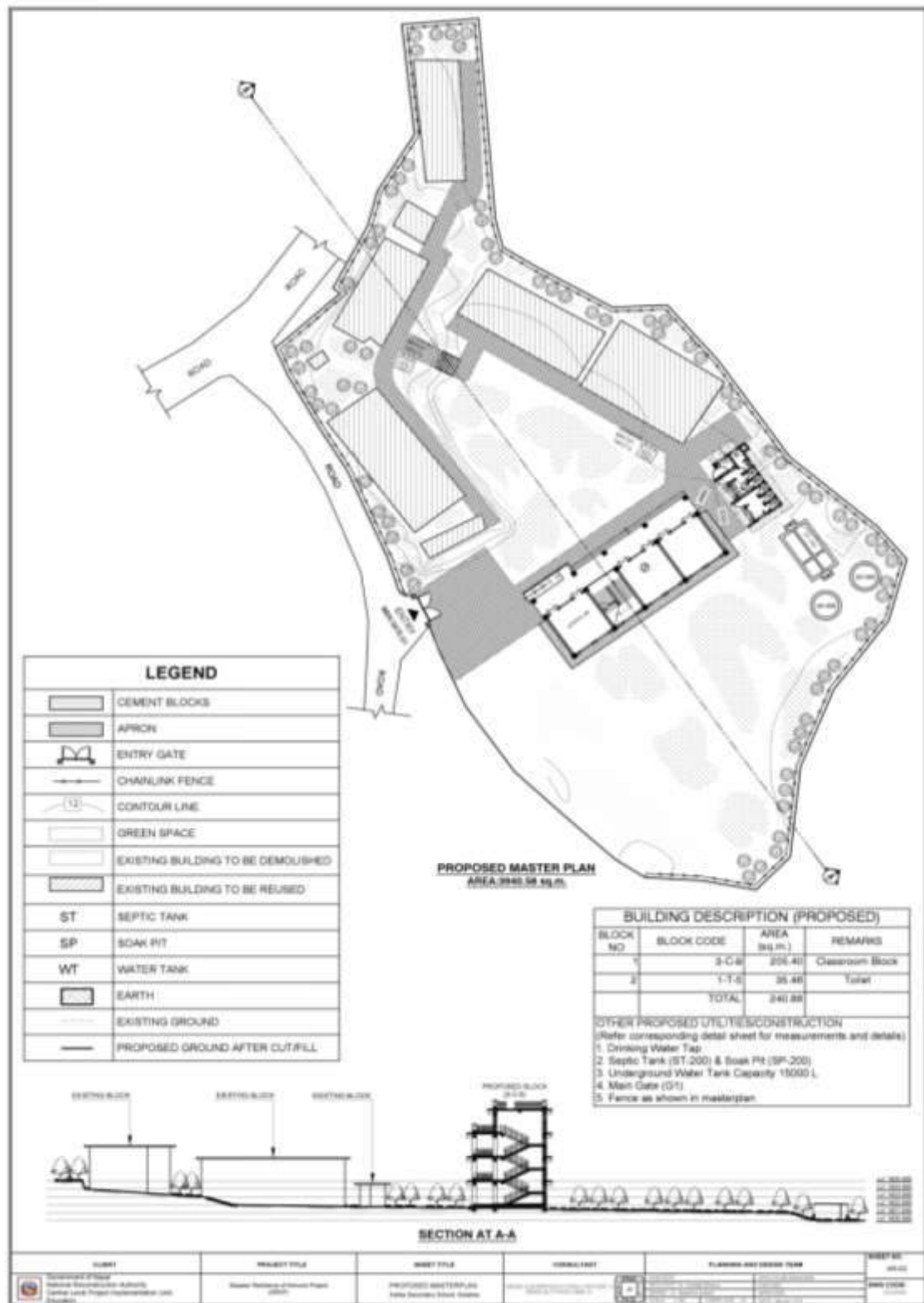



### Annex 14: Satyeshwor SS

#### A: Details of the Land Availability, Requirements and Proposed Structures

Details of Land	Area (sqm)	Details	No.	Remarks
Total area of land owned by school as per land ownership certificate.	10010	Classroom Block: 3-C- 9	2	2x205 sqm
Total area of Land within existing school boundary	2016.55			
Total area of land required as per master plan	2016.55			
Total area required for reconstruction	465.2	Toilet Block: 1-T-5	1	54.20 sqm
Land ownership status of existing land				
i) With Land ownership certificate	10010			
ii) User right with local government or owner agency approval	NA	Septic Tank (ST-300) & Soak Pit (SP-300)	1	
iii) Voluntary donation by private owner	NA			
Area of additional land required to implement master plan	NA	Underground Water Tank	1	15000 L
How additional land arranged	NA			

## B: Land Ownership Certificate

86449

नेपाल सरकार  
भूमिस्वधार तथा व्यवस्था मन्त्रालय  
भूमिस्वधार तथा व्यवस्थापन विभाग  
मालपोत कार्यालय, दोलखा

अग्राधनी संकेत नम्बर



ग्रीडाको छाप	
दायाँ	बायाँ
2	1

कोटो प्रमाणित गर्नेको दस्तखत

अग्राधनीको नाम बर सत्य २०८७ उच्च माध्यमिक विद्यालय उमेर

ठेगाना जम्कु अंचल दोलखा जिला इलाका

नगरपालिका/गाउँ विकास समिति वडा नं ४

अग्राधनीको बाहु/पतिको नाम, बर प्यरे

छात्र/ससुराको नाम, बर

भावरिकता नम्बर र भिति

भावरिकता प्रदान गर्ने कायान्वय

अग्राधनीको दस्तखत

अग्राधनी प्रमाण-पत्र दिने कायान्वय मालपोत कार्यालय, दोलखा

(कार्यालयको छाप)





## C: Minutes of Meeting

२

 आज मिति २०६२ साल साखिग १८ गतेका दिन  
 स्वयंसेवक मा. वि. प्रवर्ग १ गेल्लुङ्का वि. व्य. स. सदस्यका श्री  
 प्रेम व. थापाको अध्यक्षतामा बैठक वसी तपस्वित बमोजिमको  
 निर्णय गरियो।

**उपस्थिति:**

१. प्रेम व. थापा अध्यक्ष
२. शान्त व. कार्की सदस्य
३. गंगा व. कोइराला "
४. सतिता पाण्डे " सीता
५. विद्या बस्नेत "
६. कल्पना कोइराला "
७. इश्वर कोइराला " प्रेम बस्नेत
८. सुतमाया त्रिभेन " प्रमोद प्रतिनिधि
९. सुकुन्द प्र. डमेली " सदस्य शक्ति

**आमन्त्रित:**

१. हरि व. खड्का अध्यक्ष वि. भ. स.
२. सुदिप थापा
३. दुर्गा हरिचन्द्र
४. दण्डी बास्कोला

**प्रस्तावहरू:**

प्रस्ताव नं. १ CLPIU / NRA / ADB को सहयोगमा ERMCTV  
 को Designing अनुहार गर्ने विद्यालय भवनको लागि  
 आवश्यक पर्ने जग्गा उपलब्ध गराउने सम्बन्धमा।

प्रस्ताव नं. २ CLPIU / NRA / ADB को सहयोगमा ERMCTV  
 Designing अनुहार मिति २०६१/०६/१६ मा गर्ने तथा  
 माथि प्रक्रिया गराउने सम्बन्धमा।

प्रस्ताव नं. ३ विविध:

**निर्णयपत्र:**

प्रस्ताव नं. १ माथि आवश्यक हुलाकत गर्दा  
 CLPIU / NRA / ADB को सहयोगमा ERMCTV को  
 Designing अनुहार गर्ने विद्यालयको भवनको लागि  
 जग्गा उपलब्ध गराउने सम्बन्धमा।



रहेको व्यहोरा सर्वसहमतबाट निर्णय गरियो ।

प्रस्ताव नं. २ माथि आवश्यक इलजल गर्दा  
 ३।५।५।६।७।८।९ बाट छाड्नु भएका प्राविधिकहरू बाट  
 आज मिति २०६५।०६।१७ गतेका दिन भए विद्यालयको  
 सबै तहमा गएको परिक्षा गर्ने काम सम्पन्न भइसकेको  
 ले समिति तथा विद्यालयको २ समितिको तर्फबाट  
 सहयोग गर्ने गराउने सहमति भएकोले आवश्यक  
 कागजात सम्बन्धित तिकाजमा पेश गर्ने निर्णय गरियो

प्रस्ताव नं. ६ माथि आवश्यक इलजल गर्दा  
 यस अध्यक्षवर मा. वि. पवली १ त्रेलुङ (दाविड पवली  
 ४) को कितानि २०६५ को १०००० त्रेलुङ रहेको व्यहोरा  
 निर्णय गर्दा यस विद्यालयमा २० जना शिक्षक  
 र २०० जना विद्यार्थी रहेको साथै +२ मा शिक्षक  
 व्यवस्थापन सेवामा सम्बाल भएको तथा टिकट भन्ने  
 मा प्राविधिक धार सम्बाल हुने व्यहोरा समेत निर्णय  
 गरियो ।

*(Handwritten signatures and stamps)*

## D: Existing Site Plan

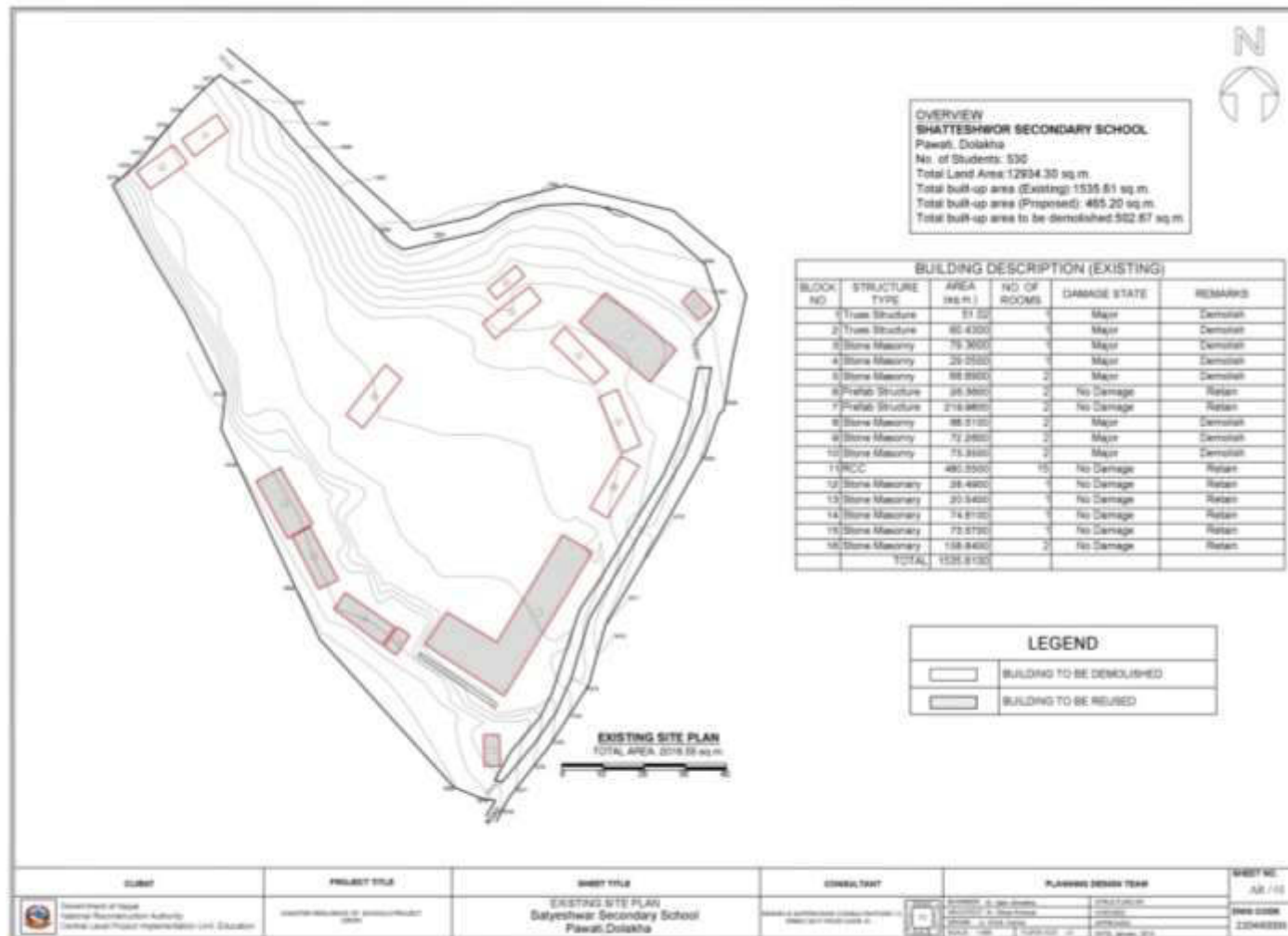



## E: Proposed Master Plan

